



Upper Berkeley Street, W1H

£3,900 Per calendar month

A modern one bedroom apartment on the first floor of an attractive Georgian conversion. The flat has high ceilings throughout, a kitchen/reception room with wood flooring, double bedroom with built-in storage and a bathroom.

Forming part of an attractive Georgian building located on a popular residential street close to Bryanston Square, in Portman Village. Hyde Park and all the shopping facilities of Oxford Street are almost on the doorstep.

Features

- First Floor Apartment
- New Refurb
- High Ceilings
- Kitchen/Reception
- Unfurnished
- The Portman Estate

Upper Berkeley Street, London, W1H

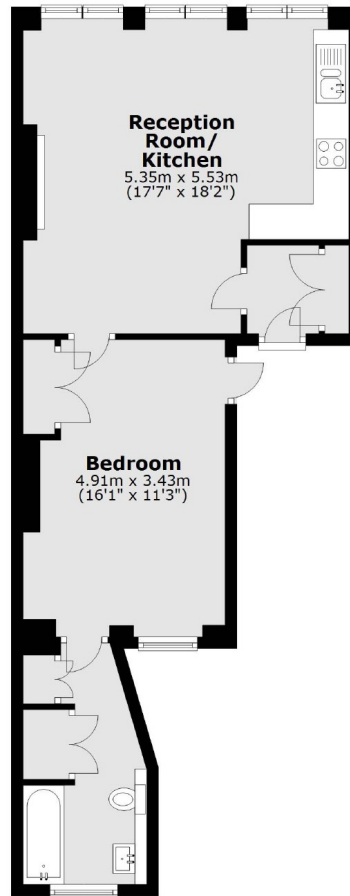

Total area: approx. 55.3 sq. metres (595.6 sq. feet)