



## Gledstanes Road, W14

£600,000

The property is located on the first floor of a well-maintained period building and is sold with a share of the freehold. You have a spacious and bright living room with three large windows offering lovely views of the tennis courts. The semi-open kitchen is ideal for entertaining friends and family and there are two double bedrooms.

Gledstanes Road is located in the heart of Barons Court and within easy reach of the District and Piccadilly lines. You have a great choice of local shops and cafés, a popular pub a few roads away and a Little Waitrose on your door step.

### Features

- Share Of Freehold
- Popular Property
- Close To Barons Court
- Two Bedrooms
- Great Views
- Excellent Condition

# Gledstanes Road, London, W14

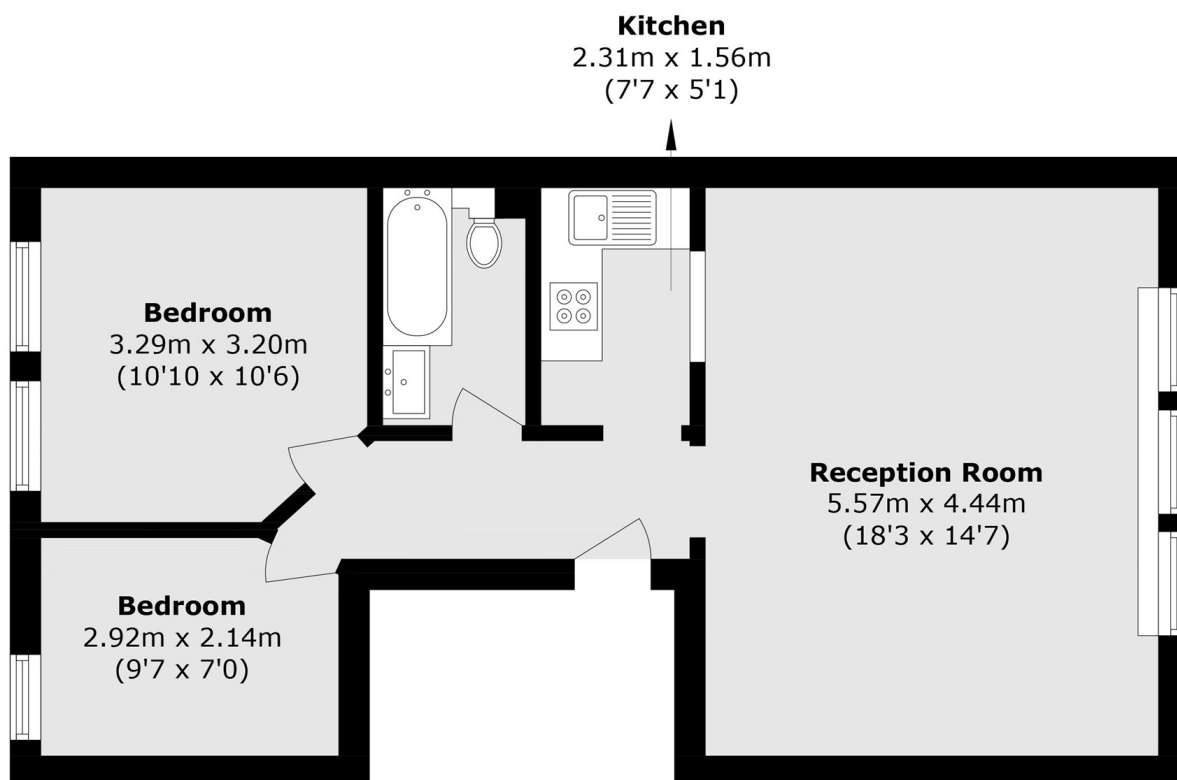

## First Floor

Total area (approx): 54.0 sq. m (581.2 sq. ft)