



Bloomsbury

London, WC1E

£2,816.67 per month
(£650.00 per week)

Spacious 2 bed apartment within a sought after period mansion block Ridgmount Gardens. Enjoying an excellent Bloomsbury location, with easy access to Covent Garden & Tottenham Court Road. The building benefits from a daytime porter on site.

CHESTERTONS



Bloomsbury

London, WC1E

- 2 Bedrooms
- Large Living Room
- Separate Kitchen
- Excellent Location
- Close to the area's Universities for students and academics



Spacious 2 bed apartment within a sought after period mansion block Ridgmount Gardens. Enjoying an excellent Bloomsbury location, with easy access to Covent Garden & Tottenham Court Road. The building benefits from a daytime porter on site.

Excellent transport links from Tottenham Court Road and Goodge Street both under 10 minutes away. Amenities in Bloomsbury & Fitzrovia are within close proximity, with cafes, grocery, and dining options all at your doorstep.

With 2 double bedrooms, bright reception room, separate kitchen & bathroom, the apartment is located on the lower ground floor of a

Minimum Term: 12 months
Deposit Required: £3,250.00
Local Authority: Camden
Council Tax Band: E
EPC Rating: C
Furnished

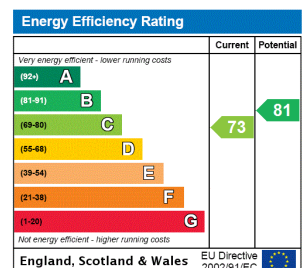

Chestertons Covent Garden Lettings

196 Shaftesbury Avenue
 Covent Garden
 London
 WC2H 8JF
 coventgardenlettingsusers@chestertons.co.uk
 02030408400
 chestertons.co.uk

Additional tenant charges apply (fees apply to non-AST tenancies only)
 Tenancy Agreement Fee: £300
 References per Tenant/Guarantor: £60
 Inventory check (approx. £100 – £250 inc. VAT)
 chestertons.co.uk/property-to-rent/applicable-fees

Ridgmount Gardens, WC1

Approx. Gross Internal Area 571 Sq Ft - 53.05 Sq M

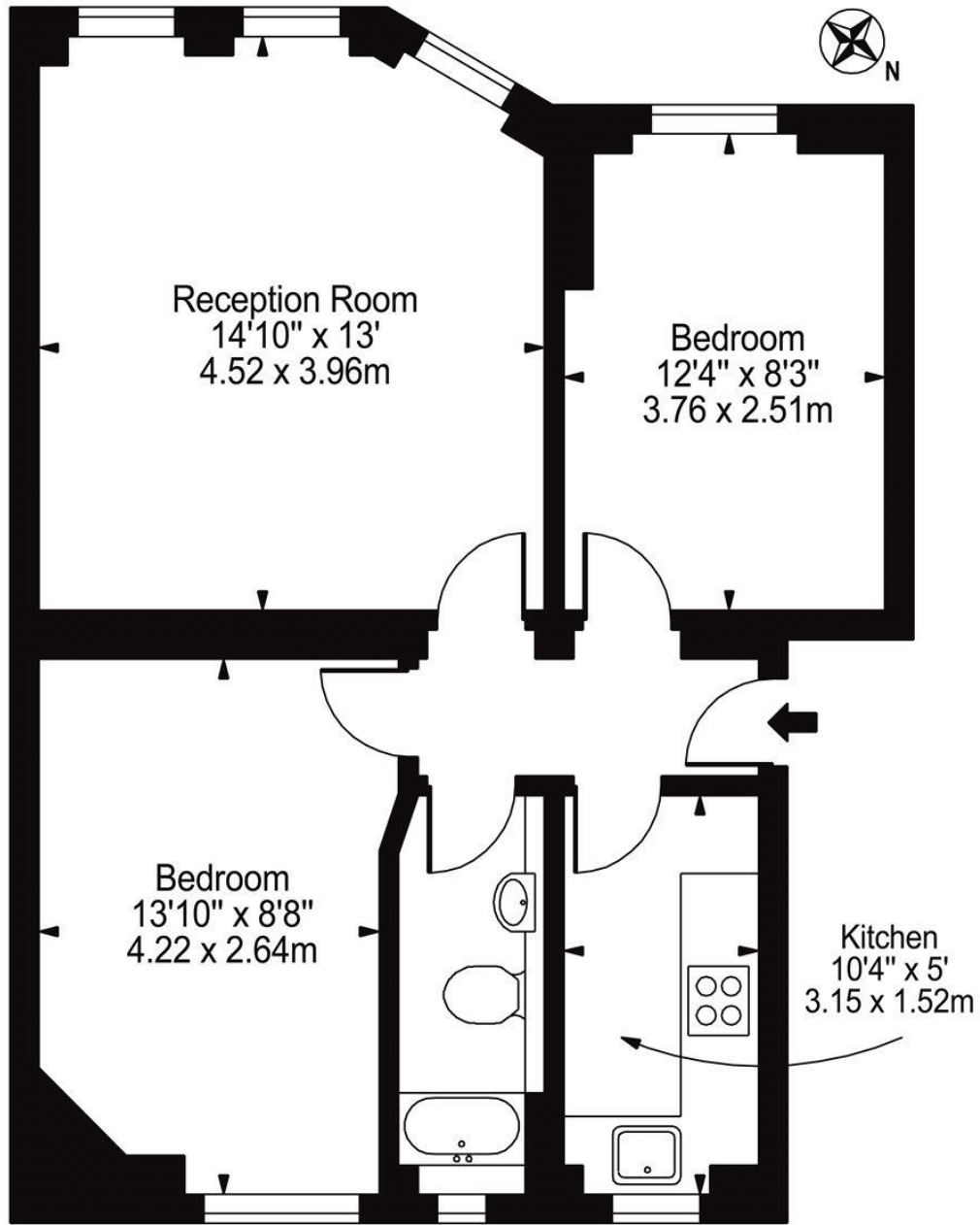

Lower Ground Floor

For Illustration Purposes Only - Not To Scale

This floor plan should be used as a general outline for guidance only and does not constitute in whole or in part an offer or contract. Any intending purchaser or lessee should satisfy themselves by inspection, searches, enquiries and full survey as to the correctness of each statement. Any areas, measurements or distances quoted are approximate and should not be used to value a property or be the basis of any sale or let.

