

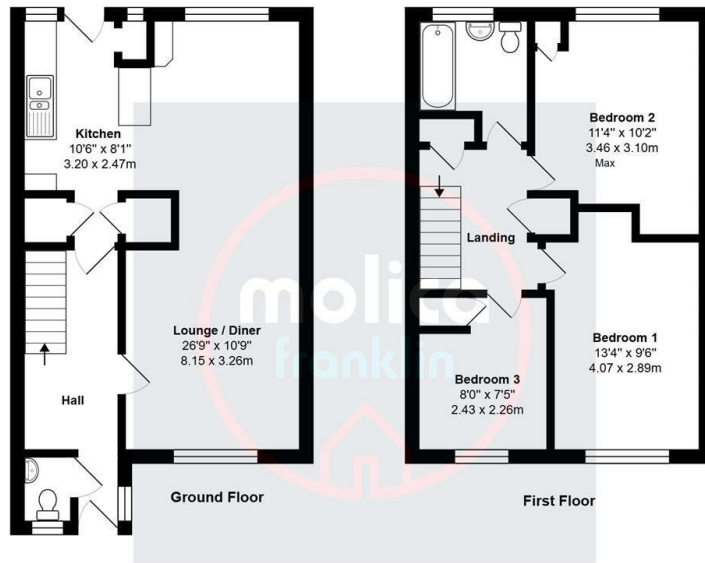

## 21 Elspring Mead, Wick, Littlehampton, West Sussex, BN17 7JE

£1,400 Per Month

- AVAILABLE FROM EARLY MAY
- Mid-Terrace House
- 26'9 Double Aspect Lounge/Diner
- New Flooring To Be Fitted Throughout
- Three Bedrooms
- Ground Floor W/C
- Bathroom To Be Modernised
- Situated on a Walkway with No Through Traffic
- Front & Rear Gardens



Total Approx. Floor Area 961 ft<sup>2</sup> ... 89.3 m<sup>2</sup>

Whilst every attempt has been made to ensure the accuracy of the floor plan contained here, measurements are approximate and no responsibility is taken for any error, omission or mis-statement. This plan is for illustrative purposes only and should be used as such by any prospective purchaser. Prepared by 1st Image 2025

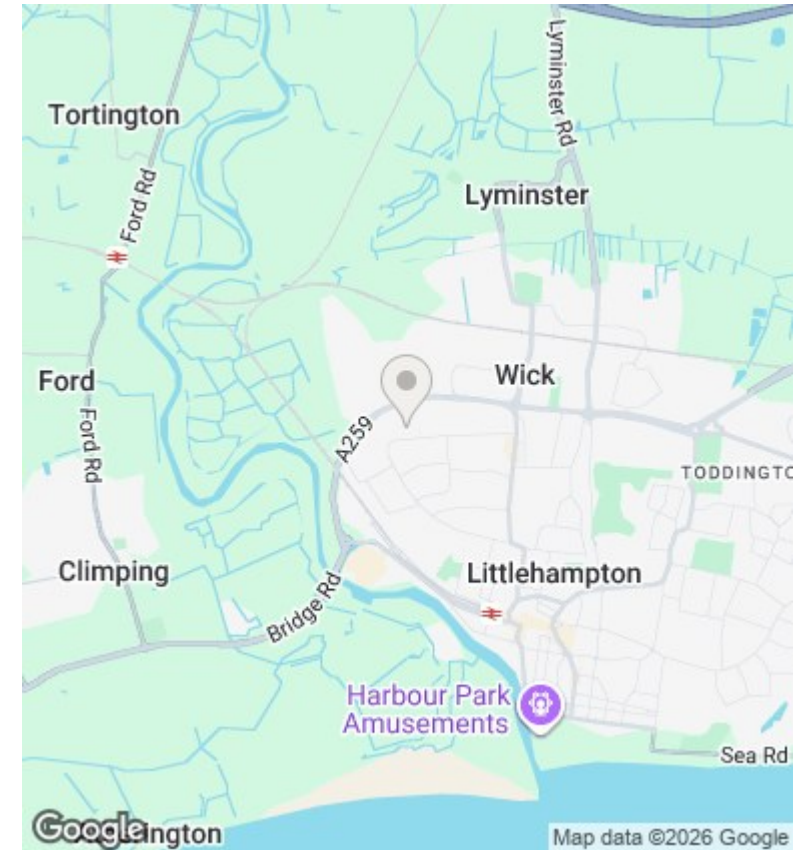

## Directions

## Viewings

Viewings by arrangement only. Call 01903 719333 to make an appointment.

## Council Tax Band

B

## EPC Rating:

D

Energy Efficiency Rating		Current	Potential
<i>Very energy efficient - lower running costs</i>			
(92 plus)	A		
(81-91)	B		
(69-80)	C		79
(55-68)	D	68	
(39-54)	E		
(21-38)	F		
(1-20)	G		
<i>Not energy efficient - higher running costs</i>			
<b>England &amp; Wales</b>		EU Directive 2002/91/EC	