



## Ratray Road, SW2

£2,600 Per calendar month

Set on the first floor, this modern two bedroom flat comes with a private terrace, ideal for those summer evenings. Offering an open plan reception room, space for dining and wooden flooring.

With Electric Brixton, Ritzy Cinema, Brixton Market and Brixton's Tesco Superstore all on your doorstep, Ratray Road is perfectly located for any young commuters.

### Features

- First Floor Flat
- Two Double Bedrooms
- Open Plan Reception
- Modern Interior
- Private Terrace
- Wooden Flooring

# Rattray Road, London, SW2

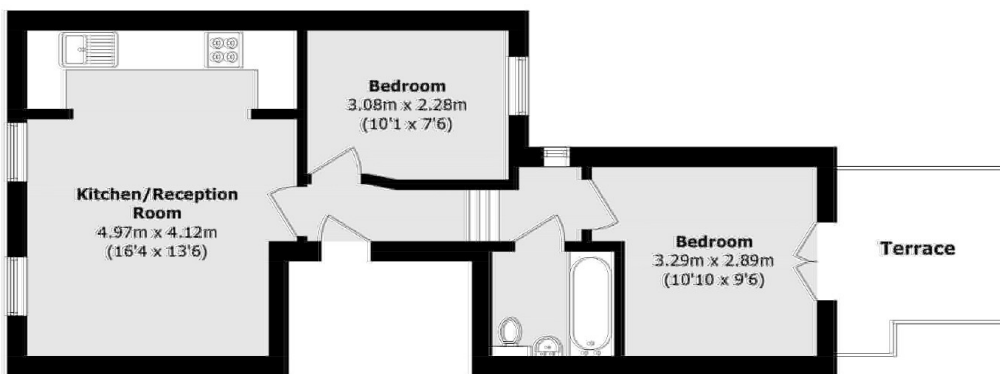

Total area (approx.): 44.1 sq. m (474.6 sq. ft)

Terrace area (approx.): 6.4 sq. m (68.8 sq. ft)