

est 1979

Jeremy
Leaf & Co.



39 Edmunds Walk, London, N2 0HU

£750,000

- Secondary Glazed Windows
- Large Kitchen/Diner
- Three Bedrooms
- Lease 999 Years from 27/11/2003
- Garage
- Gas Central Heating
- Chain Free
- Kitchen/Diner

98 High Road, London, N2 9EB
020 8444 5222

eastfinchley@jeremyleaf.co.uk
<https://www.jeremyleaf.co.uk/>

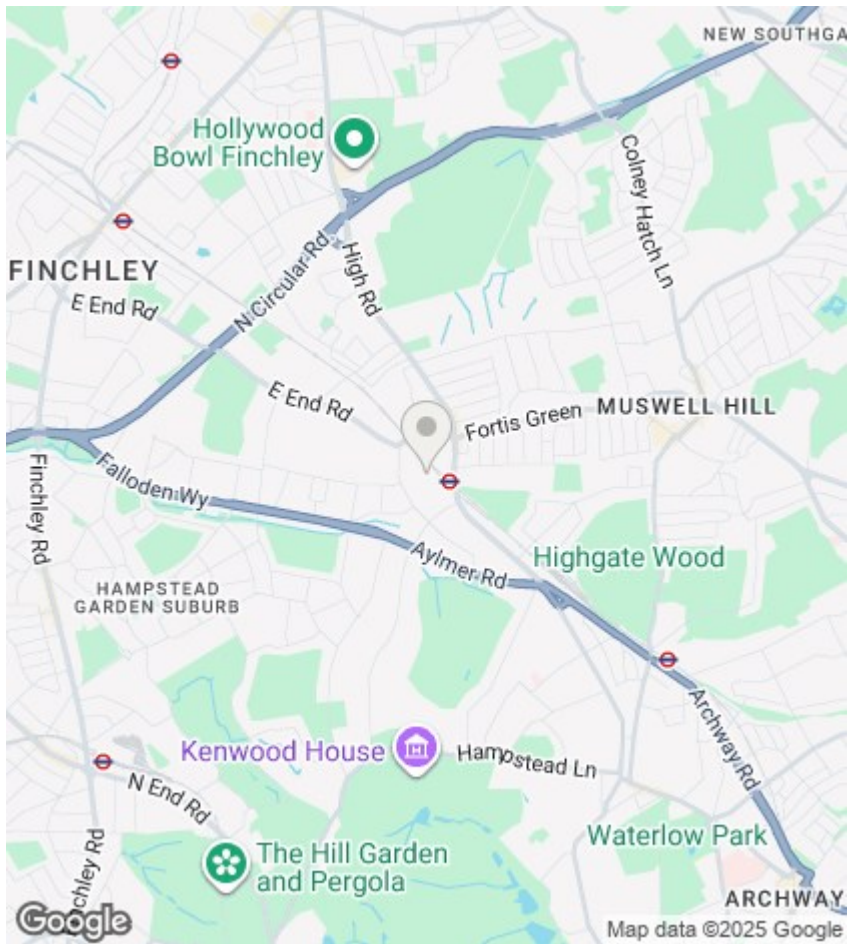

Directions

Viewings

Viewings by arrangement only. Call 020 8444 5222 to make an appointment.

Council Tax Band:

E

EPC Rating:

C

Energy Efficiency Rating		
	Current	Potential
Very energy efficient - lower running costs		
(92 plus) A		
(81-91) B		
(69-80) C	70	79
(55-68) D		
(39-54) E		
(21-38) F		
(1-20) G		
Not energy efficient - higher running costs		
England & Wales		
EU Directive 2002/91/EC		

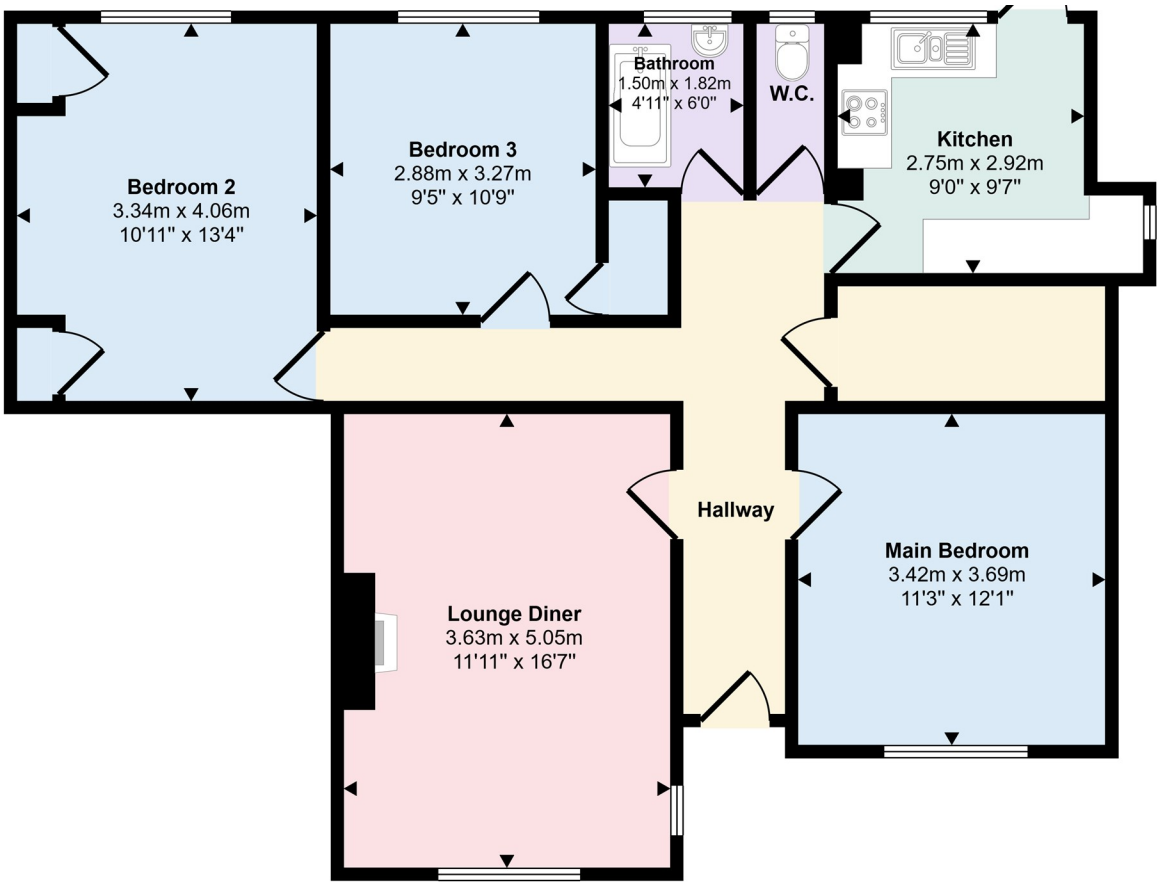

Floorplan