



Gloucester Terrace, W2

£550,000

A one bedroom flat in a white stucco fronted Victorian conversion on one of the most popular roads in W2. This ground floor property has a bright open plan kitchen/living area, large family bathroom and a spacious double bedroom.

Ideally located for Paddington station, giving easy access across London and to Heathrow. There's plenty of local shops and restaurants to choose from and the green spaces of Hyde Park are close by.

Features

- One Bedroom
- Open Plan
- Close to Hyde Park
- White Stucco Fronted
- Additional Storage
- Share Of Freehold

Gloucester Terrace, London, W2

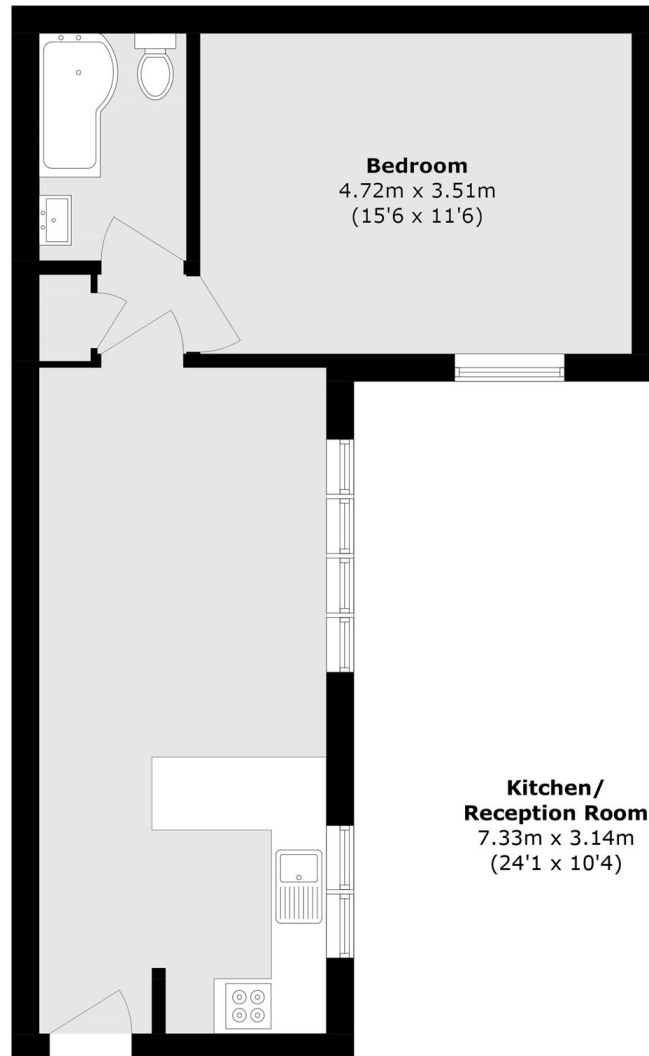

Total area (approx.): 46.1 sq. m (496.2 sq. ft)