



**19 Bath Court Powney Road, Maidenhead, SL6 6ER**  
**£275,000 Leasehold**

CHAIN FREE – A newly decorated top floor apartment in Bath Court, close to Maidenhead town centre and the Elizabeth Line station. The accommodation includes a garage and has excellent access to local shops, transport links, and amenities.

## **Entry Phone System**

### **Entrance Door**

Stairs to second floor

### **Entrance Hall**

Loft hatch, storage cupboard

### **Living Room**

Double aspect overlooking the front and back of the building, storage heater

### **Kitchen**

Fitted units with work surfaces with inset stainless steel sink, built in oven with hob and extractor over, floor and wall cupboards and drawers, space for tall fridge/freezer

### **Bathroom**

newly fitted, bath with shower, close coupled WC, wash basin with cupboard under, fully tiled

### **Double Bedroom**

Storage heater, built in double mirrored wardrobe

### **Bedroom 2**

Storage heater

### **Outside**

Gated entrance, well kept communal gardens, parking space

### **Garage**



Floor Plan

Approximate Floor Area = 62.3 sq m / 670 sq ft

Bath Court

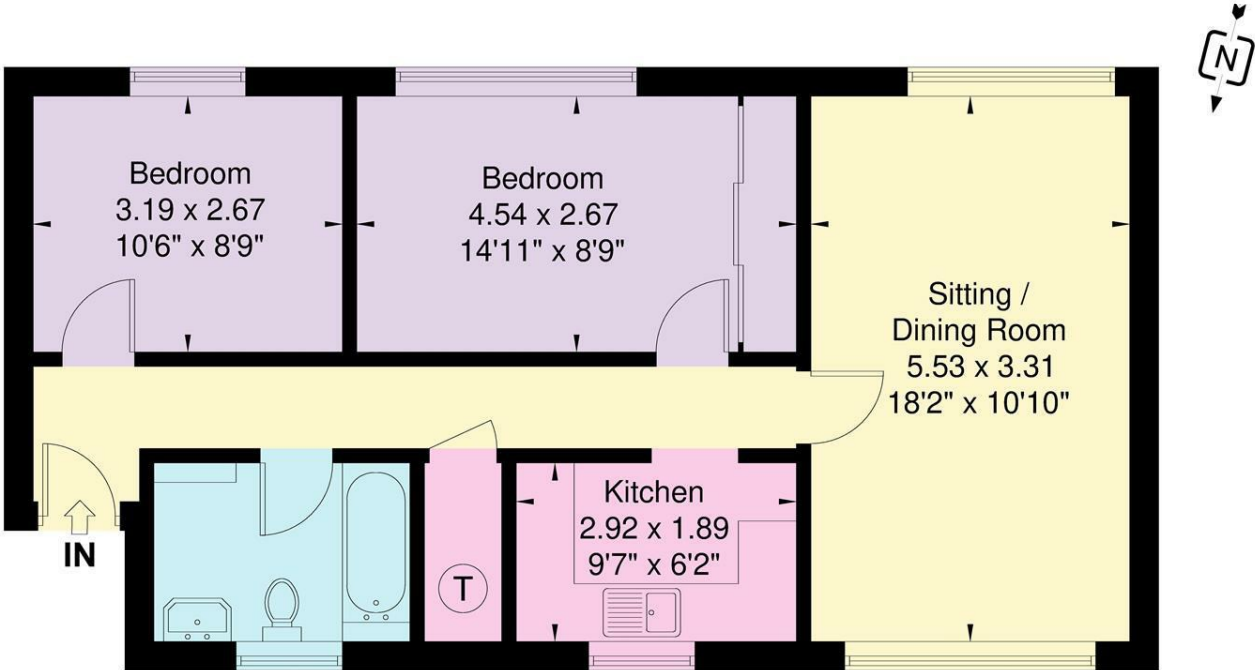

Second Floor

Illustration for identification purposes only, measurements are approximate, not to scale.

Area Map

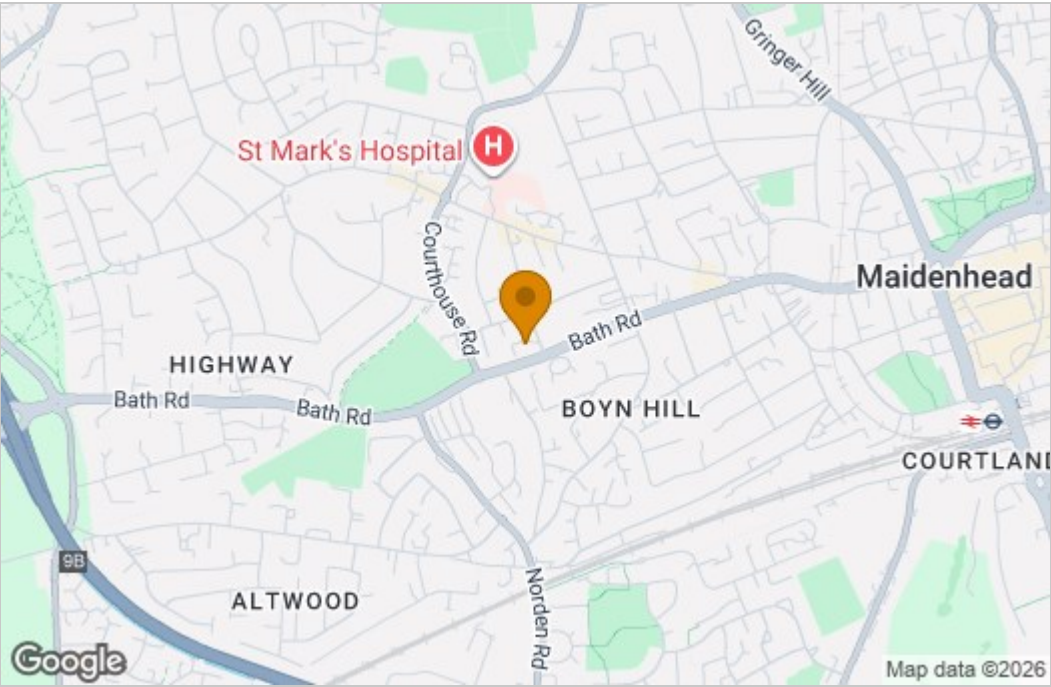

Energy Efficiency Graph

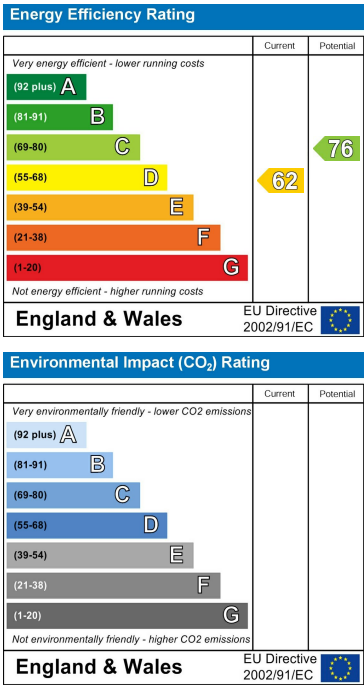

These particulars, whilst believed to be accurate are set out as a general outline only for guidance and do not constitute any part of an offer or contract. Intending purchasers should not rely on them as statements of representation of fact, but must satisfy themselves by inspection or otherwise as to their accuracy. No person in this firms employment has the authority to make or give any representation or warranty in respect of the property.