



44 Mitchell Road, Bedworth

Bedworth

£125,000



**SHELDON
BOSLEY
KNIGHT**

LAND AND
PROPERTY
PROFESSIONALS

44 Mitchell Road

Bedworth, Bedworth

First floor maisonette| Lounge| Kitchen with hob & oven| Two bedrooms| Shower room| Gas central heating| Double glazing| Rear garden| No upward chain

Council Tax band: A

Tenure: Leasehold

- First Floor Maisonette
- Lounge
- Kitchen with Hob & Oven
- Two Bedrooms
- Shower Room
- Gas Central Heating
- Double Glazing
- Rear Garden
- No Upward Chain





First Floor

Approx. 64.3 sq. metres (692.1 sq. feet)

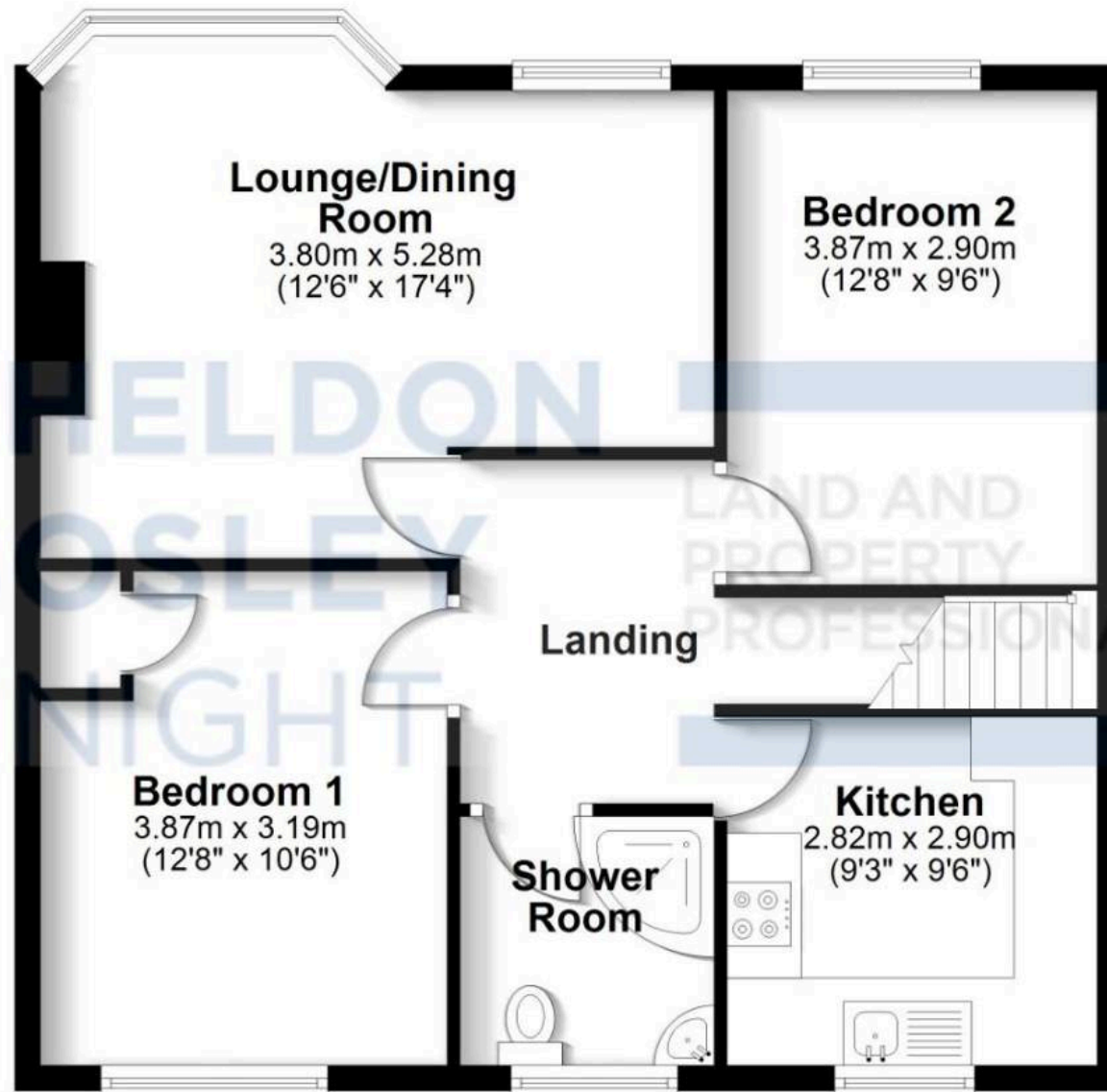

Total area: approx. 64.3 sq. metres (692.1 sq. feet)

All efforts have been made to ensure the measurements are accurate on this floor plan, however these are for guidance purposes only.

Plan produced using PlanUp.



Sheldon Bosley Knight Nuneaton

Sheldon Bosley Knight, 39 Newdegate Street - CV11 4ER

02476374949 • nuneaton@sheldonbosleyknight.co.uk • www.sheldonbosleyknight.co.uk/