



**Connells**

Jonathan Road  
Coventry





## Property Description

Mid terrace property situated in the popular residential area of Walsgrave, close to local amenities and transport links. The accommodation briefly comprises; ground floor: lounge and a fitted kitchen. To the first floor there are three bedrooms and a fitted bathroom with separate w/c. Outside there is a rear garden.

## Approach

Front door.

## Entrance Hall

Stairs to first floor, storage heater and doors to:

## Lounge

15' 8" x 12' 3" max ( 4.78m x 3.73m max )  
Double glazed window to the rear elevation, storage heater and door opening onto rear garden.

## Fitted Kitchen

13' 7" x 9' 4" ( 4.14m x 2.84m )  
Wall and base mounted units incorporating an inset single drainer stainless steel sink unit with work surfaces. Cooker point, plumbing for automatic washing machine, space for domestic appliance, double glazed window to the front elevation.

## First Floor Landing

Airing cupboard, two storage cupboards, loft hatch and doors to;

## Bedroom One

13' 11" x 6' 9" ( 4.24m x 2.06m )  
Double glazed window to the front elevation and a panel heater.

## Bedroom Two

12' 2" x 8' 11" ( 3.71m x 2.72m )  
Double glazed window to the rear elevation and a panel heater.

## Bedroom Three

9' 4" x 6' 6" ( 2.84m x 1.98m )  
Double glazed window to the rear elevation and a panel heater.

## Fitted Bathroom

Tiled, comprising bath with shower over, wash hand basin and double glazed window to the front elevation.

## Separate W/C

Comprising toilet and double glazed window to the front elevation.

## Outside

## Rear Garden

Paved with outside store and rear gated access.

## Agents Note

This property is part of a large Title that includes other properties that are not included in this sale. The creation of a new Title for the property being sold will be undertaken during the conveyance in preparation for completion. Your conveyancer will take the necessary steps and advise you accordingly.

We may not have all material information relating to this property which is sold as seen. If there is any point which is of particular importance to you, please contact the branch and we will endeavour to check for you, especially if you are contemplating travelling some distance to view the property.

Service charges apply to this property. Please enquire with the branch where they would be happy to check what is included in the service charge .



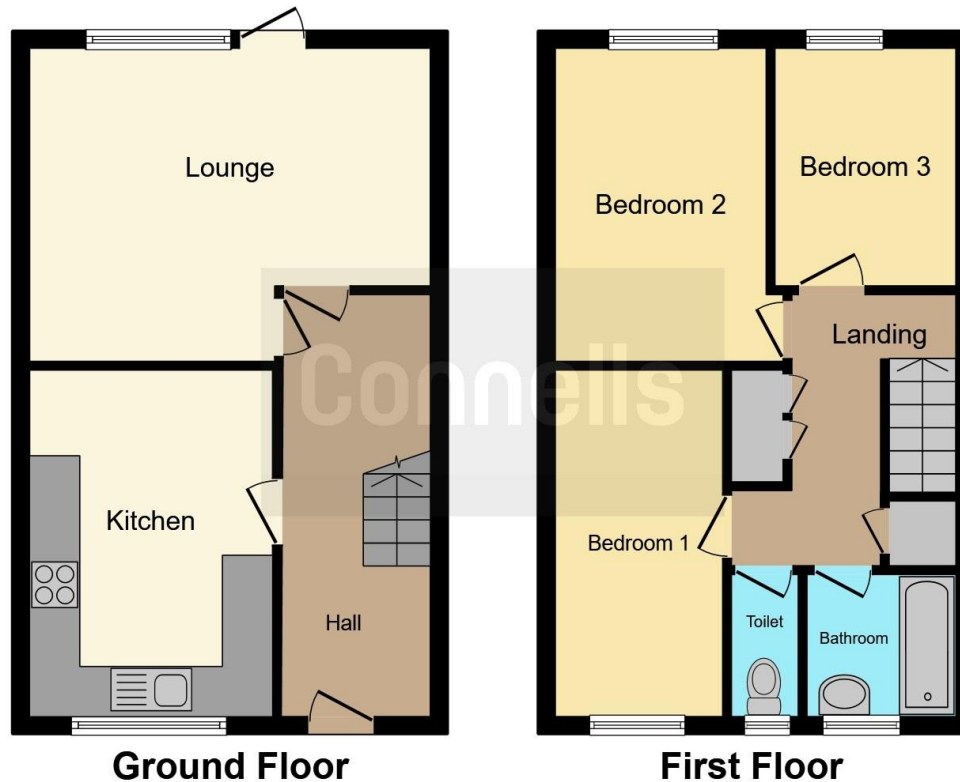

This floor plan is for illustrative purposes only. It is not drawn to scale. Any measurements, floor areas (including any total floor area), openings and orientation are approximate. No details are guaranteed, they cannot be relied upon for any purpose and they do not form part of any agreement. No liability is taken for any error, omission or misstatement. A party must rely upon its own inspection(s). Powered by [www.focalagent.com](http://www.focalagent.com)

To view this property please contact Connells on

**T 02476 553 093**  
**E [coventry@connells.co.uk](mailto:coventry@connells.co.uk)**

38 New Union Street  
 COVENTRY CV1 2HN

EPC Rating: E Council Tax  
 Band: B

**view this property online [connells.co.uk/Property/COV322985](http://connells.co.uk/Property/COV322985)**



Tenure: Freehold



1. MONEY LAUNDERING REGULATIONS Intending purchasers will be asked to produce identification documentation at a later stage and we would ask for your co-operation in order that there will be no delay in agreeing the sale. 2. These particulars do not constitute part or all of an offer or contract. 3. The measurements indicated are supplied for guidance only and as such must be considered incorrect. Potential buyers are advised to recheck measurements before committing to any expense. 4. We have not tested any apparatus, equipment, fixtures, fittings or services and it is in the buyers interest to check the working condition of any appliances.

Connells Residential is registered in England and Wales under company number 1489613, Registered Office is Cumbria House, 16-20 Hockliffe Street, Leighton Buzzard, Bedfordshire, LU7 1GN. VAT Registration Number is 500 2481 05.

**See all our properties at [www.connells.co.uk](http://www.connells.co.uk) | [www.rightmove.co.uk](http://www.rightmove.co.uk) | [www.zoopla.co.uk](http://www.zoopla.co.uk)**

Property Ref: COV322985 - 0003