



29 Woodfield Crescent,
Offers Over £115,000

🛏️ 2 🚿 1 🚗 1



- Ground floor cottage flat
- 2 Spacious double bedrooms
- Immaculate fully refurbished interior
- New modern kitchen
- Contemporary shower room
- Brand new gas boiler with warranty
- Private front and rear gardens
- Permission for driveway
- EPC Rating C (72)
- Council Tax Band B



Immaculately presented ground floor flat offers spacious, modern living combined with excellent accessibility. Recently upgraded and finished to a high standard throughout.

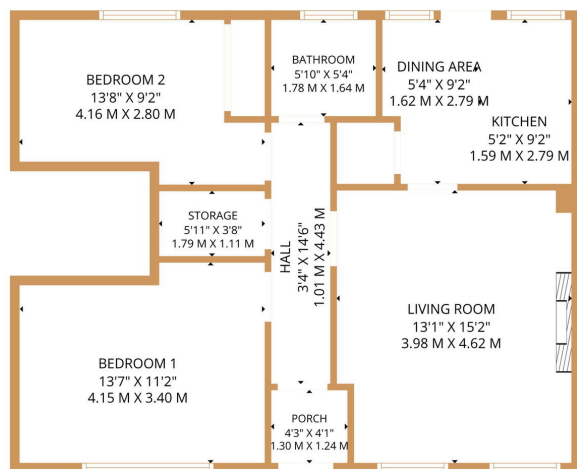

TOTAL: 664 sq. ft. 62 m2
 1st floor: 664 sq. ft. 62 m2
 EXCLUDED AREAS: PORCH: 17 sq. ft. 2 m2, STORAGE: 21 sq. ft. 2 m2, WALLS: 64 sq. ft. 5 m2
SIZES AND DIMENSIONS ARE APPROXIMATE. ACTUAL MAY VARY. © FOUR WALLS MEDIA

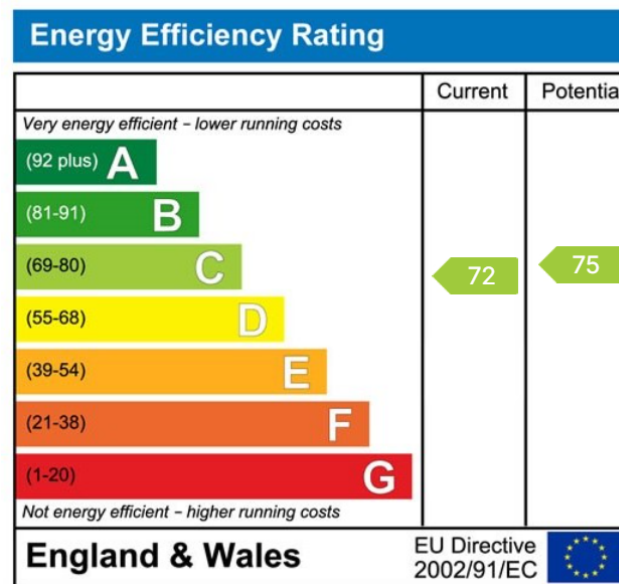

01292 437 045
 office@belmontproperty.com
 24 Dalmellington Road, Ayr, KA7 2PZ

belmontproperty.com

Agents Note: Whilst every care has been taken to prepare these sales particulars, they are for guidance purposes only. All measurements are approximate and for general guidance purposes only and whilst every care has been taken to ensure their accuracy, they should not be relied upon and potential buyers are advised to recheck the measurements