



WELLINGTON GARDENS, SE7

£350,000

Conversion flat
Two bedrooms
One bathroom
Private garden
Share of freehold
Energy rating: d

@marshandparsons
marshandparsons.co.uk

MARSH &
PARSONS



ABOUT THE PROPERTY

This beautifully presented top floor conversion flat offers bright, spacious living in a sought-after location. It features a large double bedroom, a second bedroom, a generous bathroom, and a south facing aspect that fills the home with natural light. A private garden provides a rare outdoor retreat. Offered with a share of freehold, this charming flat combines period character with modern practicality, set within a well-maintained period building on a quiet residential street.

It's just moments from Charlton station, local shops, parks, schools, and well-connected bus routes to North Greenwich Tube.



STEP INSIDE WELLINGTON GARDENS

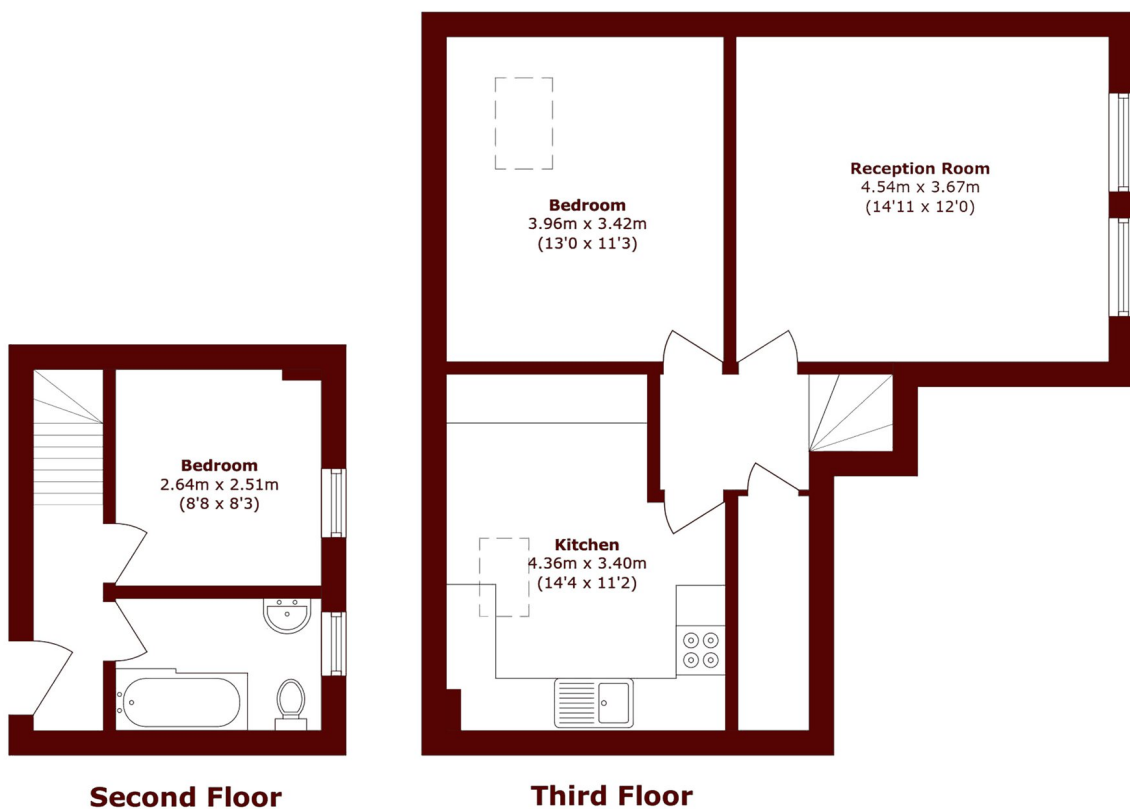

Total area (approx.): 68.3 sq. m (735.1 sq. ft)

Charlton
020 8293 0454

Energy Rating: D We aim to make our particulars both accurate and reliable. However, they are not guaranteed; nor do they form part of an offer or contract. If you require clarification on any points then please contact us, especially if you're traveling some distance to view. Please note that appliances and heating systems have not been tested and therefore no warranties can be given as to their good working order

**MARSH &
PARSONS**