



**POOLE
TOWNSEND**

Riverdale Court, Kendal, LA9 7LQ

£350,000

🛏️ 2 🍴 2 🚗 1



- First-Floor Apartment
- Riverside Location
- Two Double Bedrooms
- Fully Fitted Kitchen
- Allocated parking & private garage
- Private Balcony
- Spacious Open-Plan Living/ Dining Area
- En-Suite Master
- Well-Maintained Communal Gardens
- Council Tax Band: E



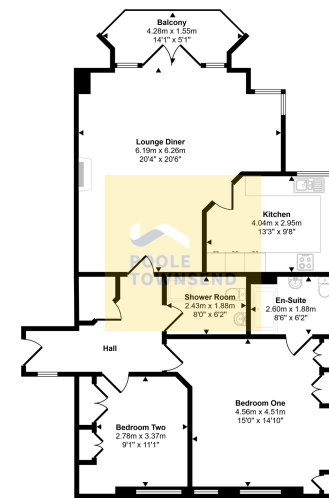

Floorplan
Approx 99 sq m / 1067 sq ft

This floorplan is only for illustrative purposes and is not to scale. Measurements of rooms, doors, windows, and any items are approximate and no responsibility is taken for any error, omission or mis-statement. Some of items such as bathroom suites are representations only and may not look like the real items. Made with Made Spriggy 360.

Nestled on the banks of the River Kent, Riverdale Court is an exclusive and sought-after residential development, ideally positioned for easy access to local amenities and transport links. Naturally bright and airy, this impressive first-floor apartment offers spacious, thoughtfully designed accommodation ideal for downsizers or those looking to retire in comfort. At its heart is a generous open-plan lounge and dining area, with glazed doors opening onto a private balcony, perfect for enjoying the tranquil riverside setting. The modern fitted kitchen is well-equipped for contemporary living, while two double bedrooms provide comfortable sleeping quarters, including a master bedroom with en-suite facilities and a separate stylish shower room. Additional benefits include allocated parking, a private garage, and secure, peaceful surroundings, making this an ideal home in a picturesque riverside location.

Visit us at
www.pooletownsend.co.uk
enquiries@pooletownsend.co.uk

We are open
 Monday – Friday 9.00 – 5.00
 Saturday 9.00 – 1.00

Barrow 01229 811811
 Ulverston 01229 588111
 Grange 015395 33316
 Kendal 01539 734455
 Milnthorpe 015395 62044