



**POOLE
TOWNSEND**

Fern Lodge, Meadows End, Allithwaite

£245,000

🛏️ 2 🚿 2 🚗 1



- Nestled in a peaceful and serene setting between Grange and Cartmel
- Available fully furnished
- Two double bedrooms
- Spacious open-plan living, dining, and kitchen area
- Private patio, decked seating area, and hot tub for a tranquil retreat experience
- Impressive detached lodge with contemporary décor
- Individually designed, high-specification lodge
- Two stylish bathrooms
- Glazed doors opening onto a balcony seating area, blending indoor and outdoor living

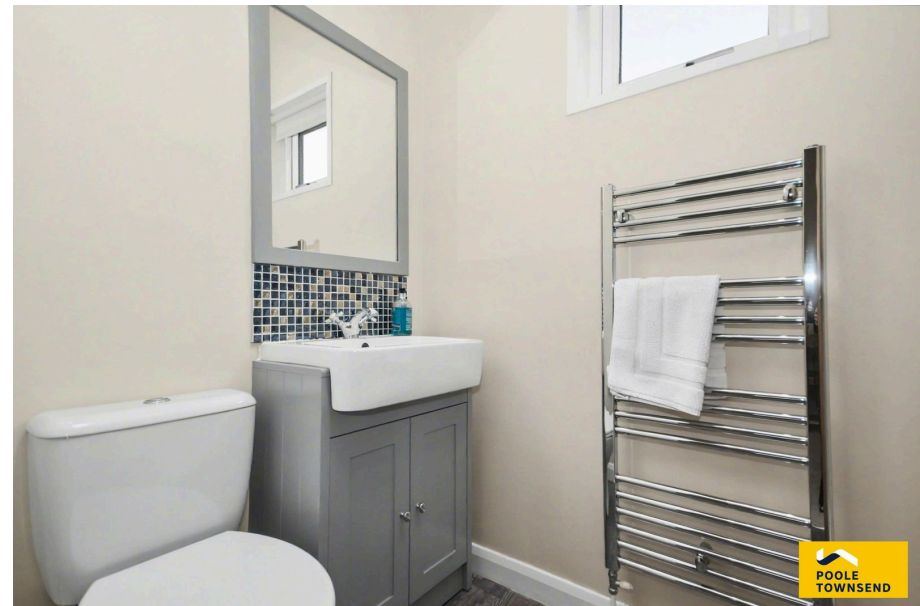

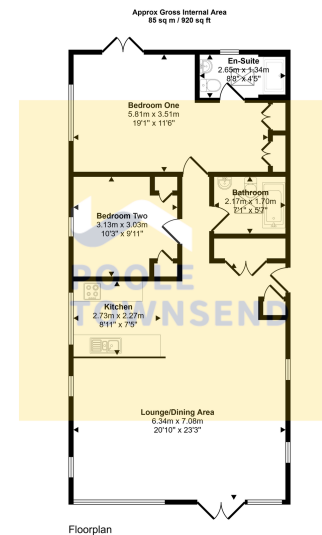

This floorplan is only for illustrative purposes and is not to scale. Measurements of rooms, doors, windows, and any items are approximate and no responsibility is taken for any error, omission or mis-statement. Items such as bathroom suites are representations only and may not look like the real items. Made with Made Snappy 360.

Nestled in a peaceful and serene setting between Grange and Cartmel, this impressive detached lodge is beautifully finished with contemporary décor, modern fixtures, and fittings, and is available fully furnished. Individually designed, this high-specification lodge features two double bedrooms, two stylish bathrooms, and a spacious open-plan living, dining, and kitchen area with glazed doors opening onto a balcony seating area, creating a seamless flow between indoor and outdoor living. Further enhancing its appeal, the property features a private patio, decked seating area, and hot tub, making it the perfect tranquil retreat for holidays or weekend escapes.

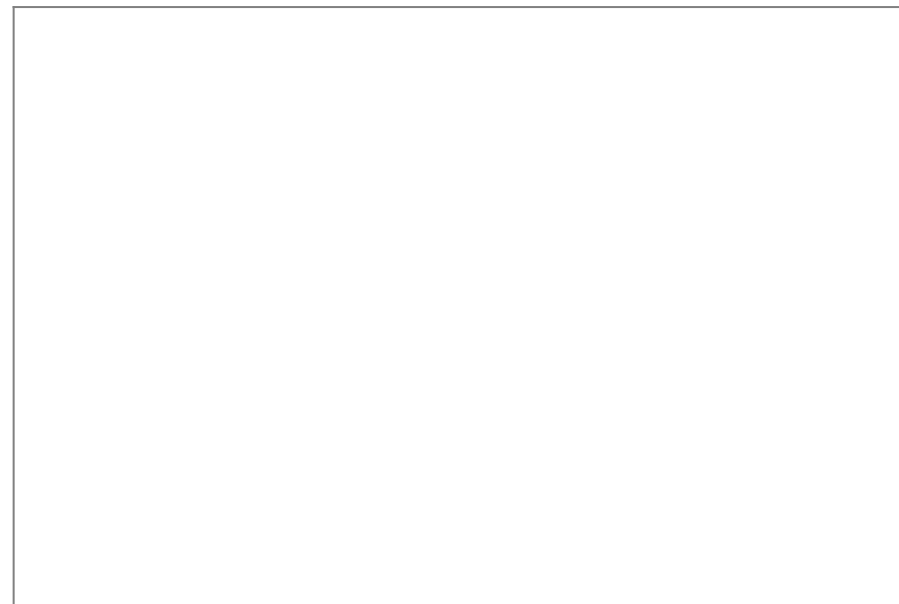

Visit us at
www.pooletownsend.co.uk
enquiries@pooletownsend.co.uk

We are open
 Monday – Friday 9.00 – 5.00
 Saturday 9.00 – 1.00

Barrow 01229 811811
 Ulverston 01229 588111
 Grange 015395 33316
 Kendal 01539 734455
 Milnthorpe 015395 62044