



## Linom Road, SW4

£2,000 Per calendar month

Neutrally decorated throughout, this spacious one bedroom property comes with a large reception room, separate kitchen and a private patio garden. Perfect for professional couples!

Linom Road, with access to both Clapham High Street and Brixton Town Centre, means you will certainly never be short of things to do!

### Features

- One Double Bedroom
- Separate Reception
- Private Patio Garden
- Ground Floor Flat
- Neutrally Decorated
- Close To Amenities

# Linom Road, London, SW4

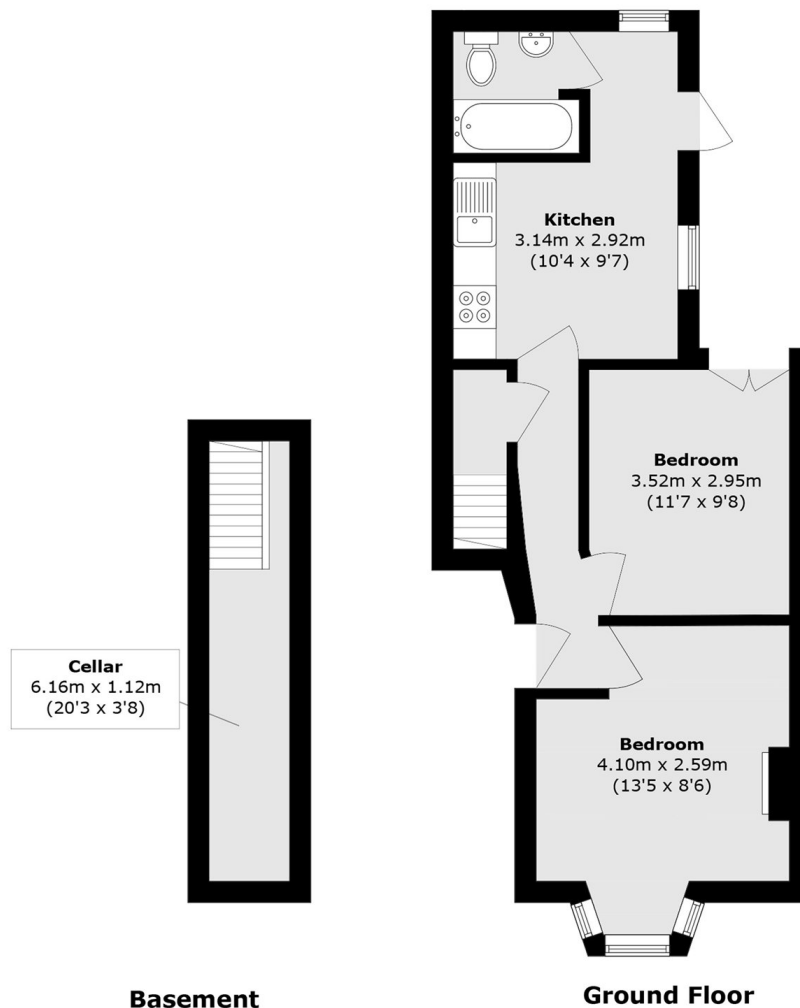

Total area (approx.): 51.0 sq. m (548.9 sq. ft)  
(Including Cellar)