



Stone Cottage, Westgate | Thornton le Dale, YO18 7SG

A pretty Grade II listed traditional cottage attractively positioned on Westgate with suprisingly large and attractively laid out rear garden. The cottage has a characterful and generously sized sittingroom with open joist ceiling and fireplace and breakfast kitchen on the ground floor plus two adequate double bedrooms and bathroom on the first floor. The cottage has recently been updated and has the benefit of gas fired central heating.

Westgate is a quiet country lane leading out of the village on its southern perimeter. It quickly leads out into open countryside with a network of footpaths and bridleways.

Thornton Dale is a well known picturesque village situated within the southern boundary of the North York Moors National Park. It has a good choice of local shops and an excellent range of facilities and amenities.



Price Guide £250,000

BoultonCooper

BC
Est. 1804

Stone Cottage, Westgate | Thornton le Dale



SITTING ROOM

14'11" x 13'5" (4.55 x 4.09)

A spacious and attractive room with features including open fireplace in brick and carved wood surround, shelved side cupboard, Yorkshire Sliding Sash window, open joist ceiling, cottage style front door. Two radiators and staircase to first floor with understairs store.

BREAKFAST KITCHEN

13'4" x 8'3" (4.06 x 2.51)

Good sized kitchen with rear facing small pane window and french door, open joist ceiling, stainless steel sink unit and range of base units with work surface over and matching wall

mounted cabinet. Radiator. Ideal gas fired boiler and thermostat. Extractor, plumbing for automatic washing machine and dishwasher.

FIRST FLOOR

Turned staircase to landing.

BEDROOM ONE

13'9" x 8'6" (4.19 x 2.59)

Front facing sliding sash window and further side facing window, radiator.

BEDROOM TWO

13'10" x 8'3" (4.22 x 2.51)

Rear and side facing windows, radiator.



BATHROOM

Matching suite with bath, wash basin, w.c., tiled walls, electric shower unit over bath, radiator, extractor and light/shaver socket.

EXTERIOR

The cottage is located along Westgate with small raised front garden, stone boundary wall, lawn and shrub borders. Immediate to the cottage at the rear is a private enclosed yard and steps leading up to pathway extending through to a good sized rear garden. This stretches out for some distance and includes a lawn with colourful beds and borders containing a variety of flowering plants and

shrubs.

Towards the far end is a flagged patio with additional garden area beyond with garden shed. This latter area would make a useful vegetable garden.

OUTBUILDING

11'3" x 9'9" (3.43 x 2.97)

Housing range of base units, work surfaces, useful storage area, double glazed door, light and power.

SERVICES

Mains electricity, water and drainage, gas central heating.



Stone Cottage, Westgate | Thornton le Dale

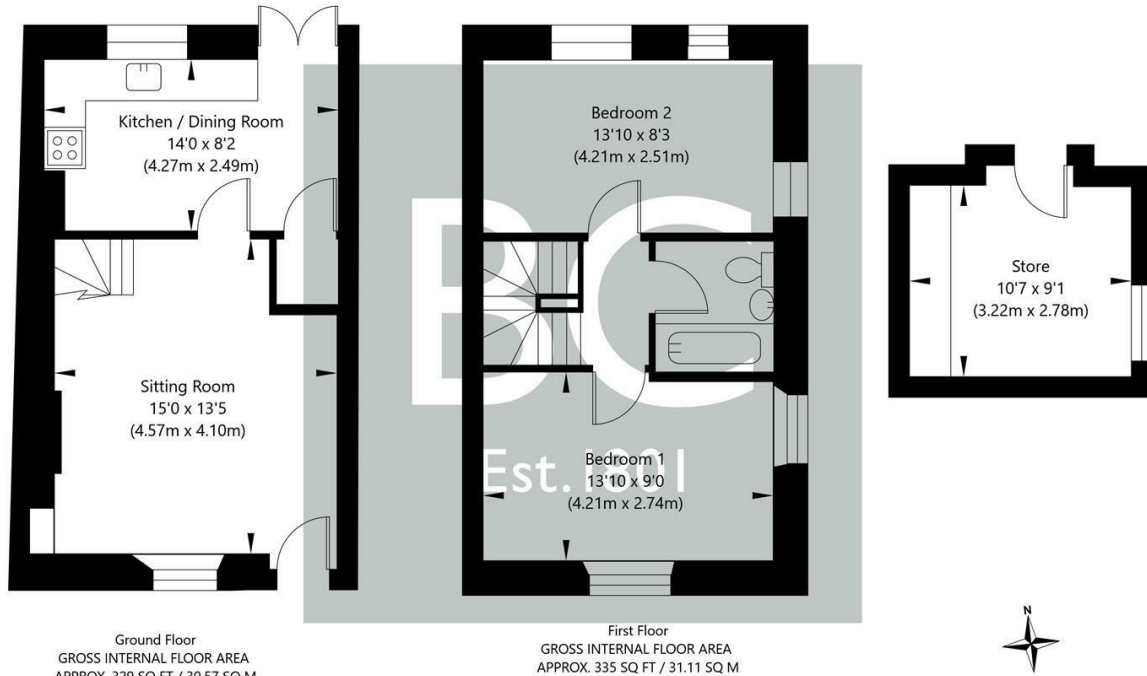

NOT TO SCALE - FOR ILLUSTRATIVE PURPOSES ONLY
 APPROXIMATE GROSS INTERNAL FLOOR AREA 664 SQ FT / 61.68 SQ M - (Excluding Store)
 All measurements and fixtures including doors and windows are approximate and should be independently verified.
 www.exposurepropertymarketing.com © 2023

VIEWING

Strictly By Appointment with the agents 01751 472724

COUNCIL TAX BAND

ENERGY PERFORMANCE RATING

D

St Georges House 39 Market Place, Pickering, YO18 7AE

t: 01751 472724

e: pickering@boultoncooper.co.uk

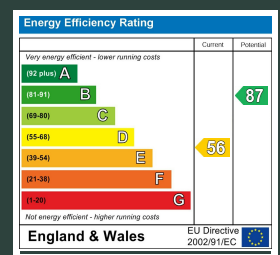

boultoncooper.co.uk



CONSUMER PROTECTION FROM UNFAIR TRADING REGULATIONS 2008

The description contained in this brochure is intended only to give a general impression of the property, its location and features, in order to help you to decide whether you wish to look at it. We do our very best to provide accurate information but we are human, so you should not allow any decisions to be influenced by it. For example any measurements are approximate and, where such things as central heating, plumbing, wiring or mains services are mentioned, we would advise you to take your own steps to check their existence and condition. Although we cannot accept any responsibility for any inferences drawn from this brochure or any inaccuracy in it, we shall always try to help you with any queries.

BoultonCooper for themselves and for the vendors or lessors of the property/properties, whose agents they are, give notice that (i) the particulars are produced in good faith, are set out as a general guide only and do not constitute any part of the contract; (ii) no person in the employment of BoultonCooper has any authority to make or give representation or warranty whatever in relation to this/these property/properties.

BC
Est. 1801