



## ASHLEY GARDENS, SW1P

£1,154 per week

This stunning three double bedroom property has been finished to an excellent standard and is bright and spacious throughout. The property comprises a large reception room with high ceilings, large bay window

Three bedrooms  
Natural light  
En-suite

Porter  
Life access  
Energy rating: c

@marshandparsons  
marshandparsons.co.uk

MARSH &  
PARSONS

# STEP INSIDE ASHLEY GARDENS

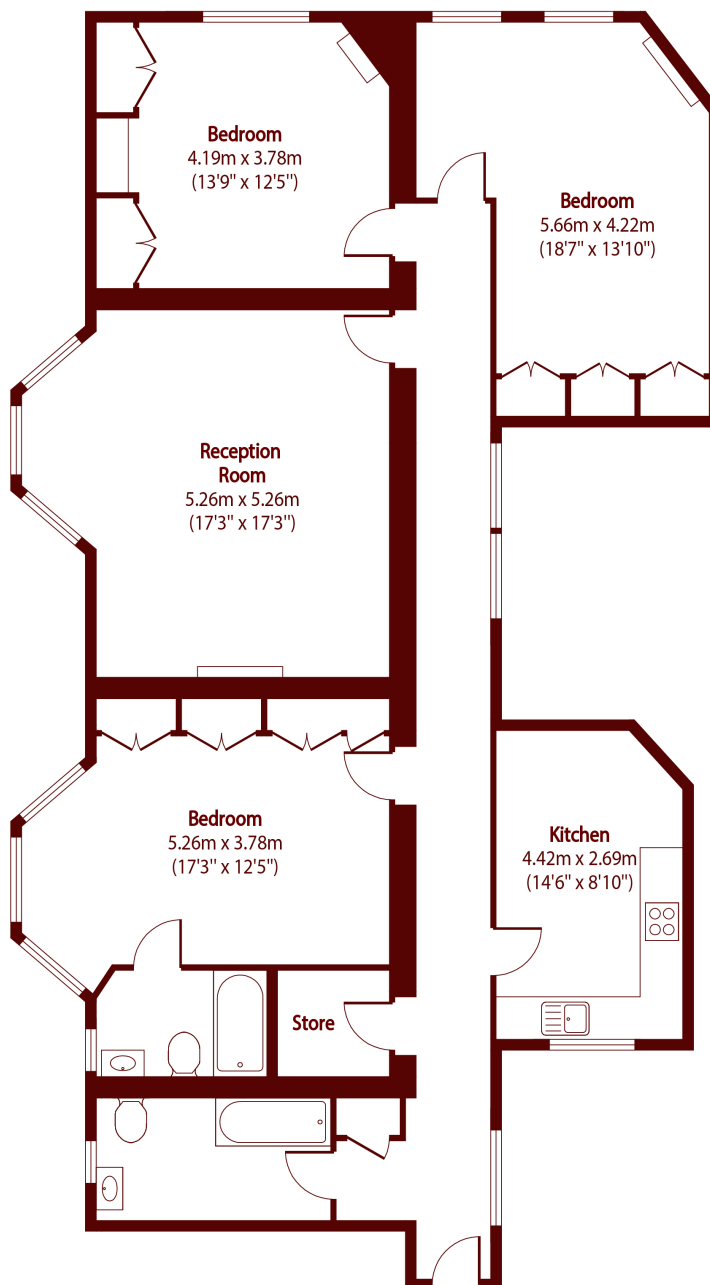

Total area (approx): 131.27 sq m (1413 sq. ft)

**Pimlico & Westminster**  
020 7828 8100

Energy Rating: C We aim to make our particulars both accurate and reliable. However, they are not guaranteed; nor do they form part of an offer or contract. If you require clarification on any points then please contact us, especially if you're traveling some distance to view. Please note that appliances and heating systems have not been tested and therefore no warranties can be given as to their good working order

**MARSH &  
PARSONS**