



AMBLESIDE STATION ROAD AL5
£1,750 PER MONTH AVAILABLE 17/06/2026

Hamptons

THE HOME EXPERTS

{ THE PARTICULARS

Ambleside Station Road AL5

£1,750 Per Month
Unfurnished

-  2 Bedrooms
-  1 Bathroom
-  1 Reception

Features

- Two bedrooms, - Family bathroom, - Off street parking, - Garden, - Unfurnished

Council Tax

Council Tax Band D

Hamptons
38 High Street
Harpenden, AL5 2SX
01582 742998
harpendenlettings@hamptons.co.uk
www.hamptons.co.uk

The Property

A two bedroom house to let conveniently located on Station Road, Harpenden within a mile of the mainline train station and Harpenden High Street. Accommodation comprises two bedrooms, spacious lounge, kitchen and family bathroom. Further selling points include off street parking to the rear and a garden. Available end of June 2026.



Ambleside, Station Road, Harpenden, AL5

Approximate Area = 628 sq ft / 58.3 sq m

For identification only - Not to scale

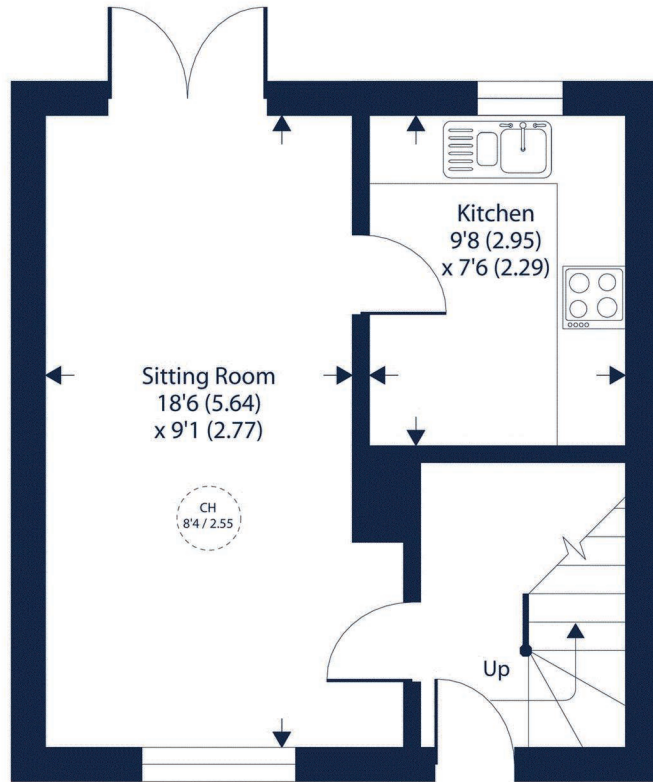
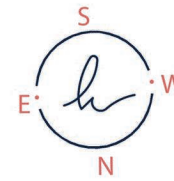

GROUND FLOOR

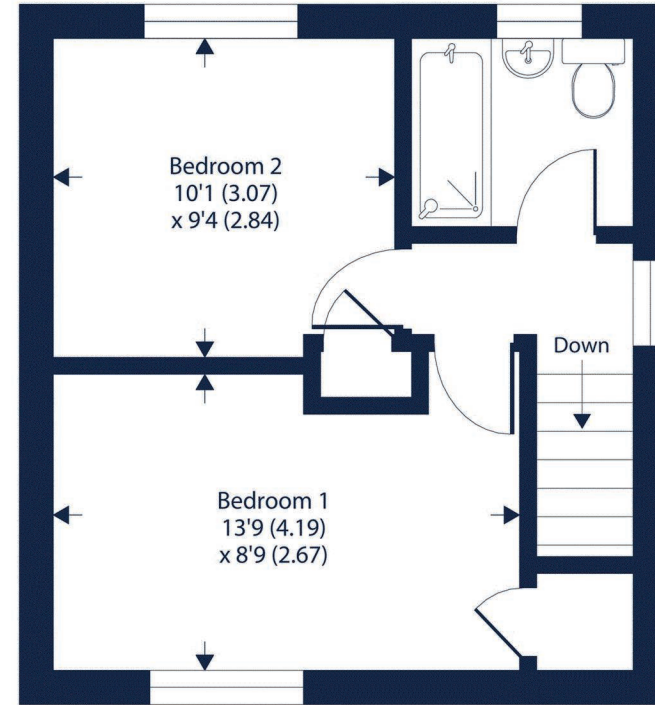

FIRST FLOOR

 Floor plan produced in accordance with RICS Property Measurement 2nd Edition, Incorporating International Property Measurement Standards (IPMS2 Residential). © nichecom 2026. Produced for Hamptons. REF: 1452302

For Clarification

We wish to inform prospective tenants that we have prepared these particulars as a general guide and they have been confirmed as accurate by the landlord. We have not verified permissions, nor carried out a survey, tested the services, appliances and specific fittings. Room sizes are approximate and measurement figures rounded: they are taken between internal wall surfaces and therefore include cupboards/shelves, etc. Accordingly, they should not be relied upon for

carpets and furnishings. It should also be noted that all fixtures and fittings, carpeted, curtains/blinds, kitchen equipment and garden statuary, whether fitted or not, are deemed removable by the landlord unless specifically itemised with these particulars. Please enquire in office or on our website for details on holding deposit and tenancy deposit figures.

