



**Walfield Avenue**  
Whetstone, London, N20 9PR  
Guide Price £895,000

4 2 2

# Walfield Avenue

Whetstone, London, N20 9PR

\* CHAIN FREE \*

Set within the sought-after Whetstone neighbourhood, this elegant four-bedroom semi-detached home beautifully blends period charm with contemporary family living across three well-balanced floors.

The ground floor offers a bright and inviting reception room flowing effortlessly into a generous dining area, forming a sociable living space filled with natural light. The modern kitchen is sleek and well-appointed with integrated appliances, ample storage, and preparation space, while a discreet ground-floor cloakroom adds everyday convenience.

Upstairs, four well-proportioned bedrooms provide great family comfort, with a principal bedroom, further rooms over first & second floor and two stylish bathrooms. The top floor offers versatile loft accommodation.

To the rear, a private, landscaped garden offers a peaceful retreat with lawn, mature planting, and a paved patio perfect for outdoor entertaining. The property also benefits from off-street parking with a drive approach and EV charger.

Combining high ceilings, original cornicing, herringbone flooring, and energy-efficient double glazing, this thoughtfully extended home is perfectly suited to modern family life, with excellent access to local schools, amenities, and transport links.

EPC : E

BARNET COUNCIL TAX BAND : F

TENURE : Freehold



SEAN HEANEY  
HOMES & PROPERTY

SEAN HEANEY

SEAN HEANEY

SEAN HEANEY

SEAN HEANEY

SEAN HEANEY  
HOMES & PROPERTY



**Hallway**

**Guest Cloakroom**

**Lounge**

15'8" x 12'2" (4.78 x 3.73)

**Kitchen/Family Room**

26'0" x 18'11" (7.93 x 5.77)

**First Floor Landing**

**Bedroom 1**

15'5" x 11'6" (4.70 x 3.51)

**Bedroom 2**

12'5" x 11'5" (3.81 x 3.48)

**Bedroom 3**

9'3" x 7'3" (2.82 x 2.21)

**Family Bathroom**

**Bedroom 4**

20'4" x 9'10" (6.21 x 3.02)

**En Suite Cloakroom**

**Mature Rear Garden**

76'6" x 20'0" (23.32 x 6.10)

**Garage/Outbuilding**

17'2" x 8'0" (5.23m x 2.44m)



## Floor Plan

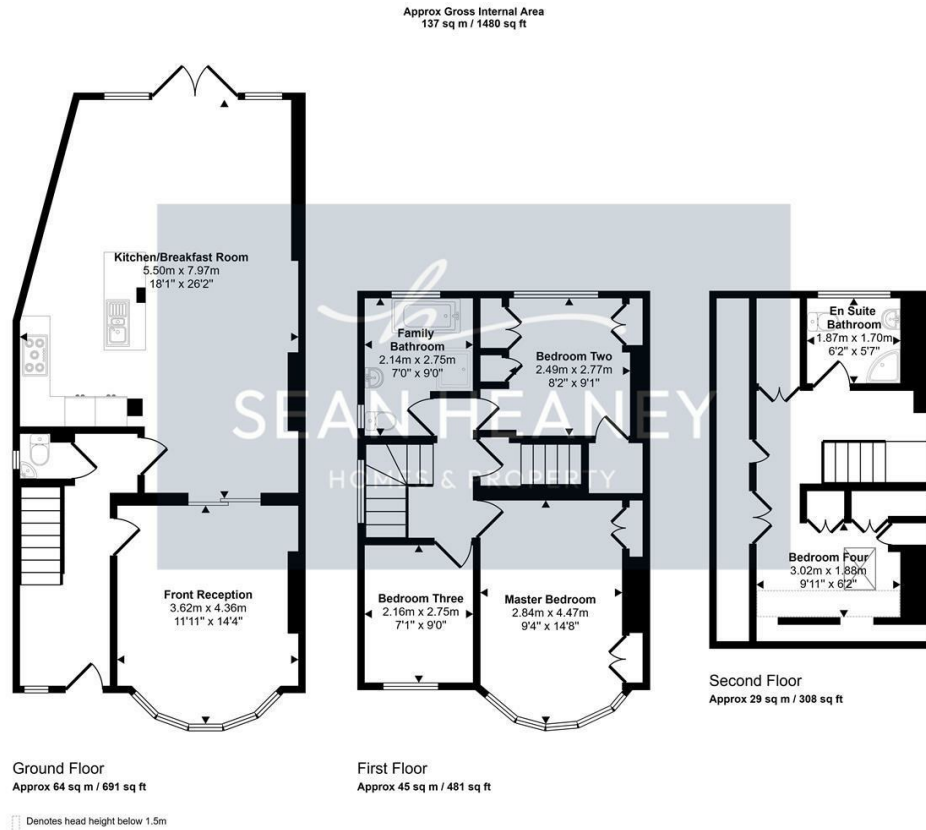

This floorplan is only for illustrative purposes and is not to scale. Measurements of rooms, doors, windows, and any items are approximate and no responsibility is taken for any error, omission or mis-statement. Icons of items such as bathroom suites are representations only and may not look like the real items. Made with Made Snappy 360.

## Viewing

Please contact our Barnet Office on 020 8441 7173 if you wish to arrange a viewing appointment for this property or require further information.

1. Please note that we have not tested any apparatus, equipment, fixtures, fittings or services, and so cannot verify they are in working order, or fit for their purpose. A buyer is advised to obtain verification from their Solicitor or Surveyor.
2. References to the tenure of a property are based on information supplied by the seller. The agent has not had sight of the title documents. A buyer is advised to obtain verification from their Solicitor.
3. Room measurements have been made using a Laser Meter. Complete accuracy cannot be guaranteed and therefore the room sizes given should be regarded as being approximate.
4. Photographs are for illustration only and may depict items which are not for sale or included in the sale of the property.
5. Floor plans remain copyright of Sean Heaney Estate Agents and are not to be copied in part or full without written consent, are provided for illustrative purposes only and are not to scale.

## Area Map

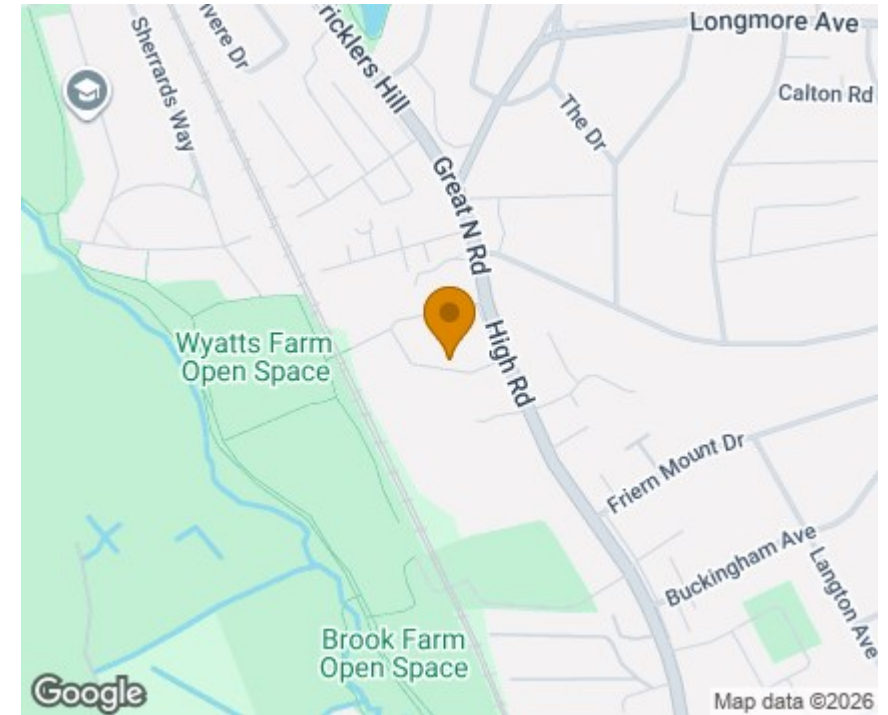

## Energy Efficiency Graph

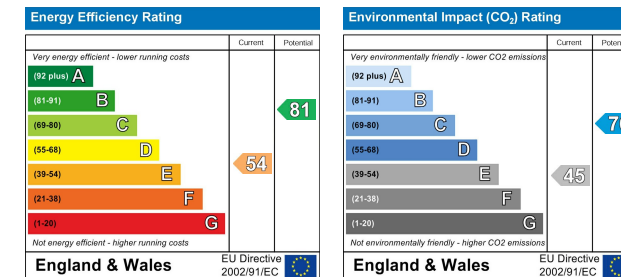

Highstone House, 165 High Street, Barnet, Hertfordshire, EN5 5SU

T: 020 8441 7173 E: sales@seanheaney.co.uk W: www.seanheaney.co.uk