



Two Stone Lane, Chipping Sodbury Bristol BS37 6DN

welcome to

Two Stone Lane, Chipping Sodbury Bristol

***** BUNGALOW ***** This fantastic two bedroom semi-detached bungalow has open plan kitchen/diner, separate lounge, shower room, garage & driveway. mature gardens. hidden away from main roads. A MUST SEE !!!!

Entrance Hall

Double glazed front door, wood effect flooring, radiator.

Lounge

Double glazed window to front, fireplace with a wood burner/multi fuel & radiator.

Shower Room

Double glazed window to side, low level wc, wash hand basin, stone panelled walls, walk-in shower, vinyl flooring. heated towel radiator.

Bedroom One

Double glazed window to rear, built in wardrobes & radiator.

Bedroom Two

Double glazed window to front, built in wardrobes & radiator.

Kitchen/Diner

French doors leading to rear garden, window to side, stainless steel sink and drainer wall and base units with worktops over, electric double oven and hob, extractor fan, built in fridge freezer, built in dishwasher, freestanding washing machine & breakfast bar. wood effect flooring.

Garage / Parking

Up & over garage door, with power and lighting. Parking for multiple vehicles.

Front Garden

Front gate leading to path, lawn laid with shrubs.

Entrance Hall

Double glazed front door, wood effect flooring, radiator.

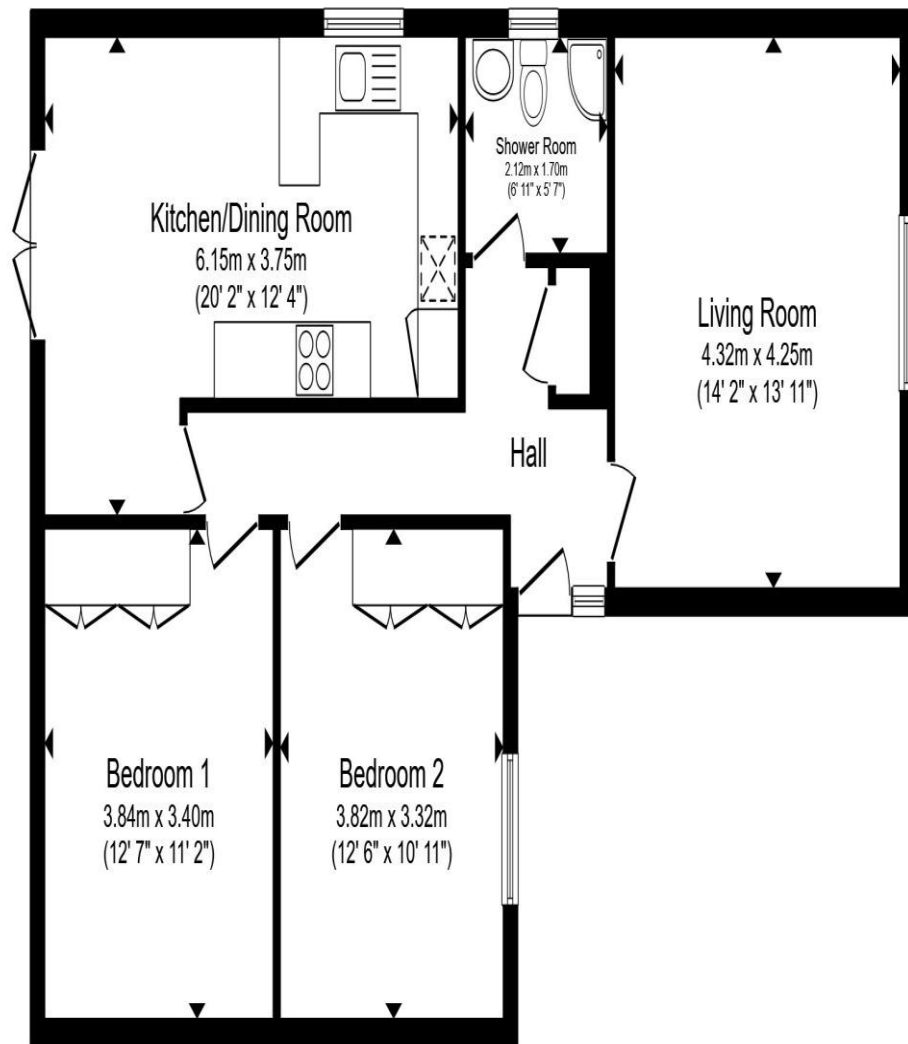

Total floor area 78.0 m² (839 sq.ft.) approx

This floor plan is for illustrative purposes only. It is not drawn to scale. Any measurements, floor areas (including any total floor area), openings and orientation are approximate. No details are guaranteed, they cannot be relied upon for any purpose and they do not form part of any agreement. No liability is taken for any error, omission or misstatement. A party must rely upon its own inspection(s). Powered by www.propertybox.io



welcome to
Two Stone Lane,
Chipping Sodbury Bristol

- SEMI-DETACHED BUNGALOW
- TWO BEDROOMS
- OPEN PLAN KITCHEN/DINER
- SHOWER ROOM
- SEPARATE LOUNGE

Tenure: Freehold EPC Rating: C
Council Tax Band: C

offers in excess of
£475,000



view this property online allenandharris.co.uk/Property/CPS105402



Property Ref:
CPS105402 - 0003

1. MONEY LAUNDERING REGULATIONS Intending purchasers will be asked to produce identification documentation at a later stage and we would ask for your co-operation in order that there is no delay in agreeing the sale. 2. These particulars do not constitute part or all of an offer or contract. 3. The measurements indicated are supplied for guidance only and as such must be considered incorrect. Potential buyers are advised to recheck measurements before committing to any expense. 4. We have not tested any apparatus, equipment, fixtures or services and it is in the buyers interest to check the working condition of any appliances. 5. Where an EPC, or a Home Report (Scotland only) is held for this property, it is available for inspection at the branch by appointment. If you require a printed version of a Home Report, you will need to pay a reasonable production charge reflecting printing and other costs. 6. We are not able to offer an opinion either written or verbal on the content of these reports and this must be obtained from your legal representative. 7. Whilst we take care in preparing these reports, a buyer should ensure that his/her legal representative confirms as soon as possible all matters relating to title including the extent and boundaries of the property and other important matters before exchange of contracts.

Allen & Harris is a trading name of Sequence (UK) Limited which is registered in England and Wales under company number 4268443, Registered Office is Cumbria House, 16-20 Hockliffe Street, Leighton Buzzard, Bedfordshire, LU7 1GN. VAT Registration Number is 500 2481 05.

allen & harris



01454 318387



ChippingSodbury@allenandharris.co.uk



7 High Street, Chipping Sodbury, BRISTOL,
Avon, BS37 6BA



allenandharris.co.uk