

Situated in sought-after Crescent Road and benefitting from no onward chain is this two bedroom ground floor apartment overlooking Crescent Gardens.

The Accommodation Comprises:

Front door to:

Communal Entrance Hall:

Secure coded door to:

Inner Hall:

Apartment front door to:

Entrance Hall: 7' 8" x 7' 8" (2.34m x 2.34m)

Coved ceiling, wall mounted electric heater, storage cupboard for coats and shoes, further storage cupboard housing hot water tank, door to:

Lounge/Diner: 20' 6" x 10' 11" (6.24m x 3.32m)

Coved ceiling, window with secondary glazing to front elevation, two wall mounted electric heaters, internal window/serving hatch to kitchen.

Bedroom One: 12' 7" x 10' 11" (3.83m x 3.32m)

Coved ceiling, window with secondary glazing to side elevation, wall mounted electric heater, a range of built-in wardrobes.

Bedroom Two: 10' 10" x 8' 10" (3.30m x 2.69m)

Coved ceiling, window with secondary glazing to side elevation, wall mounted electric heater, built-in wardrobe.

Bathroom: 6' 11" x 8' 10" (2.11m x 2.69m)

Coved ceiling, obscured window with secondary glazing to side, low level WC with concealed cistern, wash hand basin set in vanity unit with mixer tap, panelled bath with mixer tap and electric shower over, wall mounted electric heater, extractor fan, tiling to wall and floor.

Outside:

The apartment benefits from garage with up and over door in nearby block, well maintained communal front gardens and communal bins to rear.

Lease Information:

At the time of instruction, the vendor advised the following lease information (this information should be verified by your legal representative before exchange of contracts):

LEASE: Extended in 2009 until 2162 - 137 years remaining.

SERVICE CHARGE: £2,040 per annum.

General Information:

Construction: Traditional

Water Supply: Portsmouth Water

Electric Supply: TBC

Sewerage: Mains sewerage

For mobile & broadband coverage check:

<https://checker.ofcom.org.uk>

For flood risk check:

www.gov.uk/check-long-term-flood-risk



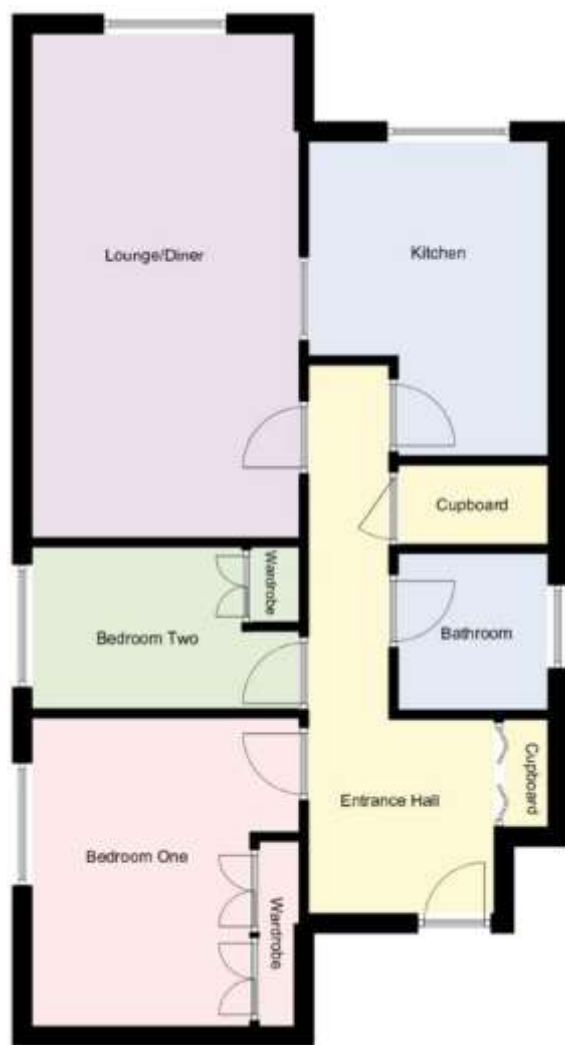

| Score | Energy rating | Current | Potential |
|-------|---------------|---------|-----------|
| 92+ | A | | |
| 81-91 | B | | |
| 69-80 | C | | 72 C |
| 55-68 | D | | |
| 39-54 | E | 52 E | |
| 21-38 | F | | |
| 1-20 | G | | |

Tenure: Leasehold

Council Tax Band: B

Disclaimer: These particulars are set out as a general outline in accordance with the Consumer Protection from Unfair Trading Regulations 2008 (CPR's) and Business Protection from Misleading Marketing Regulations 2008 (BPR's) only for the guidance of intending purchasers or lessees, and do not constitute any part of an offer or contract. Details are given without any responsibility, and any intending purchasers, lessees or third parties should not rely on them as statements or representations of fact, but must satisfy themselves by inspection or otherwise as to the correctness of each of them.

We have not carried out a structural survey and the services, appliances and specific fittings have not been tested. All photographs, measurements, floor plans and distances referred to are given as a guide only and should not be relied upon for the purchase of carpets or any other fixtures or fittings. Gardens, roof terraces, balconies and communal gardens as well as tenure and lease details cannot have their accuracy guaranteed for intending purchasers. Lease details, service ground rent (where applicable) are given as a guide only and should be checked and confirmed by your solicitor prior to exchange of contracts.

No person in the employment of Fenwicks Estates Ltd has any authority to make any representation or warranty whatever in relation to this property. Purchase prices, rents or other prices quoted are correct at the date of publication and, unless otherwise stated, exclusive of VAT.

Data Protection: We retain the copyright in all advertising material used to market this Property.

Money Laundering Regulations 2017: Intending purchasers will be required to produce identification documentation once an offer is accepted.



£214,995

Ambleside Court, Crescent Road, Alverstoke, PO12 2DJ

DRAFT DETAILS

Fenwicks - Gosport Office: 02392 529889 www.fenwicks-estates.co.uk

Fenwicks
THE INDEPENDENT ESTATE AGENT