



Theatre Street, SW11

£2,650 Per calendar month

This fantastic two double bedroom flat is on the ground floor and has direct access through french doors to a lovely communal garden. The kitchen is modern and there is plenty of storage.

You are just up the road from the station, and you have easy access to the pubs and restaurants on Lavender Hill, like The Four Thieves and Tumnam Thai.

Features

- Two Double Bedrooms
- Private Parking Space
- Communal Garden
- Separate Kitchen
- Great Transport Links
- Clapham Junction

Theatre Street,
London, SW11

Ground Floor

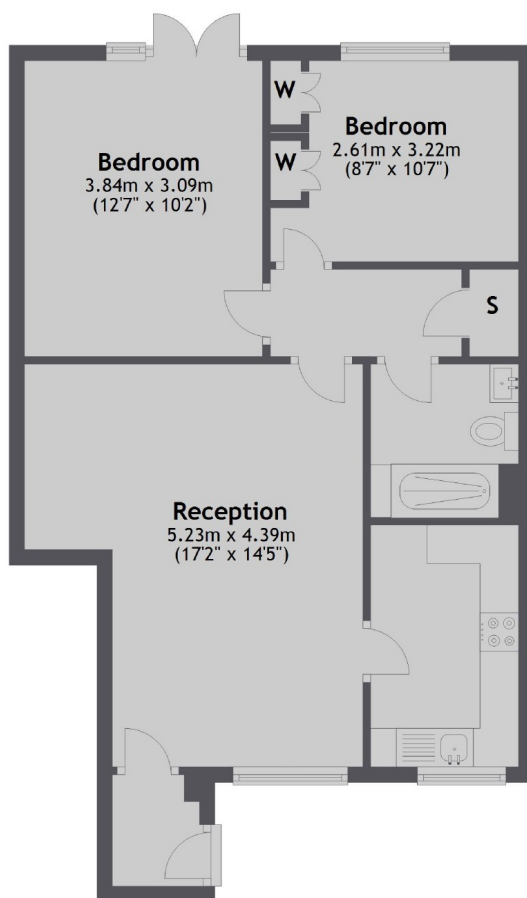

Total area: approx. 57.3 sq. metres (616.7 sq. feet)