

## Pollard Road, Birmingham, B27 7EN

Offers In Region Of £210,000

2 1 1



Situated on Pollard Road, B27, this well-presented family home offers thoughtfully arranged accommodation, ideal for modern day living.

## Key Features

- Well-presented family home
- Popular residential location on Pollard Road, B27
- Bright and comfortable living room with log burner fire
- Fitted kitchen with access to the rear garden
- Well-proportioned bedrooms
- Family bathroom with underfloor heating
- Accommodation arranged over two floors
- Private rear garden
- Close to local amenities and schools
- Convenient access to transport links

GROUND FLOOR  
438 sq.ft. (40.7 sq.m.) approx.

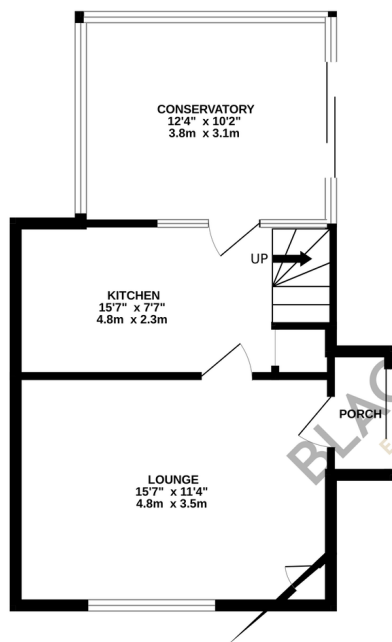

1ST FLOOR  
299 sq.ft. (27.8 sq.m.) approx.

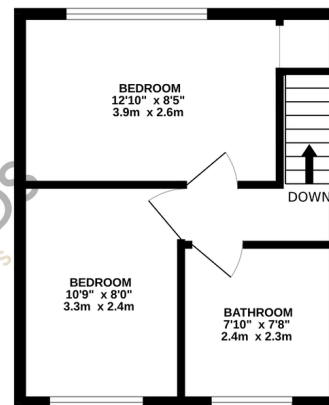

TOTAL FLOOR AREA: 738 sq.ft. (68.5 sq.m.) approx.

Whilst every attempt has been made to ensure the accuracy of the floorplan contained here, measurements of doors, windows, rooms and any other items are approximate and no responsibility is taken for any error, omission or mis-statement. This plan is for illustrative purposes only and should be used as such by any prospective purchaser. The services, systems and appliances shown have not been tested and no guarantee as to their operability or efficiency can be given.

Made with Metropix ©2026