



Bridge Meadow Way

Grange Park,

oriordanbond
SALES & LETTINGS



GROUND FLOOR
497 sq.ft. (46.2 sq.m.) approx.

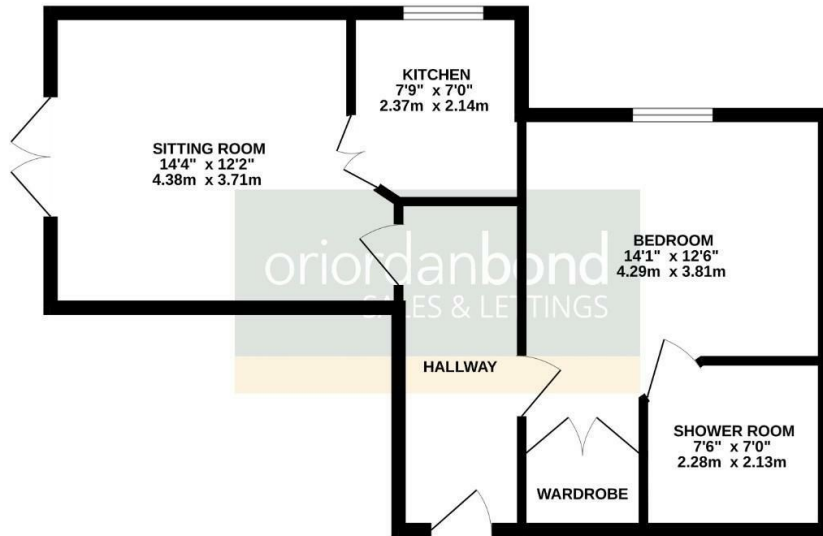

TOTAL FLOOR AREA : 497 sq.ft. (46.2 sq.m.) approx.
Whilst every attempt has been made to ensure the accuracy of the floorplan contained here, measurements of doors, windows, rooms and any other items are approximate and no responsibility is taken for any error, omission or mis-statement. This plan is for illustrative purposes only and should be used as such by any prospective purchaser. The services, systems and appliances shown have not been tested and no guarantee as to their operability or efficiency can be given.
Made with Metreplex G2026

Bridge Meadow Way

Grange Park

NN4 5EB

PRICE £195,000

This wonderfully presented spacious one double bedroom top floor retirement apartment is offered for sale in the desirable Richmond Village within Grange Park with the added benefit of assisted living.

Offered for sale with no onward chain, the accommodation on one level comprises entrance hall, sitting room with French doors opening to a Juliette balcony, fitted kitchen, double bedroom and walk-in shower room with soak away floor. Benefits include double glazing, heating via a community scheme and access to community activities. (B/497/balc)

Leasehold Information: Lease Remaining - 105 years (as of 2026) / Ground Rent - £250 per annum / Service Charge = £182.11 per week

Additional information

- Council Tax Band: C
- Energy Efficiency Rating: C

Viewing

Viewing strictly by appointment – details below

Disclaimer

O'Riordan Bond Estate Agents Limited has not tested apparatus, equipment, fittings or services and so cannot verify they are in working order. The buyer is advised to obtain verification from their solicitor or surveyor.

O'Riordan Bond Grange Park Sales
01604 432007

grangepark@oriordanbond.co.uk

