



RE/MAX

PROPERTY HUB



18 Woodmere Way, Newton Abbot, TQ12 3SW

Guide price £220,000

GUIDE PRICE £220,000 - £230,000.

Situated in a peaceful cul-de-sac on the popular Woodmere Way in Kingsteignton, this well-presented two double bedroom terraced home offers an excellent opportunity for first-time buyers or those looking to step onto the property ladder.

The ground floor comprises a welcoming entrance hallway leading to a bright and spacious living room with a large front-facing window and contemporary electric fireplace. An open archway flows through to the modern, recently refitted kitchen/diner, which overlooks the rear garden and offers ample storage, space for appliances, and direct garden access – perfect for everyday living and entertaining.

Upstairs, the property features two generous double bedrooms. The principal bedroom benefits from built-in wardrobe space, while the second bedroom enjoys a pleasant outlook over the rear garden and neighbouring woodland. A modern family bathroom completes the first floor.

Externally, the home boasts an attractive front garden with pathway and flowerbeds, along with an outhouse for additional storage. To the rear, the landscaped garden has been thoughtfully designed for low maintenance,

Floor Plan

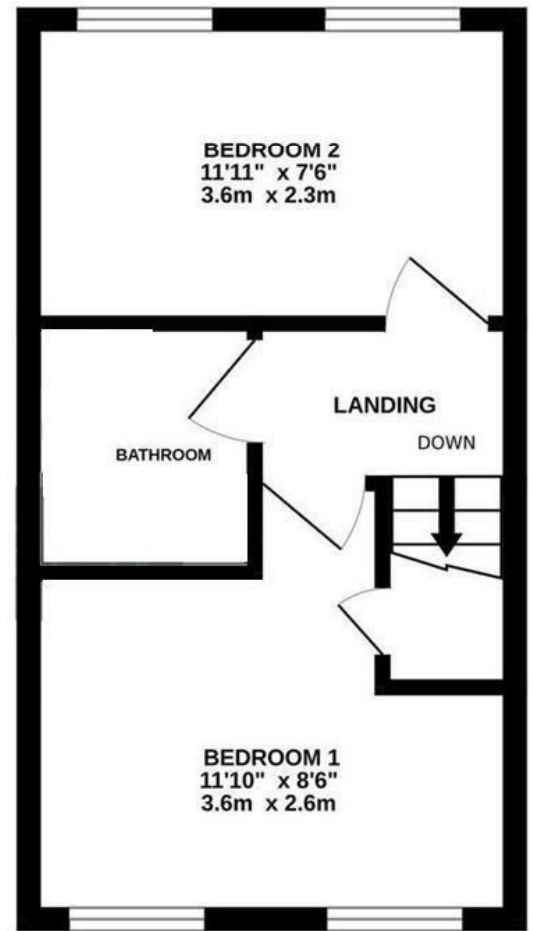
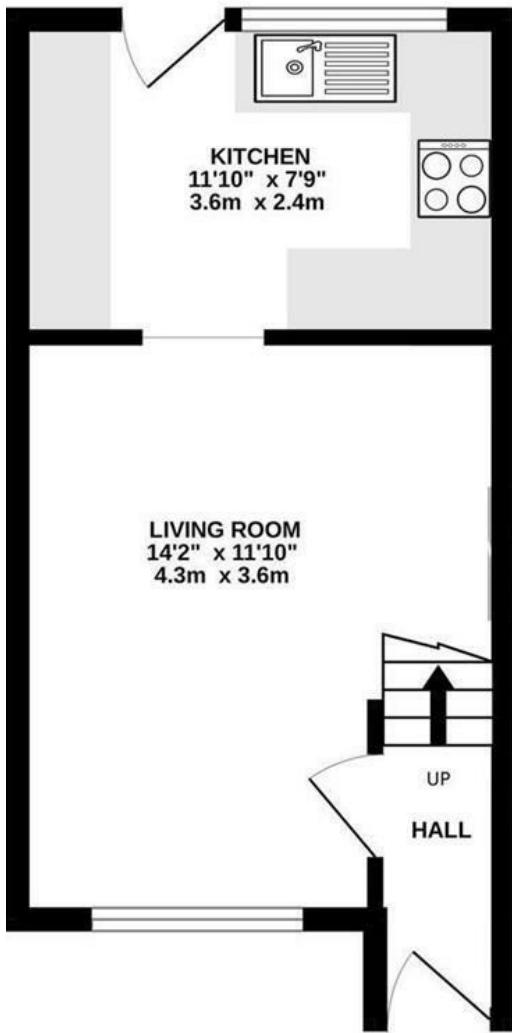

Area Map

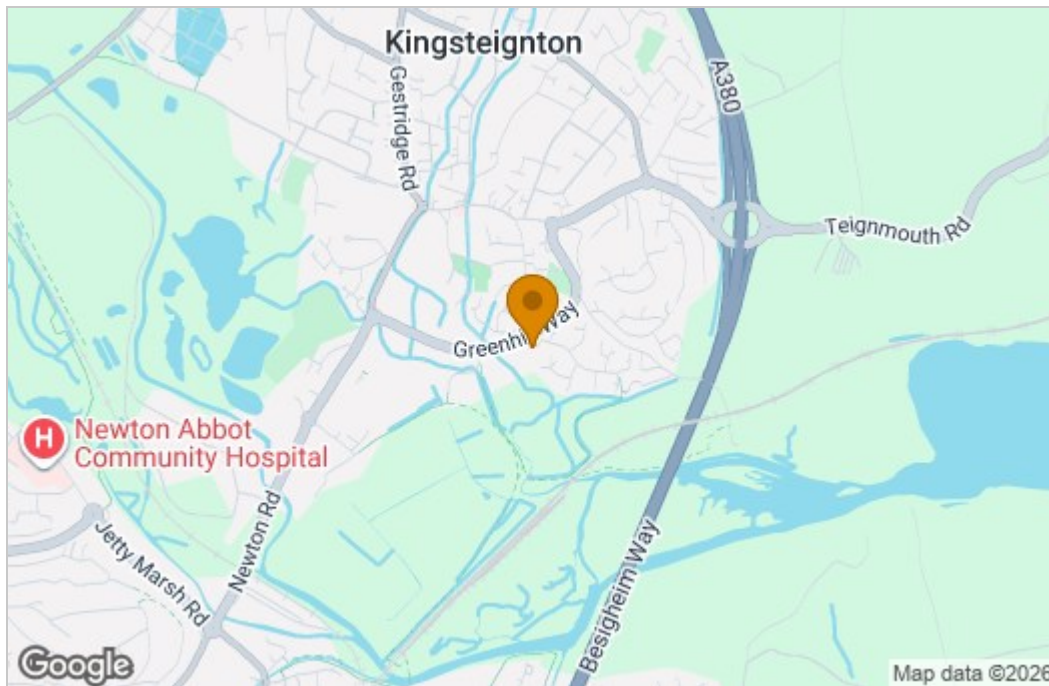

Energy Efficiency Graph

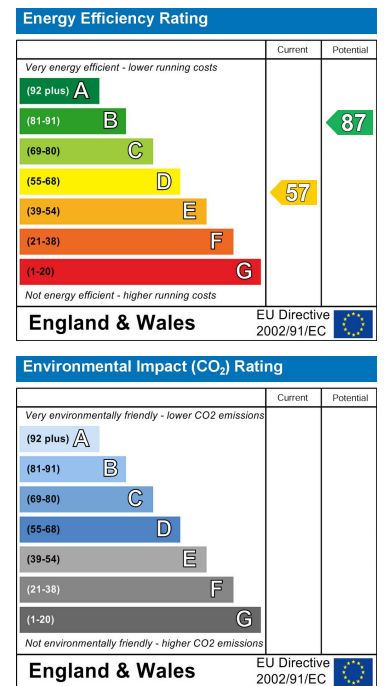

These particulars, whilst believed to be accurate are set out as a general outline only for guidance and do not constitute any part of an offer or contract. Intending purchasers should not rely on them as statements of representation of fact, but must satisfy themselves by inspection or otherwise as to their accuracy. No person in this firm's employment has the authority to make or give any representation or warranty in respect of the property.

2 Reynell Road, Newton Abbot, Devon, TQ12 6YA

Tel: 07850 038794 Email: ryan.flory@remax.uk <https://remax.uk/associates/Ryan%20Flory>