

Harper & Co

Estate Agents Ltd

<https://www.harperandcoestateagents.co.uk>



Hepple Close

High Grange, Billingham, TS23 3XP

Detached Four Bedroom Family Home | South Facing Garden | Quiet Cul-De-Sac Location

Situated Within The Highly Sought After High Grange Area Of Billingham, This Well Presented Detached Family Home Occupies A Pleasant Position Within A Quiet Cul-De-Sac Benefiting From No Through Traffic, Making It Ideal For Families Seeking Privacy And Convenience.

£250,000

Hepple Close

High Grange, Billingham, TS23 3XP



- Detached Four Bedroom Family Home In Sought After High Grange Location
- Separate Dining Room Ideal For Family Living And Entertaining
- Family Bathroom Serving The Remaining Bedrooms
- Close To Reputable Schools, Amenities And Major Road Links
- Positioned Within A Quiet Cul-De-Sac With No Through Traffic
- Kitchen Offering Practical Workspace And Storage
- Private South Facing Rear Garden Enjoying Excellent Privacy
- Spacious Lounge Featuring A Log Burning Stove
- Four Well Appointed Bedrooms Including En Suite To One
- Block Paved Gated Driveway And Detached Garage

Full Description

Location

Note

Disclaimer

Money Laundering Notice



Directions



Floor Plan

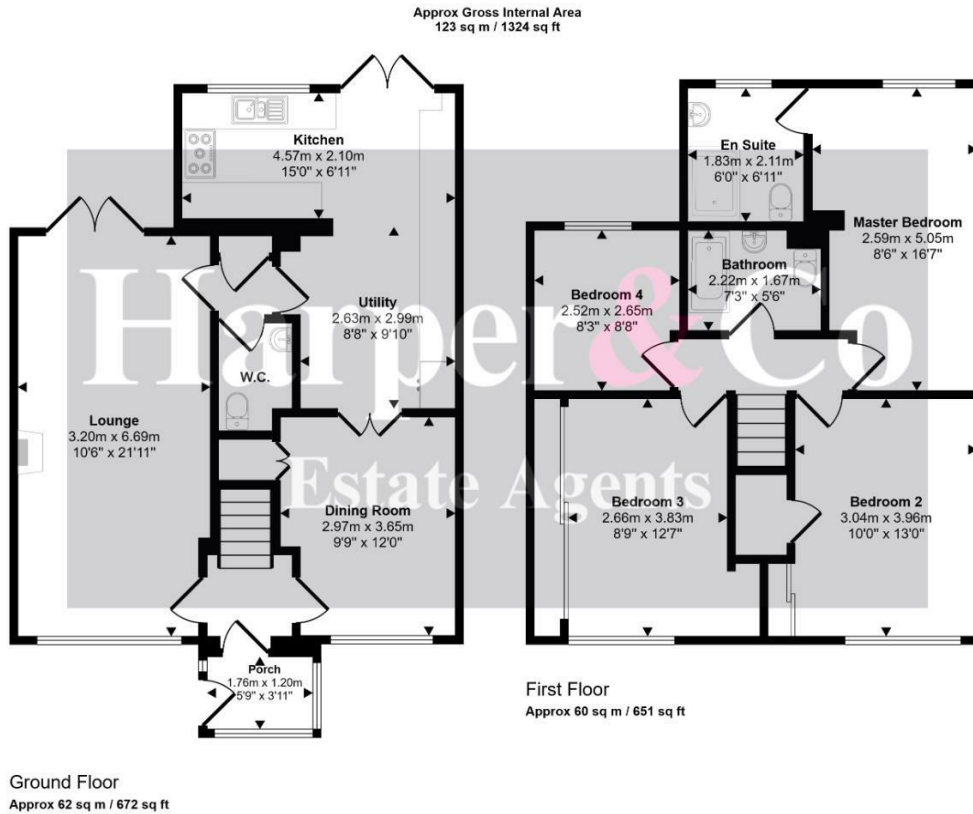

This floorplan is only for illustrative purposes and is not to scale. Measurements of rooms, doors, windows, and any items are approximate and no responsibility is taken for any error, omission or mis-statement. Icons of items such as bathroom suites are representations only and may not look like the real items. Made with Made Snappy 360.

These particulars, whilst believed to be accurate are set out as a general outline only for guidance and do not constitute any part of an offer or contract. Intending purchasers should not rely on them as statements of representation of fact, but must satisfy themselves by inspection or otherwise as to their accuracy. No person in this firm's employment has the authority to make or give any representation or warranty in respect of the property.

