



13 St. Vincent Road, Southsea

£270,000

 chinneckshaw



13 St. Vincent Road

Southsea, Southsea

Enter this beautifully presented two-bedroom mid-terraced house, where contemporary style meets everyday practicality. A bright open-plan living and dining room provides generous space for relaxing and entertaining, while understairs storage keeps essentials neatly tucked away. The modern kitchen features sleek cabinetry, integrated appliances, ample workspace, and room for a breakfast table. Outside, a charming low-maintenance garden creates an inviting space to unwind or host guests. Both bedrooms include built-in storage, helping maximise space and maintain a clutter-free feel, while large windows bring in plenty of natural light. The stylish bathroom offers both a full-size bath and a walk-in shower, finished with contemporary fittings and elegant tiling for comfort and convenience. Ideal for first-time buyers, professionals, or small families, this home offers flexible living space suited to home working, hobbies, or guests. Just a short walk from independent shops and cafes, it also benefits from excellent transport links and permit parking. Blending style, functionality, and convenience, this is a home well suited to modern living.

Material Information • Tenure: Freehold • Council Tax: Band B • Electricity: Mains Supply • Heating: Gas • Water Supply: Mains Supply • Sewage: Mains Supply • Broadband: Standard, Superfast and Ultrafast Fibre are all available in this area • Parking: Permit • Mobile: Ofcom official website checker states that EE, Vodafone, O2 and Three available in the area • Flood Risk: Low Risk





Ground Floor

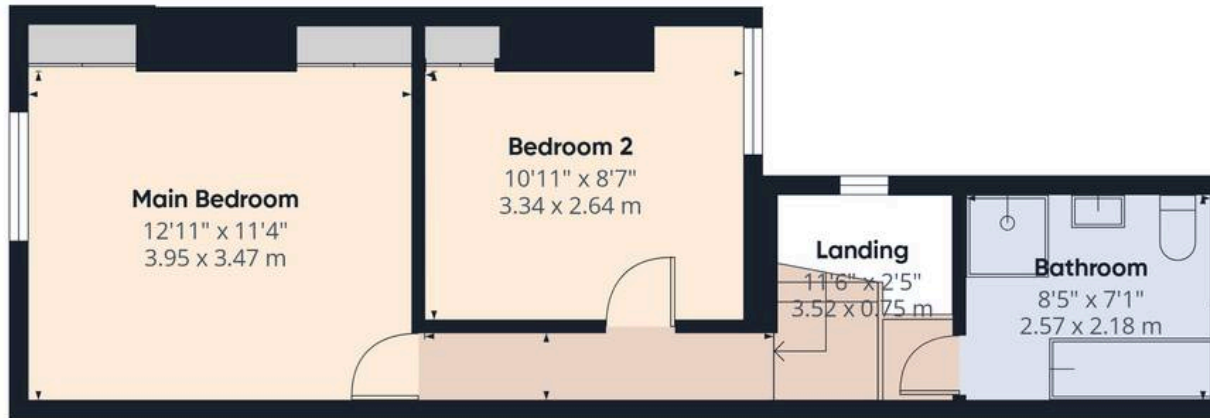

Floor 1



Approximate total area⁽¹⁾

847 ft²

78.7 m²

Reduced headroom

2 ft²

0.2 m²

(1) Excluding balconies and terraces

Reduced headroom

----- Below 5 ft/1.5 m

Calculations reference the RICS IPMS 3C standard. Measurements are approximate and not to scale. This floor plan is intended for illustration only.

GIRAFFE360



Chinneck Shaw

Bridge House, Milton Road, Portsmouth – PO3 6AN

023 9282 6731

hello@chinneckshaw.co.uk

www.chinneckshaw.co.uk/

Chinneck Shaw, Bridge House, Milton Road, PO3 6AN Consumer Protection from Unfair Trading Regulations 2008: These details are for guidance only and complete accuracy cannot be guaranteed. If there is any point which is of particular importance, verification should be obtained. They do not constitute a contract or part of a contract. All measurements are approximate. No guarantee can be given with regard to planning permissions or fitness for purpose. No apparatus, equipment, fixture or fitting has been tested. Items shown in the photographs are NOT necessarily included. Interested Parties are advised to check availability and make an appointment to view before travelling to see a property.