



Addison

ESTATE AGENTS



50 Barnes Close, Sarisbury Green, Southampton, Hampshire,
£380,000 Freehold

Situated within a quiet residential cul-de-sac on the edge of the beautiful Holly Hill Woodland Park, this beautifully presented three-bedroom end-terrace home has been thoughtfully extended and comprehensively modernised, creating a superb home ready to move straight into. Offered for sale with no forward chain, the property is ideal for families, professionals and those looking for a peaceful yet convenient location.

The accommodation begins with a welcoming entrance hall leading to a comfortable sitting room, where a recently installed log burner (June 2025) creates a warm and inviting focal point. The heart of the home is the impressive refitted kitchen, which opens into a stunning recently constructed dining room extension. Flooded with natural light, this fantastic space is perfectly suited to modern family living and entertaining. A useful utility room and ground floor shower room complete the ground floor accommodation.

Upstairs are three well-proportioned bedrooms, served by a stylish newly fitted family bathroom, installed in May 2025.

The property has been significantly enhanced by the current owner, including a substantial rear extension, an earlier side extension completed approximately 12 years ago, a contemporary fitted kitchen, replacement bathroom, new flooring throughout much of the home and a recently installed pressurised hot water system (June 2025). In addition, planning permission has been granted to extend the first floor, offering buyers the opportunity to create even larger bedroom accommodation if desired.

Outside, there is driveway parking to the front, an enclosed rear garden and a detached external store providing excellent additional storage.

Barnes Close enjoys an enviable location within easy reach of local shops and amenities, while being on the doorstep of Holly Hill Woodland Park. The property also falls within the catchment area for the highly regarded Sarisbury Infant School and Sarisbury Church of England Junior School.



Energy Efficiency Rating		
	Current	Potential
Very energy efficient - lower running costs		
(92 plus) A		
(81-91) B		
(69-80) C	74	78
(55-68) D		
(39-54) E		
(21-38) F		
(1-20) G		
Not energy efficient - higher running costs		
England & Wales	EU Directive 2002/91/EC	

Further Information

Local Council:

Council Tax Band:

B

Amount Payable for 2025/2026:

Add Text here

Estate Management Charge:

TBC



APPROXIMATE GROSS INTERNAL AREA = 1051 SQ FT / 97.7 SQ M
STORE = 54 SQ FT / 5.0 SQ M
TOTAL = 1105 SQ FT / 102.7 SQ M

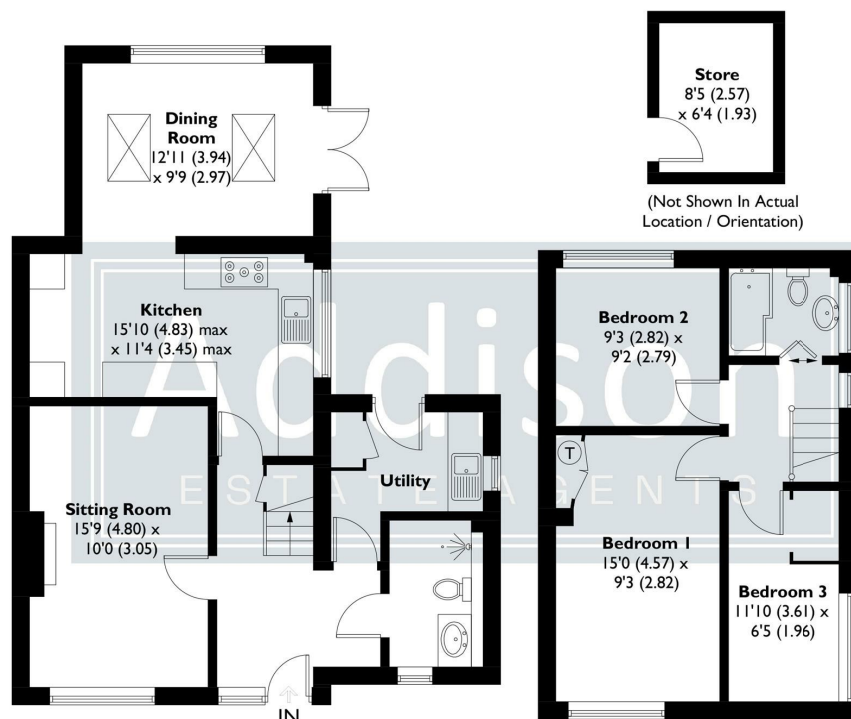

GROUND FLOOR
665 SQ FT / 61.8 SQ M

FIRST FLOOR
386 SQ FT / 35.9 SQ M

- Beautifully presented three-bedroom end-terrace home
 - No forward chain
- Stunning recently constructed rear dining room extension
 - Refitted contemporary kitchen
- Newly fitted family bathroom and ground floor shower room
 - Utility room and spacious, well-planned accommodation
- Driveway parking and detached external store
- Planning permission granted to extend the first floor
- Situated on the edge of Holly Hill Woodland Park
 - Catchment for Sarisbury Infant School and Sarisbury Church of England Junior School

This plan is for layout guidance only. Not drawn to scale unless stated. Windows and door openings are approximate. Whilst every care is taken in the preparation of this plan, please check all dimensions, shapes and compass bearings before making any decisions reliant upon them. Created by Emzo Marketing (ID1317240)
Produced for Addison Estate Agents



Addison
ESTATE AGENTS

If you proceed to purchase the property, in accordance with current Anti-Money Laundering Regulations (AML), we are required to verify the identity of all clients purchasing a property. We use an online service to verify identity. A fee of £10 + VAT (£12 including VAT) per individual will be charged for these AML searches.



01489 668 999



sales@addisonestateagents.co.uk



www.addisonestateagents.co.uk