



## 9 Bolwell Place

Melksham, SN12 7FB

### Guide Price £110,000

Welcome to 9 Bolwell Place, a one bedroom, top (second) floor apartment situated near the centre of Melksham.

The accommodation comprises entrance hall with a storage cupboard, an open plan living space with kitchen area including oven, gas hob and integrated appliance spaces, a double bedroom with fitted wardrobes and bathroom.

The property further benefits from gas central heating, double glazing and parking for one car.

The property is leasehold. The owners advise that the lease was granted in January 2007 and there is 107 years remaining. The owners also advise that the car parking space is owned under freehold.

All room measurements are approx;  
Open plan living space: 5.38m x 2.99m ext 3.60m  
Bedroom: 3.2m x 2.7m  
Bathroom: 1.62m x 2.39m

#### Viewing

Please contact our Blueleaf Property Office on 01225 839050 if you wish to arrange a viewing appointment for this property or require further information.

- One bedroom top floor apartment
- Parking for one car
- No onward chain
- Central location in Melksham

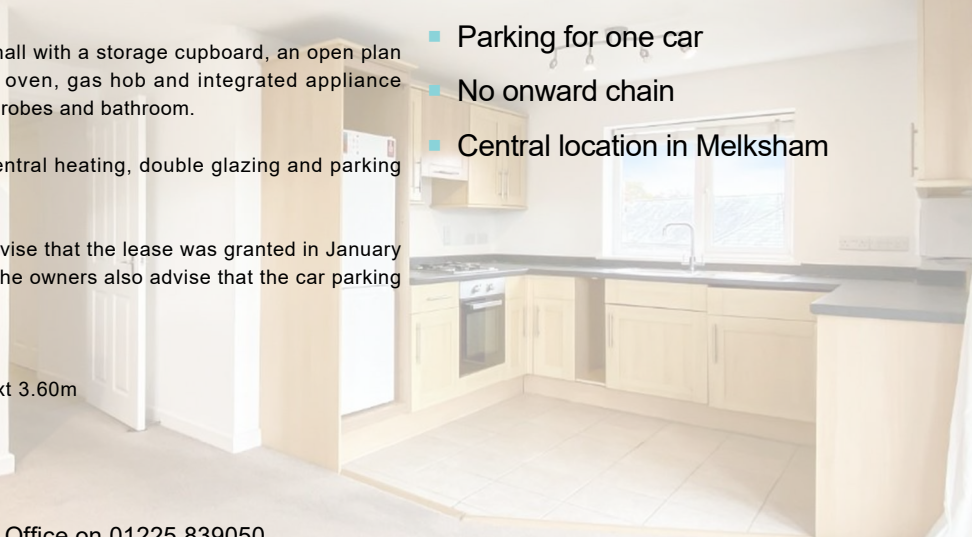



Floor Plan

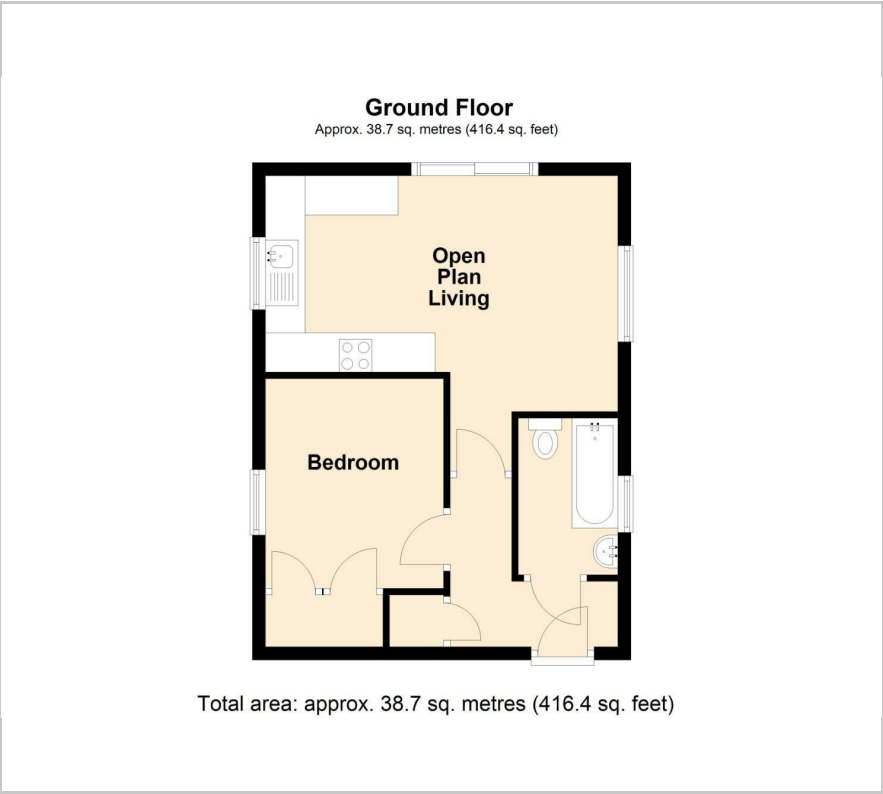

Area Map



Energy Efficiency Graph

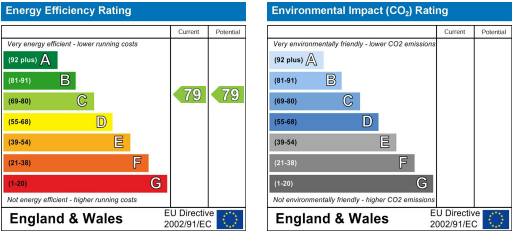

These particulars, whilst believed to be accurate are set out as a general outline only for guidance and do not constitute any part of an offer or contract. Intending purchasers should not rely on them as statements of representation of fact, but must satisfy themselves by inspection or otherwise as to their accuracy. No person in this firms employment has the authority to make or give any representation or warranty in respect of the property.