



Lavington

24 Greville Place, NW6

Asking Price £699,950

Sole Agent. Set within a sought-after modern development is this bright and well-presented two-bedroom, two-bathroom apartment offering 785 sq. ft. of stylish and comfortable living space.

The property features a spacious reception room filled with natural light, providing an ideal setting for both relaxing and entertaining. The contemporary layout flows seamlessly into a well-appointed kitchen, designed with practicality and modern living in mind.

Both bedrooms are generously proportioned, with the principal bedroom benefiting from a sleek en suite bathroom, while the second bedroom is served by a separate, well-finished family shower room.

Lavington is ideally positioned close to the vibrant selection of shops, cafés, and restaurants along Boundary Road, offering excellent convenience for everyday living.

CHESTERTONS



Lavington

24 Greville Place, NW6

- 2 Bedrooms 2 Bathrooms
- Long Leasehold
- 785 sq. ft.
- Balcony
- Quiet Location



Tenure: Leasehold
Service Charge: £2,629pa
Ground Rent: £0
Local Authority: Westminster
Council Tax Band: F

Score	Energy rating	Current	Potential
92+	A		
81-91	B		
69-80	C	80 C	53 B
55-68	D		
39-54	E		
21-38	F		
1-20	G		

Chestertons St John's Wood Sales

105 St. John's Wood Terrace
London
NW8 6PL
stjohnswood@chestertons.co.uk
020 3040 8611
chestertons.co.uk

Lavington,
Greville Place, NW6



○ - Ceiling Height

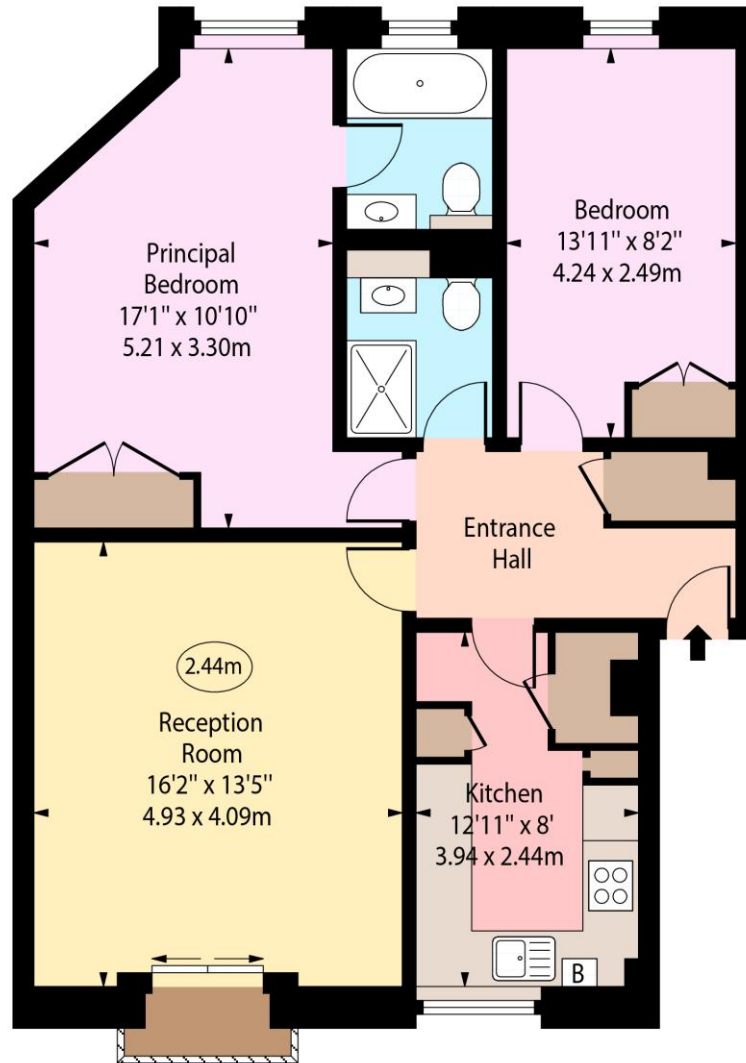

First Floor

Approx Gross Internal Area 785 Sq Ft - 72.93 Sq M

Every attempt has been made to ensure the accuracy of the floor plan shown. However, all measurements, fixtures, fittings, and data shown are approximate interpretations and for illustrative purposes only. Measured according to the RICS. Not To Scale.

www.goldlens.co.uk
Produced for Chestertons
Ref. No. 031591K