

Horton & Senate



14 Wilsons Road, Knowle, Solihull, B93 0HZ

£1,200

- Mid Terrace Property
- South Facing Rear Garden
- Secondary Glazing
- Unfurnished
- 2 Double Bedrooms
- Refitted Kitchen/Diner
- Refitted Bathroom
- Fully Refurbished
- Gas Central Heating
- Available August

49a Station Road, Knowle, Solihull, West Midlands, B93 0HN
01564 773200

info@senateproperty.co.uk

14 Wilsons Road, Solihull B93 0HZ

Horton & Senate are pleased to offer this fully refurbished two double bedroom mid terrace property with pleasant South facing rear garden. Located within walking distance of Knowle High Street with all local amenities close by. Benefiting from secondary glazing, gas central heating and comprising of lounge with feature fireplace and staircase to first floor, refitted kitchen/diner with integrated appliances and access to rear garden, two double bedrooms and refitted bathroom with shower over bath to first floor and pleasant South facing rear garden with multiple patio areas. Available August

2 1 1 D

Council Tax Band: C

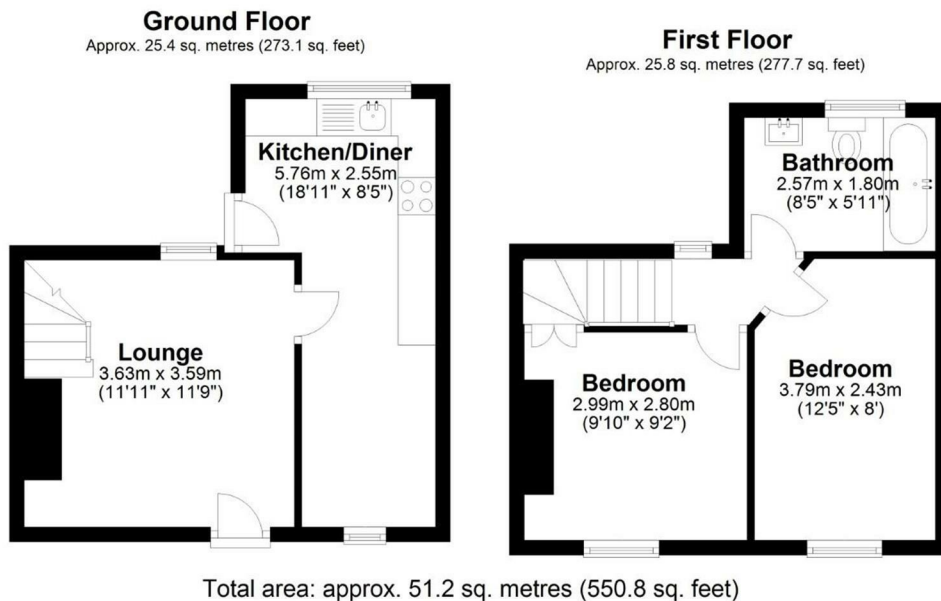







Ground Floor

Approx. 25.4 sq. metres (273.1 sq. feet)

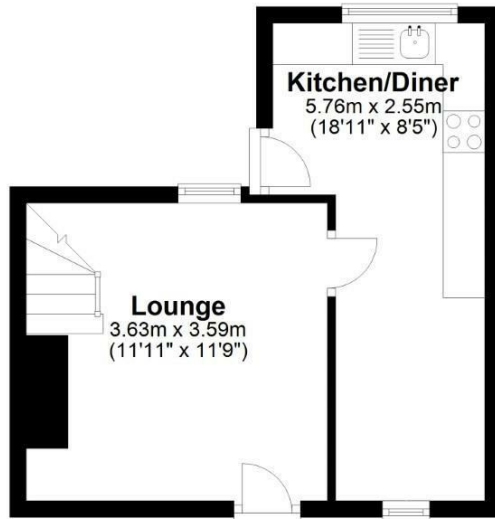

First Floor

Approx. 25.8 sq. metres (277.7 sq. feet)



Total area: approx. 51.2 sq. metres (550.8 sq. feet)

This floor plan is not to scale and is for illustration/marketing purposes of Senate Property Services Ltd.
Plan produced using PlanUp.

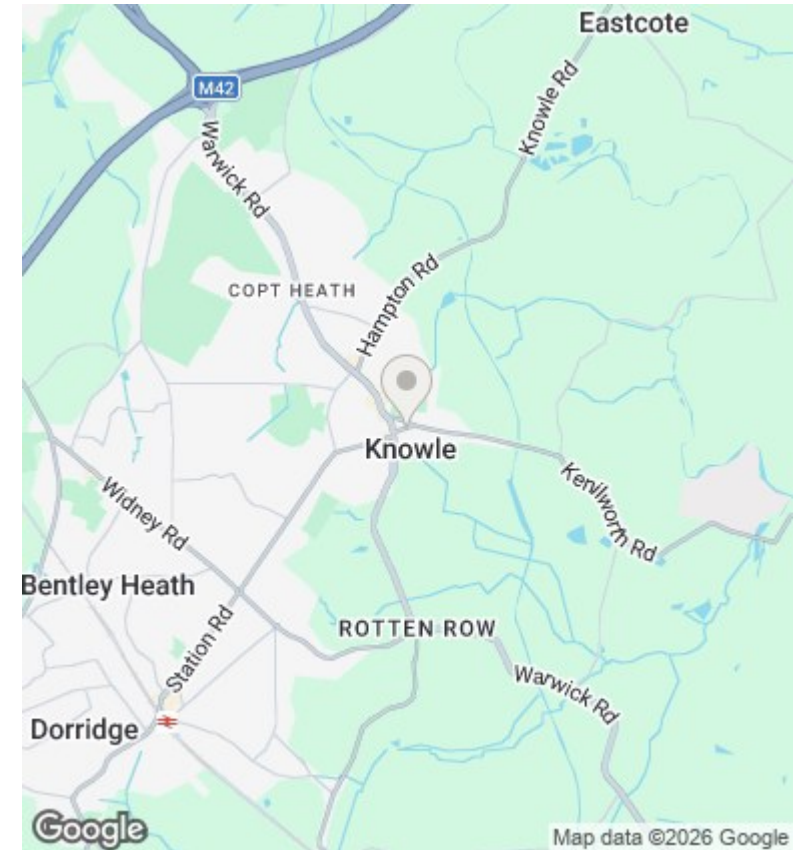

Directions

Viewings

Viewings by arrangement only. Call 01564 773200 to make an appointment.

Council Tax Band

B

Energy Efficiency Rating		
	Current	Potential
Very energy efficient - lower running costs		
(92 plus) A		
(81-91) B		88
(69-80) C		
(55-68) D	66	
(39-54) E		
(21-38) F		
(1-20) G		
Not energy efficient - higher running costs		
England & Wales	EU Directive 2002/91/EC	