

**ALLDAY
& MILLER**



Laurina Apartments, 10 Carnation Gardens, Hayes, UB3 4FS
£415,000

 2  2  1  B



Laurina Apartments, 10 Carnation Gardens, Hayes, UB3 4FS

£415,000

- Largest Two Bed In The Development
- Master Bedroom With Ensuite
- Over 900 Years Lease
- Two Additional Storage Rooms
- Resident-Only Gym Access
- Allocated Parking Slot
- Lift Access & Video Entry System
- Over 900 Sq Ft
- Five Minutes Walk To Elizabeth Line
- Chain Free

Description

This delightful property spanning an impressive 963 square feet, is an ideal opportunity for first-time buyers seeking a well-presented home in good condition throughout.

As you enter, you are greeted by a bright and airy reception and dining room, which seamlessly integrates with a modern fitted kitchen. This inviting space not only offers a perfect setting for entertaining but also provides access to the balcony.

The property boasts two spacious bedrooms, with the master bedroom featuring an en-suite bathroom for added convenience and privacy. A second bathroom serves the other bedroom and completes this home.

Situation

Laurina Apartments, Carnation Gardens situated in the heart of Hayes just moments from Hayes & Harlington station with the Elizabeth line giving easy links to central London and the surrounding areas. There are several bus routes to local amenities including Brunel University, Heathrow Airport, Uxbridge town centre, Hounslow and Southall. Hayes town is within walking distance with its variety of local shops, cafes, coffee shops, takeaways and restaurants. The area is also served by highly regarded schools including Harlington secondary school and Pinkwell primary school.



Floor Plans

Carnation Gardens, Hayes, UB3

Approximate Area = 963 sq ft / 89.5 sq m
For identification only - Not to scale

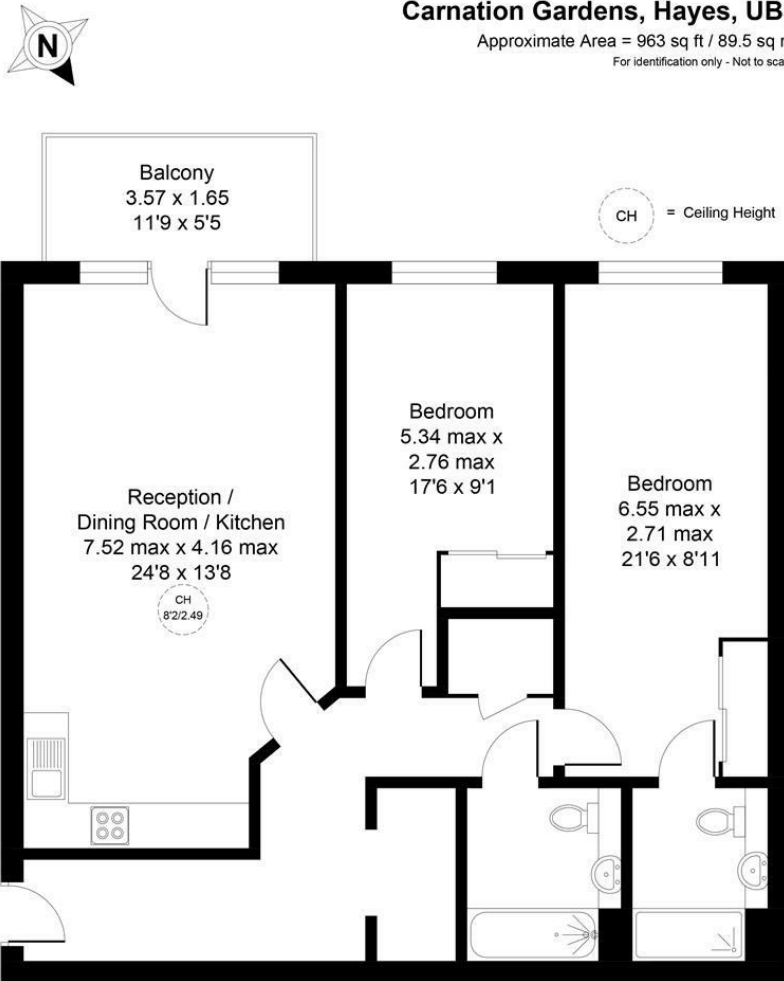

First Floor

Floor plan produced in accordance with RICS Property Measurement Standards incorporating International Property Measurement Standards (IPMS2 Residential). ©Vizion Property Marketing 2026. Produced for Allday & Miller.

ALLDAY & MILLER
estate agents

Area Map

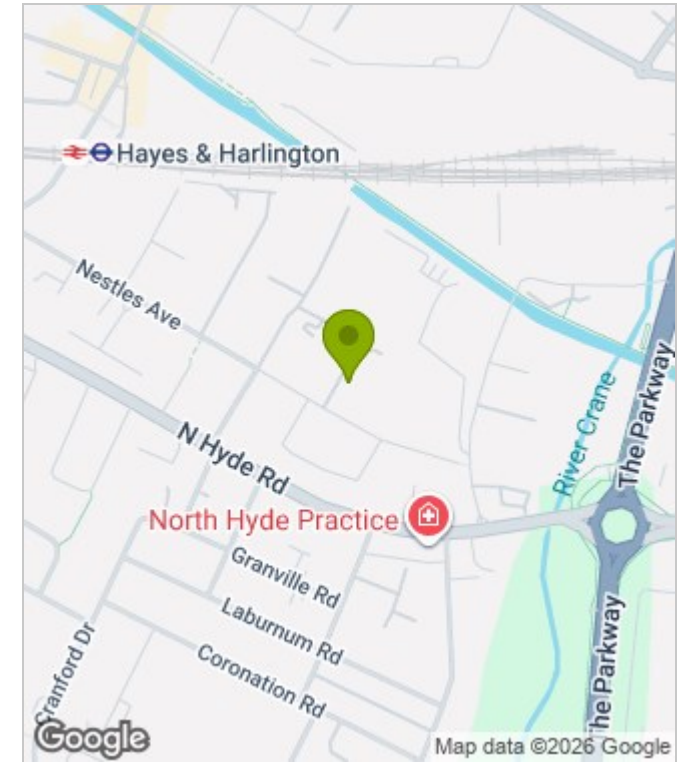

Energy Performance Graph

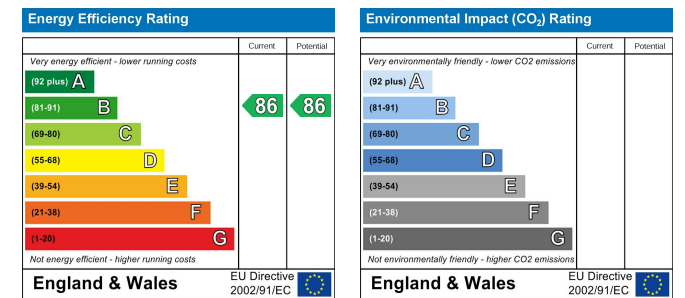

These particulars, whilst believed to be accurate are set out as a general outline only for guidance and do not constitute any part of an offer or contract. Intending purchasers should not rely on them as statements of representation of fact, but must satisfy themselves by inspection or otherwise as to their accuracy. No person in this firm's employment has the authority to make or give any representation or warranty in respect of the property.