



enfields

Enfields Estate
21 High Street
Enfield, Middlesex
EN1 1JH
020 8996 1111
enfields@enfields.co.uk

Harcourt Road, Southampton, SO18 1GN

Guide Price £350,000

3 1 2



- Three-bedroom semi-detached home
- Driveway and garage providing off-road parking for multiple vehicles
- Conservatory adding additional living space
- Large windows providing excellent natural light
- Requires full refurbishment – strong value-add opportunity
- Quiet residential location
- Rear garden
- Spacious lounge and separate dining room with fireplace
- Separate kitchen
- Potential for extension or loft conversion (STPP)



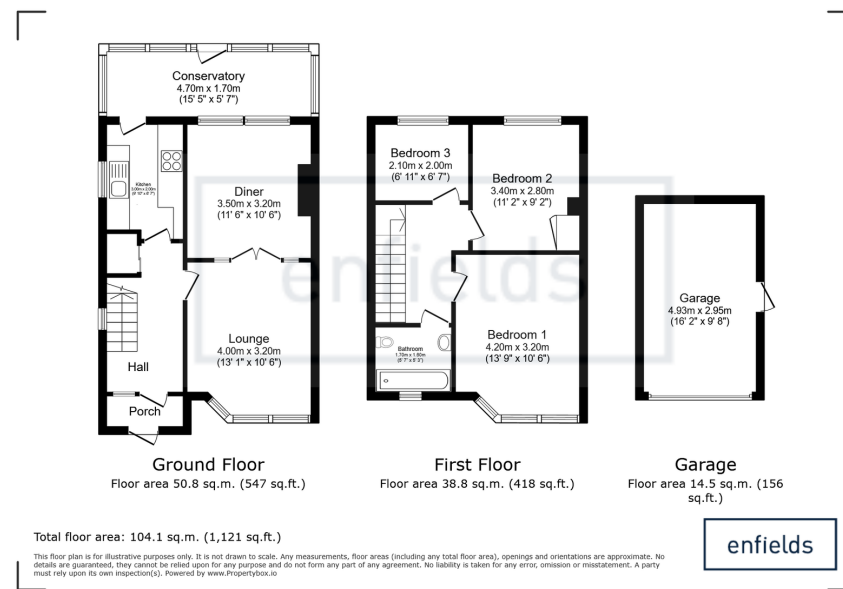

A spacious three-bedroom semi-detached home on a quiet residential road, offering excellent potential for modernisation. Featuring a conservatory, generous living space, and off-road parking, this property is ideal for families or investors alike.

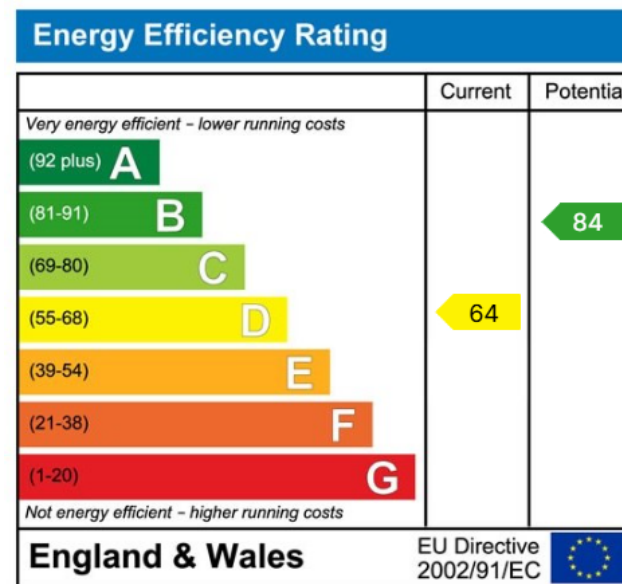

www.enfields-southampton.co.uk



It is Enfields policy to respect any sole agency currently in force and we would not be able to commence marketing until this has expired or been terminated. If you fail to terminate any previous agreement you could be liable for two sets of fees. Enfields Hythe is a trading name of YTF LTD Registered office: 345 Shirley Road, Southampton, Hampshire, England, SO15 3JD. Company Registration No: 10459987. VAT Registration No: 281 2975 81.

Enfields Lettings - Embley Management LTD T/A Enfields. Registered Address: 345 Shirley Road, Southampton, Hampshire, England, SO15 3JD. Company Registration No: 14847604. VAT Registration No: 439 8546 45.