



Walcot Square

London, SE11

2,200 £ per month
(507.69 £ per week)

An unfurnished one bedroom, split level flat arranged over two floors and situated in this beautiful conservation area. The property spans just under 500 Sq. ft and comprises, living room, separate kitchen, bedroom, bathroom and small patio area.

CHESTERTONS



Walcot Square

London, SE11

- One Bedroom
- Split level
- Unfurnished
- Conservation Area
- Close to Elephant & Castle station



An unfurnished one bedroom, split level flat arranged over two floors and situated in the beautiful Walcot Square conservation area. The property spans just under 500 Sq. ft and comprises, living room, separate kitchen, bedroom, bathroom and small patio area.

Conveniently situated for many local cafes and Elephant & Castle Underground station and the variety of eateries of Elephant Park.

Minimum Term: 12 months
Deposit Required: 0.00 £
Local Authority: London Borough Of Lambeth
Council Tax Band:
EPC Rating: To be confirmed
Unfurnished

Chestertons Tower Bridge Lettings

220 Tower Bridge Road
Tower Bridge
London
SE1 2UP
towerbridgelettingsusers@chestertons.co.uk
02073576911
chestertons.co.uk

Additional tenant charges apply (fees apply to non-AST tenancies only)
Tenancy Agreement Fee: £300
References per Tenant/Guarantor: £60
Inventory check (approx. £100 – £250 inc. VAT)
[chestertons.co.uk/property-to-rent/applicable-fees](https://www.chestertons.co.uk/property-to-rent/applicable-fees)

Walcot Square, SE11

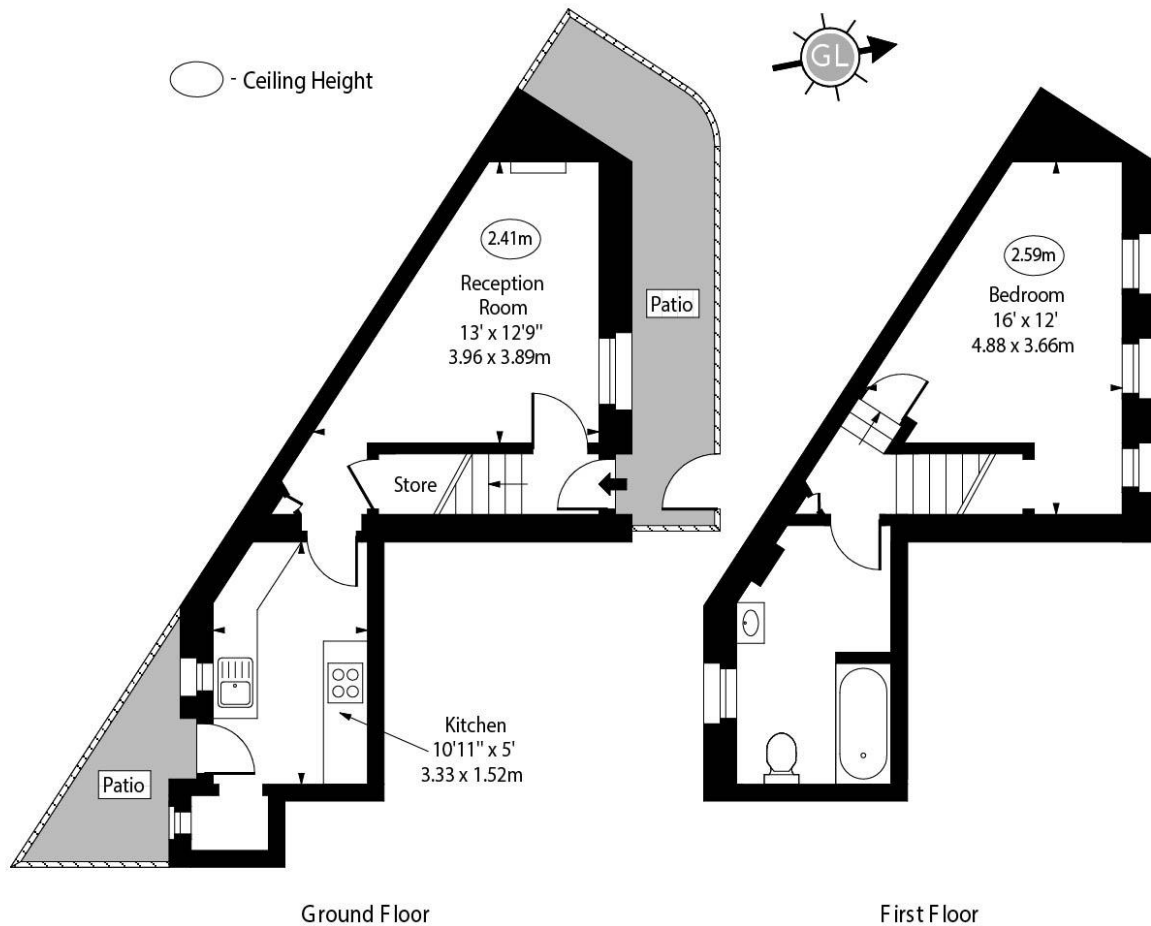

Approx Gross Internal Area 496 Sq Ft - 46.08 Sq M

Every attempt has been made to ensure the accuracy of the floor plan shown. However, all measurements, fixtures, fittings, and data shown are approximate interpretations and for illustrative purposes only. Measured according to the RICS. Not To Scale.

www.goldlens.co.uk
Ref. No. 030200K

