



Fairford Crescent, Downhead Park, Milton Keynes, MK15

Milton Keynes

£170,000

exp UK

Bedrooms: | Bathrooms: | Receptions:
3 | 1 | 2

Council Tax Band: C

Tenure: Leasehold

Property Type: Semi Detached House

- 50% Shared Ownership Opportunity
- Three Bedroom Semi Detached Home
- Spacious Living Room
- Modern Fitted Kitchen
- Family Bathroom
- Private Rear Garden
- Driveway Parking
- Detached Garden Office Ideal for Working From Home
- Premiums Welcome With Offers
- EG1332



ETHAN GAULTER

exp

EG1332

50% Shared Ownership Semi Detached Home | Downhead Park, Milton Keynes

PREMIUMS ARE WELCOME WITH OFFERS

Offered to the market on a 50% shared ownership basis, this well presented three bedroom semi detached home in the ever popular Downhead Park presents a fantastic and affordable opportunity to step onto the property ladder.

The ground floor features a spacious and naturally bright living room, ideal for relaxing or entertaining, leading through to a modern fitted kitchen with ample storage, worktop space and room for casual dining.

Upstairs, you will find three bedrooms, including a generous main bedroom, a well sized second bedroom and a versatile third room perfect as a nursery, home office or dressing space. A family bathroom completes the first floor.

Externally, the property benefits from a private rear garden and driveway parking. A real standout feature is the detached garden office, providing a fantastic additional space for working from home, a gym or hobby room.

Located in Downhead Park, the home offers excellent access to local amenities, schooling and transport links, as well as Milton Keynes city centre.

This is a brilliant opportunity for first time buyers or anyone looking for a cost effective move into a well established and sought after area.

By appointment only – secure your place on the open day today.

Photo Disclaimer:

Please note that some images have been digitally enhanced and may include virtual staging, edited finishes, or improvements such as changes to furniture layout, flooring, carpets, and landscaping to demonstrate how the property could look when fully furnished or presented. These images are for illustration purposes only and do not represent items included in the sale. If you are travelling from a distance, we recommend arranging a virtual viewing or contacting us prior to your journey to ensure everything is arranged for your visit

Early viewing is highly recommended to fully appreciate the space, character, and location on offer.



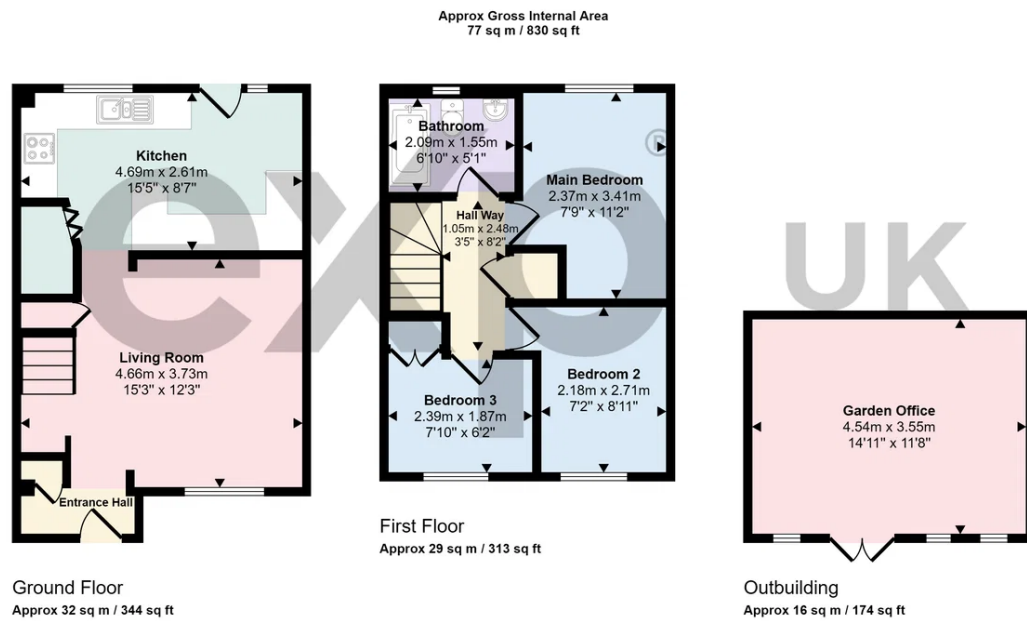

This floorplan is only for illustrative purposes and is not to scale. Measurements of rooms, doors, windows, and any items are approximate and no responsibility is taken for any error, omission or mis-statement. Icons of items such as bathroom suites are representations only and may not look like the real items. Made with Made Snappy 360.



Score	Energy rating	Current	Potential
92+	A		
81-91	B		87 B
69-80	C		
55-68	D	58 D	
39-54	E		
21-38	F		
1-20	G		

Ethan Gaulter
Local Estate Agent
01908 464 950
Ethan.Gaulter@exp.uk.com
<https://ethangaulter.exp.uk.com>

ETHAN GAULTER

