



FELIN NEWYDD

LD3 ONE



FELIN NEWYDD LLANDEFELLE

On the market for only the third time in nearly 200 years, Felin Newydd is a beautifully restored and refurbished country house dating from the 17th century with mid-19th century additions. Extensive renovations have been undertaken by the present owners.



9



7



6



18.25

Local Authority: Powys County Council

Council Tax band: I

Tenure: Freehold



THE PROPERTY

One of the finest country houses in the historic county of Breconshire. Situated mid-way between Hay-on-Wye and Brecon, the house is framed in a glorious setting with grazing land extending to over 18 acres. Approached by private electric gates and a sweeping gravel drive to the front, the grounds have been landscaped, with a large lawn stretching down to a stream and parkland beyond. There is also a walled kitchen garden with a greenhouse and a stable block with three loose boxes, feed room and paddock. There is ample parking for multiple vehicles.

To the side of the house there is a substantial period coach house. Part of this has been converted into a soundproofed music studio/home office but the rest offers good potential for further upgrades.

Felin Newydd is a beautifully balanced country house and a true family home, combining scale with ease of living, all set within gracious and extensive grounds.









SERVICES

The house is not listed or in a conservation area or AONB.

Utilities – Mains electricity and water (unmetered). Private drainage via septic tank and soakaway field. Oil fired boiler (installed February 2023) provides central heating and hot water. The boiler is hydrotreated vegetable oil (HVO) ready.

Flood risk: flooding from surface water and small watercourses - risk less than 0.1% chance each year. Flooding from rivers- risk greater than 3.3% chance each year. There was some flooding to the lawn at the south of the house in 2024. The house and outbuildings have never flooded.

Mobile phone coverage: 4G mobile signal is available in the area - we advise you to check with your provider.

Internet connection: Fast Broadband connection is available. We advise you to check with your provider.







LOCATION

Felin Newydd is sited between Hay-on-Wye and Brecon in spectacular countryside, with the backdrop of Bannau Brycheiniog (Brecon Beacons) and the Black Mountains.

Hay-on-Wye, home to the renowned literary festival, is a vibrant border town abundant in boutiques, local producers, deli and cafes and within easy distance just to the north-east.

Brecon is famous for its Georgian buildings and is just a short drive away with shops, covered markets, cinema, theatre and a Norman Cathedral.

The renowned Felin Fach Griffin Inn is located within 2 miles of the house.

Road connections are good. The A40 provides fast access to the M4 and M50 for Bristol and London, the A470 for Cardiff.

The area is famed for its beauty and recreational opportunities. There are also glorious walks and rides through the surrounding countryside.





DIRECTIONS

Post Code: LD3 0NE

What 3 words: pleasing.outnumber.bypassed

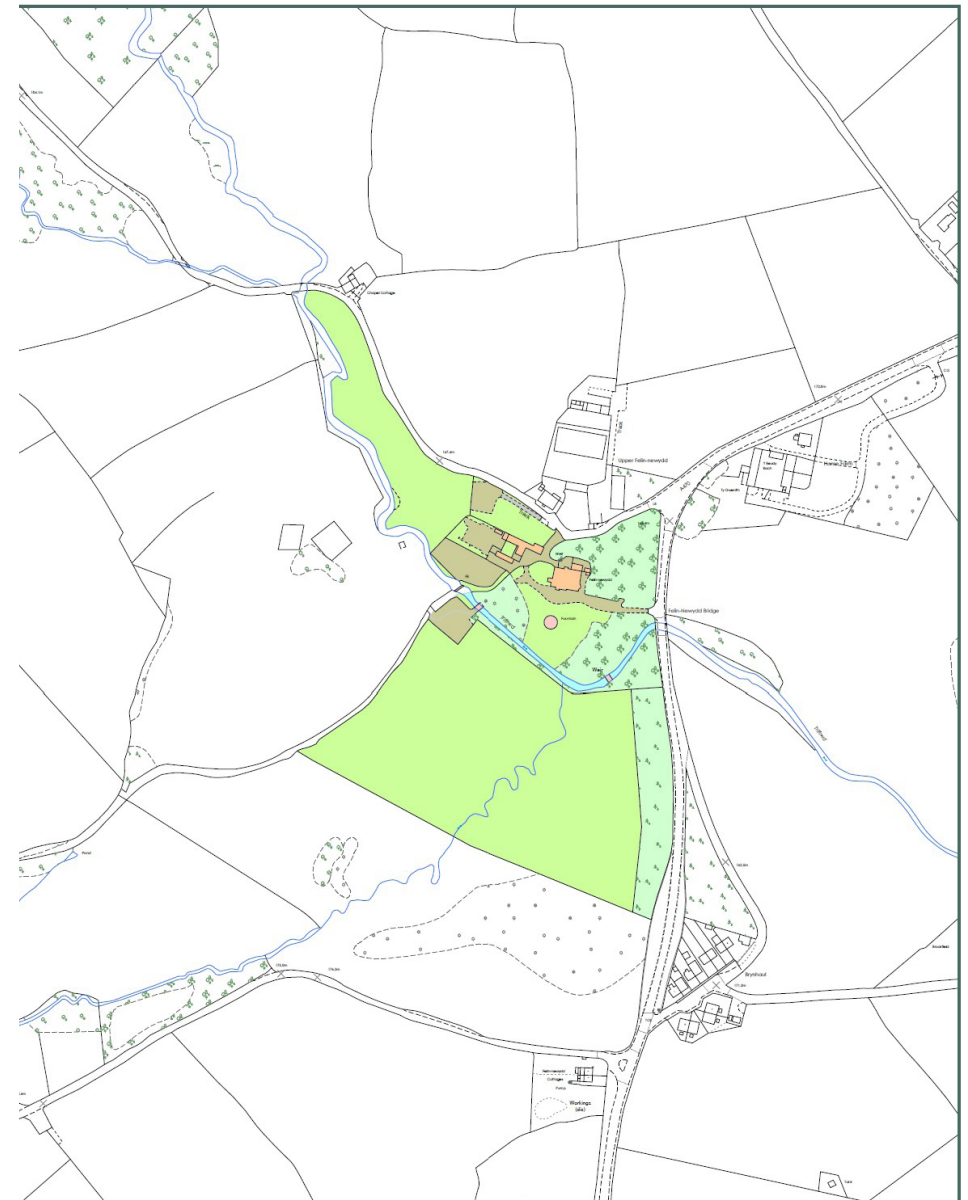

Location: ST 116 359
 Scale: 1:4,000 @ A4
 Drawing No.: ZAA27879-01
 Date: 23.03.26



Total Area
 7.39 hectares
 (18.25 acres)

Based on Ordnance Survey 1:2,500 mapping with the permission of the Controller of HMSO ©Crown Copyright Licence No. VA 100033416

Felin Newydd, Llandefalle,
 Brecon, Powys, LD3 0NE





Felin Newydd, Llandefalle, Brecon LD3 0NE

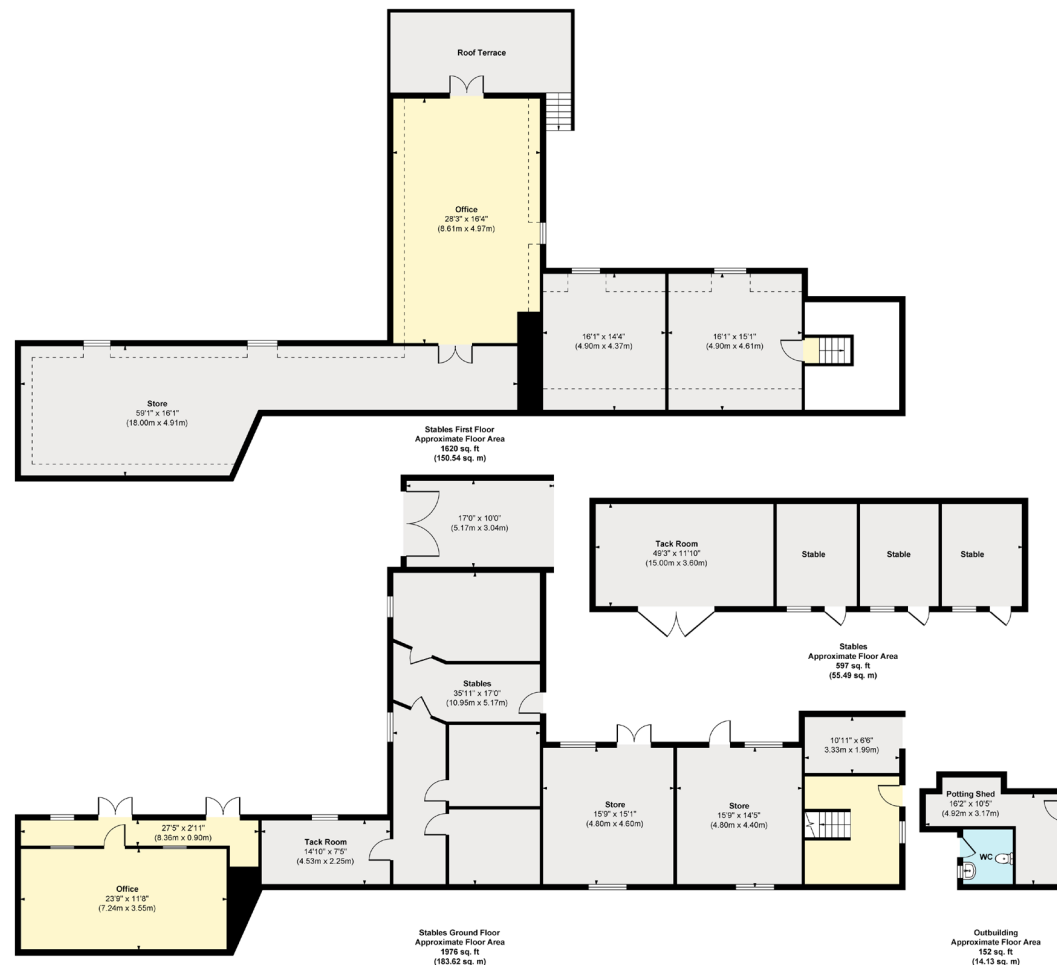

Approx. Gross Internal Floor Area
Stables = 4193 sq. ft / 389.65 sq. m
Outbuilding = 152 sq. ft / 14.13 sq. m

FOR ILLUSTRATIVE PURPOSES ONLY, MEASUREMENTS ARE APPROXIMATE - NOT TO SCALE
 The position & size of doors, windows, appliances and other features are approximate only.
 ©William Benton-Fife Photographer. Unauthorised reproduction prohibited.



We would be delighted
to tell you more.

Charles Probert

07957 333495

charles.probert@knightfrank.com

Knight Frank

Kingsway House, 40 Forgate Street

Worcester WR1 1EE

[knightfrank.co.uk](https://www.knightfrank.co.uk)

Your partners in property

1. Particulars: These particulars are not an offer or contract, nor part of one. You should not rely on statements given by KF West Midlands Ltd., in the particulars, by word of mouth or in writing ("information") as being factually accurate about the property, its condition or its value. Neither KF West Midlands Ltd, nor any joint agent has any authority to make any representations about the property, and accordingly any information given is entirely without responsibility on the part of KF West Midlands Ltd. 2. Material Information: Please note that the material information is provided to KF West Midlands Ltd, by third parties and is provided here as a guide only. While KF West Midlands Ltd, has taken steps to verify this information, we advise you to confirm the details of any such material information prior to any offer being submitted. If we are informed of changes to this information by the seller or another third party, we will use reasonable endeavours to update this as soon as practical. 3. Photos, Videos etc: The photographs, property videos and virtual viewings etc. show only certain parts of the property as they appeared at the time they were taken. Areas, measurements and distances given are approximate only. 4. Regulations etc: Any reference to alterations to, or use of, any part of the property does not mean that any necessary planning, building regulations or other consent has been obtained. A buyer must find out by inspection or in other ways that these matters have been properly dealt with and that all information is correct. 5. Fixtures and fittings: A list of the fitted carpets, curtains, light fittings and other items fixed to the property which are included in the sale (or may be available by separate negotiation) will be provided by the Seller's Solicitors. 6. VAT: The VAT position relating to the property may change without notice. 7. To find out how we process Personal Data, please refer to our Group Privacy Statement and other notices at <https://www.knightfrank.com/legals/privacy-statement>.

Particulars dated March 2026. Photographs and videos dated March 2026. All information is correct at the time of going to print. KF West Midlands Limited, a company registered in England and Wales with registered number 13144773. Our registered office is at 9 College Hill, Shrewsbury, Shropshire, SY1 1LZ. KF West Midlands Limited is an independently owned member of the Knight Frank Network operating under licence from Knight Frank LLP