



39 Fivash Close Taunton TA1 4YF

£199,950

robert
cooney



39 Fivash Close, Taunton, TA1 4YF

Approximate Area = 594 sq ft / 55.1 sq m
For identification only - Not to scale

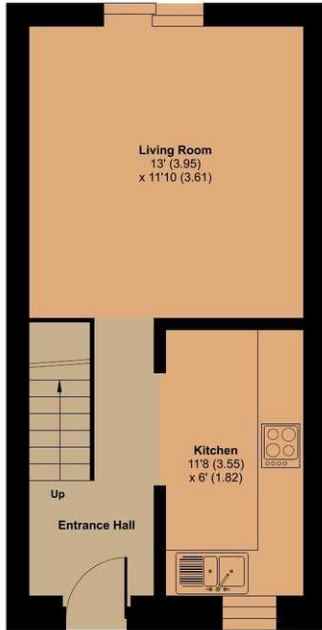

GROUND FLOOR

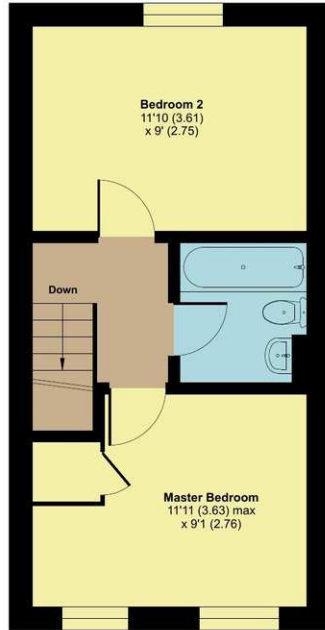

FIRST FLOOR



Features

- Entrance Hall
- Living Room with door to garden
- Fitted Kitchen
- Master Bedroom with fitted wardrobe
- Further double Bedroom
- Bathroom
- Enclosed South-facing low maintenance garden to rear
- Separate Garage and off road parking
- Gas central heating
- Double glazing
- Council tax band B
- What3words: [///hike.straw.rinse](https://www.what3words.com/#!/en/@@@hike.straw.rinse)

Floor plan produced in accordance with RICS Property Measurement 2nd Edition, Incorporating International Property Measurement Standards (IPMS2 Residential). © nitchcom 2026. Produced for Robert Cooney. REF: 1467583

A well presented 2 double bedroomed mid-terraced house located in a quiet cul de sac location within The Castle School catchment and close to Musgrove Park Hospital, local amenities and regular bus service with enclosed South-facing low maintenance garden to rear, separate garage and off road parking. No onward chain.



Viewing strictly through the selling agents:

Robert Cooney

Corporation Street, Taunton, Somerset TA1 4AW

Telephone: 01823 230230
taunton@robertcooney.co.uk
robertcooney.co.uk

**robert
cooney**

For clarification, we wish to inform prospective purchasers that: these particulars are set out as a general outline only for the guidance of intended purchasers, and do not constitute, nor constitute part of, an offer or contract; all descriptions, dimensions, references to condition and necessary permission for use and occupation, and other details, are given without responsibility and any intending purchasers should not rely on them as statements or representation of fact, but must satisfy themselves by inspection or otherwise as to the correctness of each of them; no person in the employment of Robert Cooney has any authority to make or give any representation or warranty whatever in relation to this property; we have not carried out a detailed survey nor tested the services, appliances and specific fittings.