



GREENHILL



Flat 10 Kinsman Mews Gascoyne Way
, Hertford, SG13 8EW

Guide price £525,000

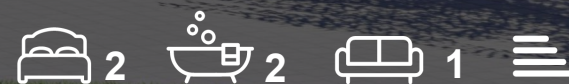

Flat 10 Kinsman Mews Gascoyne Way, Hertford, SG13 8EW

STAMP DUTY & LEGAL FEES PAID subject to t&c's

Greenhill Estates are delighted to bring to market this brand new, first floor split level apartment located just at the edge of Hertford town centre within a small gated development of just 9 properties. This stunning conversion seamlessly blends authentic industrial loft-style aesthetics with modern luxury, offering a truly unique living space that is both sophisticated and modern. Boasting impressive ceiling heights and expansive proportions throughout, this home offers approximately 858 sq ft of internal space designed for those who appreciate high-end finishes and architectural character.

The heart of the home is a magnificent, open-plan lounge, kitchen, and dining area. This vast space is perfect for entertaining and features beautiful oak herringbone flooring that runs throughout the principal living areas. The kitchen is finished to an exceptional standard, reflecting the luxury industrial theme found across the entire development. Adding to the property's versatility is a mezzanine level overlooking the main living area; a perfect "hidden gem" that could be utilised as a dedicated home office, a cozy snug, or even an occasional guest bedroom. The sleeping quarters consist of two generous double bedrooms and two high-specification bathrooms.

Externally, the property benefits from an allocated parking space equipped with an EV charger. As the development is situated on a private road, residents also enjoy the added benefit of ample unrestricted street parking. Peace of mind is guaranteed with a 10-year structural warranty, a 999-year lease with no ground rent, and notably low service charges



Kinsman Mews Location

Living in Hertford

Buyers Note

Area Map



Floor Plan

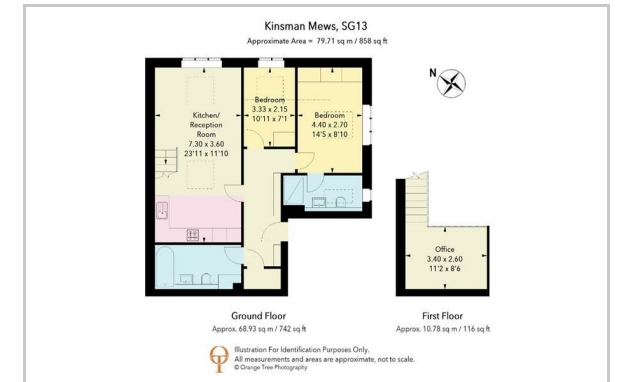

Energy Efficiency Graph

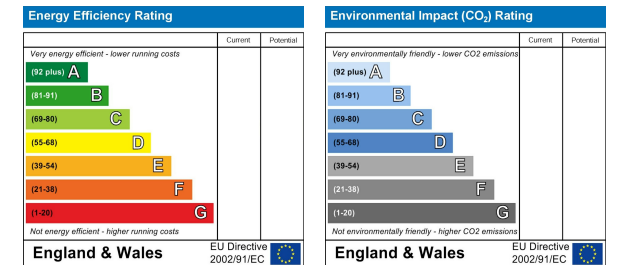

These particulars, whilst believed to be accurate are set out as a general outline only for guidance and do not constitute any part of an offer or contract. Intending purchasers should not rely on them as statements of representation of fact, but must satisfy themselves by inspection or otherwise as to their accuracy. No person in this firm's employment has the authority to make or give any representation or warranty in respect of the property.

Sopers House Sopers Road, Cuffley, EN6 4RY

Tel: 01707 802001 Email: sales@greenhillestates.co.uk <https://www.greenhillestates.co.uk>