



Provident Street

Chester Le Street DH2 1NS

£70,000





This footer paragraph is an example only and should not be relied upon as complying with current legislation. These particulars, whilst believed to be accurate are set out as a general outline only for guidance and do not constitute any part of an offer or contract. Intending purchasers should not rely on them as statements of representation of fact, but must satisfy themselves by inspection or otherwise as to their accuracy. No person in this firm's employment has the authority to make or give any representation or warranty in respect of the property.

Provident Street

Chester Le Street DH2 1NS



Situated in the hamlet of Pelton Lane Ends, this deceptively spacious two-bedroom mid-terraced house on Provident Street presents an excellent opportunity for both first-time buyers and investors alike. The property is conveniently located near Pelton village, providing easy access to a variety of shops and local amenities, as well as excellent transport links via the A693 and A1M, making it ideal for commuting.

Upon entering, you are welcomed into an open-plan lounge that features a delightful spindled staircase, creating a warm and inviting atmosphere. The fitted Maple effect kitchen is equipped with cooker, perfect for those who enjoy cooking. The ground floor also boasts a practical rear lobby and a white bathroom complete with a WC and shower, ensuring convenience for everyday living.

The first floor comprises two generously sized double bedrooms, offering ample space for relaxation and rest. The property benefits from UPVC double glazing throughout, ensuring warmth and energy efficiency, alongside gas central heating for those cooler months.

Additionally, there is off-road parking available to the rear for one vehicle, providing added convenience.

This property is offered with immediate vacant possession, allowing you to move in without delay.

Do not miss the chance to view this lovely home; please call 0191 3729898 to arrange a viewing today.

Lounge

15'6" x 14'10" (4.72m x 4.52m)

Kitchen

14'2" x 6'7" (4.32m x 2.01m)

Rear lobby

Bathroom

Bedroom 1

15'4" x 12'4" (plus robes) (4.67m x 3.76m (plus robes))

Bedroom 2

14'2" x 8'6" (4.32m x 2.59m)

Rear yard

Holding Deposit/Deposit

Holding Deposit And Deposit - All of our rental properties require a Holding Deposit equivalent to 1 week's rent. The Tenant is entitled for this Holding

Deposit to be repaid within 15 calendar days of their application proceeding. However, in most cases we hope to repay this to the Tenant on the day you move in and this will be deducted from your first month's rent. This will need to be agreed with the Tenant during the application process.

You will lose your Holding Deposit if any of the following occurs:

- 1.You give us false or misleading information. For example, incorrect salary/income details or you fail to tell us about a CCJ.
- 2.You fail a Right to Rent check and are not eligible to reside in the UK.
- 3.You withdraw your application.
- 4.You drag your feet during the application process.

All of our rental properties will require a deposit, payable on the day you move in, equivalent to 5 weeks' rent.

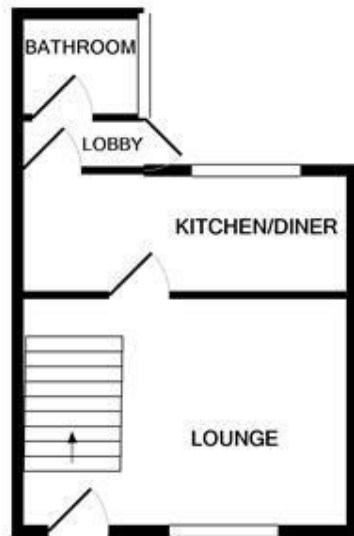

GROUND FLOOR

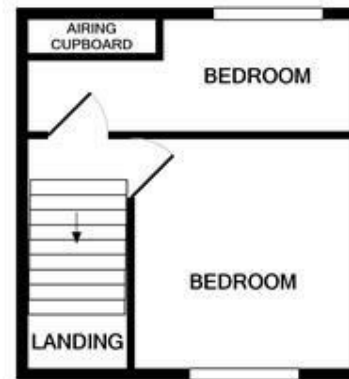

1ST FLOOR

Whilst every attempt has been made to ensure the accuracy of the floor plan contained here, measurements of doors, windows, rooms and any other items are approximate and no responsibility is taken for any error, omission, or mis-statement. This plan is for illustrative purposes only and should be used as such by any prospective purchaser. The services, systems and appliances shown have not been tested and no guarantee as to their operability or efficiency can be given.
 Made with Metropix ©2020



Property Information

0191 372 9898

Suite 6, 15 North Burns, Chester-le-Street, County Durham, DH3 3TF
sales.cls@venturepropertiesuk.com