



# SOUL ESTATES

## SALES & LETTINGS

### TO LET - 3 Bedroom House

**Broadmeadow Close, Willenhall, WV12**

**£1,150 PCM**

Soul Estates are proud to present this well-presented 3-bedroom semi-detached house To Let. This perfect family home is situated in a very popular area of Willenhall. Situated close to all local amenities & public transport with good schools.

The property offers an entrance porchway leading into a spacious lounge, family kitchen and large conservatory to the side. Kitchen with a range of wall and base units to match, splashback tiling, gas hob with an electric oven.

Stairs leading to the first-floor landing, which leads off to three bedrooms and a family bathroom with a separate WC. The property also benefits from gas central heating and double glazing, a large rear garden with off-road parking to the front

✓ **3 BEDROOM SEMI-DETACHED HOUSE**

✓ **CONSERVATORY**

✓ **SPACIOUS LOUNGE**

✓ **LARGE REAR GARDEN**









# SOUL ESTATES

## SALES & LETTINGS

### TO LET - 3 Bedroom House

#### Broadmeadow Close, Willenhall, WV12

#### Ground Floor

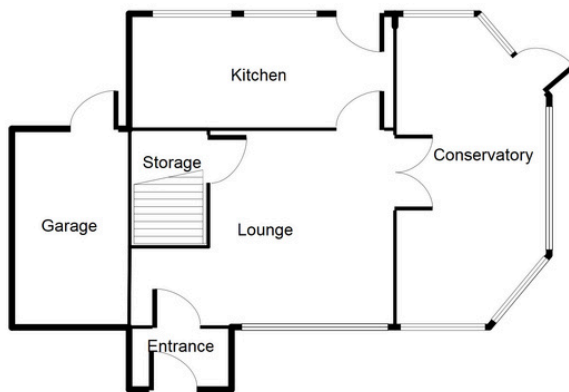

This floorplan is just an example, this is not to scale.  
Please see description for exact room sizes.  
(c) Soul Estates

#### First Floor

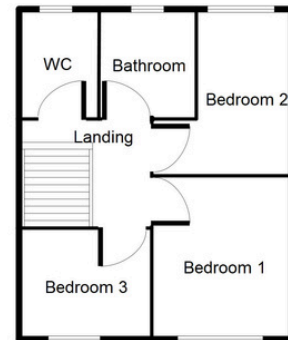

This floorplan is just an example, this is not to scale.  
Please see description for exact room sizes.  
(c) Soul Estates

#### Entrance Porch

3' 1" x 4' 10" (0.94m x 1.47m)

#### Lounge

16' 7" x 14' 4" (5.05m x 4.37m)

#### Kitchen

8' 1" x 14' 4" (2.46m x 4.37m)

#### Conservatory

22' 11" x 12' 7" (6.98m x 3.83m)

#### First Floor Landing

9' 3" x 5' 8" (2.82m x 1.73m)

#### Bedroom 1

12' 8" x 8' 5" (3.86m x 2.56m)

#### Bedroom 2

11' 1" x 6' 4" (3.38m x 1.93m)

#### Bedroom 3

9' 7" x 5' 8" (2.92m x 1.73m)

#### Bathroom

5' 6" x 4' 10" (1.68m x 1.47m)

#### WC

5' 6" x 2' 9" (1.68m x 0.84m)



### CONTACT US

Soul Estates  
20 Great Bridge  
Tipton  
DY4 7HA

0121 647 6779

[www.soulestates.co.uk](http://www.soulestates.co.uk)

WWW.SOULESTATES.CO.UK | 0121 647 6779