



WHITEHORNES

Buy. Sell. Let. Relax!

0114 268 8533
info@whitehornes.com
www.whitehornes.com

9 Mylor Road, High Storrs

Sheffield

Guide Price £475,000



9 Mylor Road

High Storrs, Sheffield

This beautiful three bedroom, bay windowed semi-detached family home offers one of the largest layouts of its kind in the area, with two fabulous floors of accommodation totalling an impressive 1,088 square feet. The property is brimming with original period features, character and charm, which are synonymous with homes from this era and blends them with a modern vibe. Set within the heart of the ultra-popular High Storrs area towards the south west of the city, this residence is ideally positioned for those seeking excellent Ofsted-rated schooling catchments, including Ecclesall Juniors and High Storrs Secondary. The layout is perfectly suited to the growing family market, with spacious and well-proportioned rooms throughout. There is also significant potential for extension to the side, rear and loft (subject to the necessary planning permissions), as demonstrated by neighbouring properties.

Council Tax band: C Tenure: Leasehold

- BEAUTIFUL THREE BEDROOM BAY WINDOWED SEMI-DETACHED FAMILY HOME
- OFFERING ONE OF THE LARGEST STYLES OF THIS STYLE OF SEMI-DETACHED
- TWO FABULOUS FLOORS OF ACCOMMODATION TOTALLING AN IMPRESSIVE 1,088 SQ FEET
- PLENTY OF BEAUTIFUL ORIGINAL PERIOD FEATURES CHARACTER AND CHARM ASSOCIATED WITH A PROPERTY FROM THIS ERA
- OFSTED RATED EXCELLENT SCHOOLING CATCHMENTS INCLUDING ECCLESALL JUNIORS AND HIGH STORRS SECONDARY
- HUGE OPPORTUNITY FOR EXTENSION TO THE SIDE REAR AND LOFT AS THE NEIGHBOURING PROPERTIES HAVE DONE SUBJECT TO PLANNING





Garage

Approx. 13.5 sq. metres (145.0 sq. feet)



Ground Floor

Approx. 43.8 sq. metres (471.7 sq. feet)

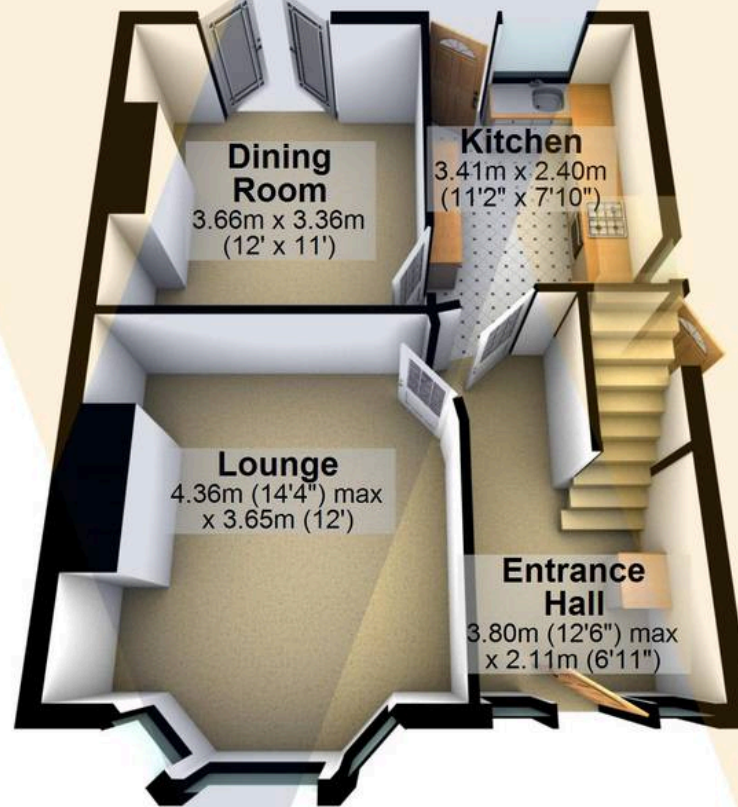

Dining Room

3.66m x 3.36m
(12' x 11')

Kitchen

3.41m x 2.40m
(11'2" x 7'10")

Lounge

4.36m (14'4") max
x 3.65m (12')

Entrance Hall

3.80m (12'6") max
x 2.11m (6'11")

First Floor

Approx. 43.8 sq. metres (471.6 sq. feet)

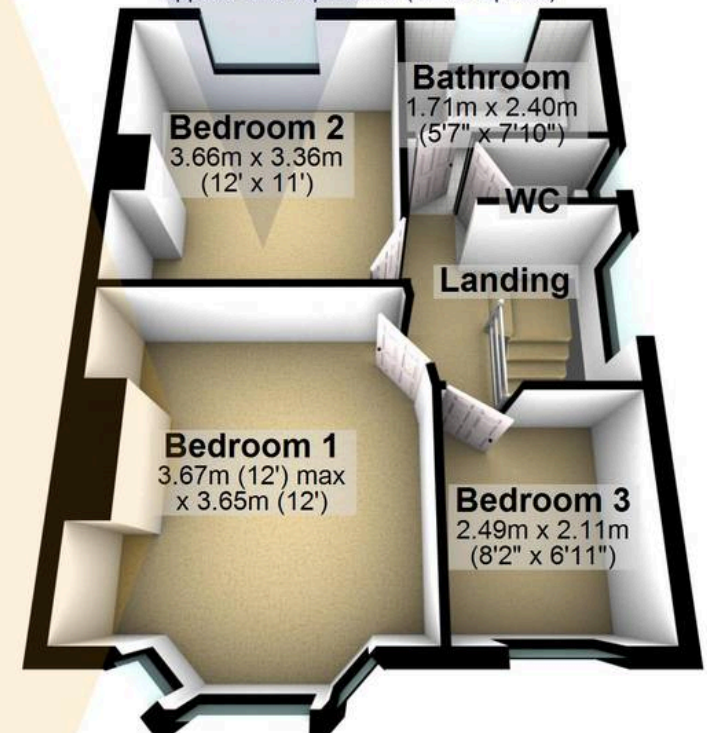

Bedroom 2

3.66m x 3.36m
(12' x 11')

Bathroom

1.71m x 2.40m
(5'7" x 7'10")

WC

Landing

Bedroom 1

3.67m (12') max
x 3.65m (12')

Bedroom 3

2.49m x 2.11m
(8'2" x 6'11")

Total area: approx. 101.1 sq. metres (1088.4 sq. feet)

All measurements are approximate
Plan produced using PlanUp.

9 Mylor Road



WHITEHORNES

Buy. Sell. Let. Relax!

0114 268 8533
info@whitehorns.com
www.whitehorns.com