



CPH ESTATE AGENTS &
CHARTERED SURVEYORS
For over 30 years

16 Knolls Close, Scarborough

Guide Price £315,000



16 Knolls Close

Scarborough, Scarborough

- FOUR BEDROOM, THREE RECEPTION ROOMS, TWO BATHROOMS
- POPULAR OSGODBY VILLAGE LOCATION
- OFF-STREET PARKING & GARAGE
- SOLAR PANELS
- IMMACULATELY PRESENTED THROUGHOUT

Located in the popular village of Osgodby, this immaculately presented property offers a harmonious blend of comfort and style. Boasting four bedrooms, three reception rooms, and two bathrooms, this home exudes a sense of spaciousness and functionality. The presence of solar panels not only enhances sustainability but also reduces energy costs, demonstrating a commitment to modern living.

Situated within the serene Osgodby Village, residents can benefit from the convenience of off-street parking and a garage, ensuring ample space for vehicles and storage. The low maintenance front, rear, and side gardens provide a tranquil outdoor space without the hassle of extensive upkeep, ideal for relaxing and entertaining.

Each room within this abode is thoughtfully designed, creating a welcoming ambience for residents and guests alike. Whether lounging in the living room or preparing meals in the kitchen, every corner exudes warmth and comfort. With its prime location and array of features, this property presents a rare opportunity to embrace a lifestyle of ease and sophistication in the heart of Osgodby.





ACCOMMODATION

GROUND FLOOR

Living Room

20' 0" x 10' 6" (6.10m x 3.20m)

Sun Room

13' 9" x 5' 11" (4.20m x 1.80m)

Kitchen

17' 1" x 10' 6" (5.20m x 3.20m)

Bathroom

5' 7" x 7' 3" (1.70m x 2.20m)

Dining Room

12' 2" x 13' 9" (3.70m x 4.20m)

Bedroom 1

10' 10" x 13' 9" (3.30m x 4.20m)

Bedroom 4

9' 6" x 7' 3" (2.90m x 2.20m)

FIRST FLOOR

Bedroom 2

10' 6" x 14' 5" (3.20m x 4.40m)

Bedroom 3

8' 10" x 14' 5" (2.70m x 4.40m)

Shower Room

9' 2" x 7' 3" (2.80m x 2.20m)



GROUND FLOOR
905 sq.ft. (84.1 sq.m.) approx.



1ST FLOOR
438 sq.ft. (40.7 sq.m.) approx.

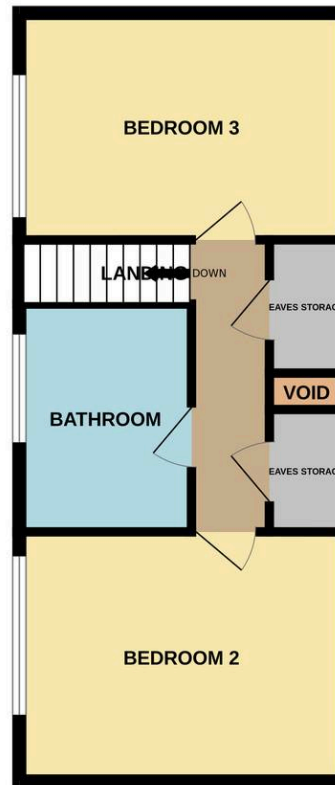

TOTAL FLOOR AREA: 1343 sq.ft. (124.8 sq.m.) approx.

Whilst every attempt has been made to ensure the accuracy of the floorplan contained here, measurements of doors, windows, rooms and any other items are approximate and no responsibility is taken for any error, omission or mis-statement. This plan is for illustrative purposes only and should be used as such by any prospective purchaser. The services, systems and appliances shown have not been tested and no guarantee as to their operability or efficiency can be given.
Made with Metropix ©2025

Interested?

Contact our friendly team today
☎ 01723 352235 | ✉ sales@cphproperty.co.uk

With you every step of the way



Sales, Lettings & Commercial
ESTATE AGENTS & CHARTERED SURVEYORS
19 St. Thomas Street, Scarborough YO11 1DY



rightmove Zoopla.co.uk PrimeLocation.com

NOTE: These particulars are intended only as a guide to prospective Purchasers to enable them to decide whether to make further enquiries with a view to taking up negotiations but they are otherwise not intended to be relied upon in any way for any purpose whatsoever and accordingly neither their accuracy nor the continued availability of the property is in any way guaranteed and they are furnished on the express understanding that neither the Agents nor the Vendors are to be or become under any liability or claim in respect of their contents. Any prospective Purchaser must satisfy himself by inspection or otherwise as to the correctness of the particulars contained. C132