



 Steven Oates

Westmill, Buntingford
£2,200 pcm

Village Hall Cottage is a charming period home located in the heart of Westmill, a sought-after Hertfordshire village. The property offers a blend of character features with practical living space, set within a quiet residential setting close to open countryside.

Internally, the cottage provides well-proportioned accommodation with a traditional layout, retaining original features while offering scope for modernisation. Outside, there is a private garden space suitable for everyday use and entertaining.

Westmill offers a peaceful village lifestyle while remaining accessible to nearby Buntingford and main road links for commuting.







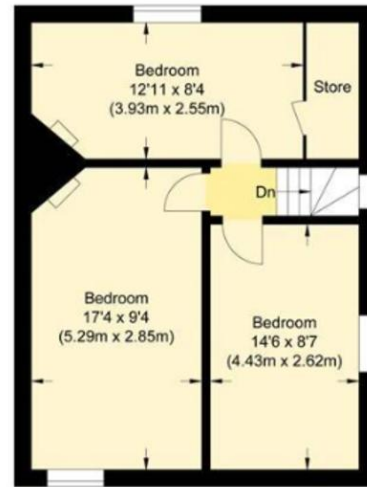

Score	Energy rating	Current	Potential
92+	A		
81-91	B		
69-80	C		75 C
55-68	D		
39-54	E	42 E	
21-38	F		
1-20	G		





Whilst we endeavour to make our sales particulars fair, accurate and reliable, they are only intended as a general guide to the property. Measurements and distances are approximate. These particulars do not form part of any offer or contract. If there are important matters that are likely to affect your decision to buy, please contact us before viewing the property. Please note that we have not tested the services, equipment or appliances in this property, accordingly, we advise prospective buyers to commission their own survey or service reports before finalising any offer to purchase.