



Kings Drive, Midhurst, GU29 0EY

Offers in the Region of **£425,000**



Bedrooms: 2

Bathrooms: 2

Receptions: 1

Top-Floor Apartment with Panoramic South Downs Views – See Property Tour Vid

Nestled in a prime top-floor position within the prestigious King Edward VII Estate, this light-filled two-bedroom apartment offers dual-aspect living with characterful lead-light windows and panoramic views over listed gardens and the South Downs. The open-plan kitchen, dining, and living space features a high-spec kitchen with quartz worktops and premium Siemens appliances, while French doors frame tranquil garden vistas. The principal suite includes a luxurious en-suite, with a stylish separate bathroom for the second bedroom. Residents enjoy secure underground parking, proximity to the swimming pool, steam room, gym, and access to 165 acres of landscaped gardens and woodland. The estate, opened in 1906 and restored in 2015, retains Edwardian charm, historic architecture, and a concierge service. Conveniently located near Midhurst and Haslemere, with London Waterloo under an hour away, and close to Cowdray Park, Goodwood, and Chichester Harbour — offering a rare combination of elegance, history, and South Downs lifestyle.

Quote AM0249 for viewing enquiries

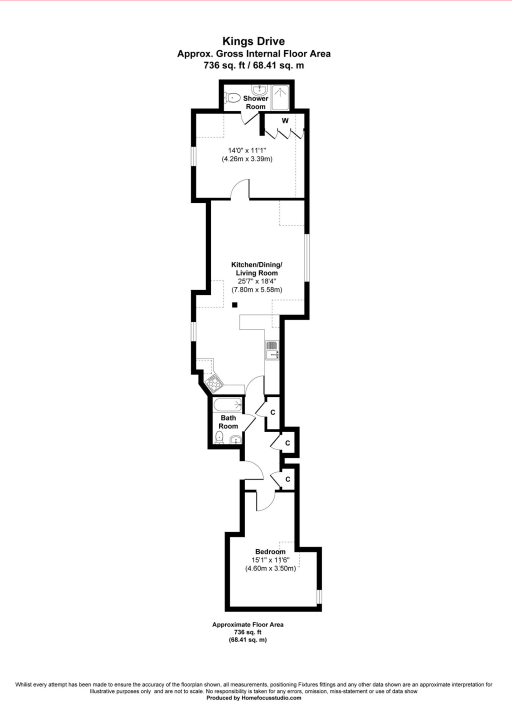



Bedrooms: 2

Bathrooms: 2

Receptions: 1