

Cromwells



Fir Tree Grove, Carshalton, Surrey, SM5 4NG
Guide Price £775,000

A beautifully presented and extended to rear and loft now creating a spacious 4 Bedroom, 2 Bathroom, Semi Detached Chalet/ Bungalow, located within reach of Carshalton Beches & Carshalton Mainline BR stations with excellent services into London. Local shops and the open spaces of Oaks Park are also close by with the added benefit of being within an excellent school catchment area.



- *21'4 Kitchen/Dining Room & Utility Room**
 - *23' Living Room**
 - *4 Good Size Bedrooms & 2 Bathrooms**
 - *Garage to rear**
-

Entrance Hall

Storage cupboard, doors to:

Living Room - 23' 0" x 12' 0" (7.01m x 3.65m)

Storage cupboards, open through to Kitchen/Dining Room

Kitchen/Dining Room - 11' 6" x 21' 4" (3.50m x 6.50m)

Open Plan, leading through form living room. Folding doors out to garden, door to utility room.

Utility Room

Ground Floor Shower Room

Side aspect

Bedroom 1 - 13' 9" x 12' 0" (4.19m x 3.65m)

Front aspect, fitted wardrobe cupboards

Bedroom 2 - 14' 7" x 9' 0" (4.44m x 2.74m)

Front aspect, bay window



Stairs to First Floor Landing

Doors to:

Master Bedroom - 13' 9" x 12' 0" (4.19m x 3.65m)

Rear aspect, fitted wardrobe cupboards, door to en-suite bathroom

En-Suite Bathroom

Leading from master bedroom

Bedroom 4 - 8' 2" x 11' 4" (2.49m x 3.50m)

Fitted wardrobe cupboards, access to large eaves storage area

Outside

Easily Maintained Landscaped Rear Garden

Door to garage at rear

Garage to rear

Access also from rear garden

Paved Front Garden

Side access to rear garden



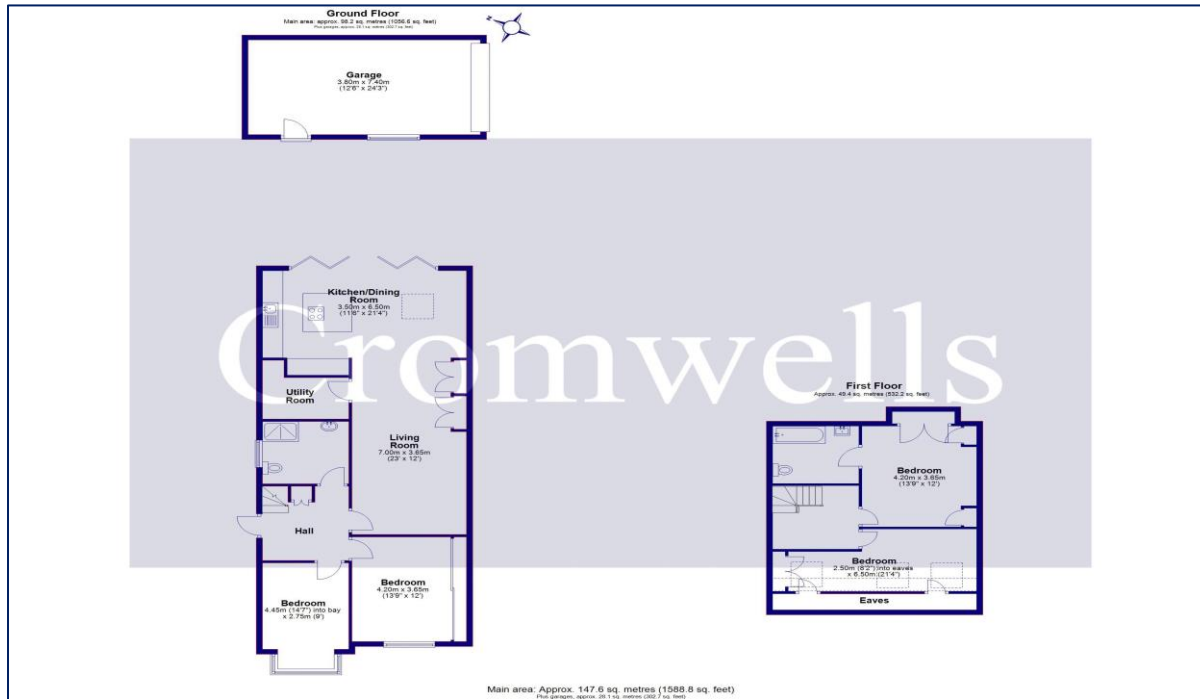

Score	Energy rating	Current	Potential
92+	A		
81-91	B		85 B
69-80	C	75 C	
55-68	D		
39-54	E		
21-38	F		
1-20	G		

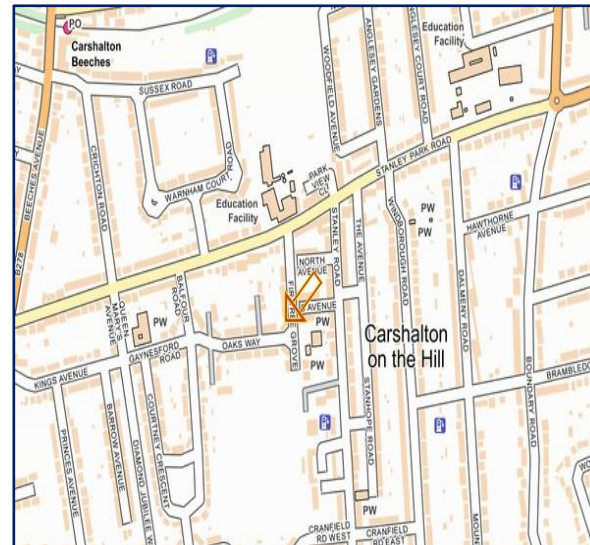

Council Tax - E Local Authority: London Borough of Sutton Tenure - Freehold



**95 Banstead Road
Carshalton
Surrey
SM5 3NP**



020 8642 5468



admin@cromwellscarshalton.com



www.cromwellsestateagents.uk

Disclaimer

These particulars are not an offer or contract, nor part of one. You should not rely on statements made by Cromwells in the particulars or by word of mouth or in writing ("information") as being factually accurate about the property, its condition or value. Neither Cromwells nor any joint agent has authority to make representations about the property, and accordingly any information given is entirely without responsibility on the part of the agents, seller(s) or lessor(s). Photographs show only certain parts of the property as they appeared at the time they were taken. Areas, measurements and distances are given as an approximate only. Any reference to alterations to or use of, any part of the property does not mean that any necessary planning, building regulations or other consents have been obtained