

Key Features

- Character Property in Popular Village Location
- Close to Amenities & Mainline Train Station
- Kitchen Breakfast Room
- Sitting Room with Woodburning Stove
- One Double Bedroom, Plus Loft Room Currently used as a Bedroom
- Garden & Parking
- No Onward Chain

Tenure: Freehold | EPC Rating: F | Council Tax Band: B |

Services: The property is connected to mains electricity, water and drainage. Heating is electric, along with a woodburning stove in the sitting room.

Location

Tisbury is the principal village in Wiltshire's exceptionally popular and highly sought after Nadder Valley. With beautiful rolling countryside considered widely by many as offering the best walking in the south of England. Simply stunning views coupled with amenities to suit every requirement, it's no wonder that The Sunday Times has voted Tisbury in its Top 5 places to live in the UK since 2014.

Just a short walk away; Tisbury's picturesque, welcoming and thriving High Street is awash with high quality independent shops and services that include a butcher, solicitors, a highly regarded deli, hair salons, a hardware shop, florist, post office, as well as excellent cafés, a wine shop, community leisure centre a pharmacist, dentist and doctors' surgeries to name but a few, Tisbury really does have it all. An excellent primary school is present within the village as well as several very well supported community groups.

The village also offers a mainline railway station that provides services both east and west to Exeter St. Davids and central London respectively with Waterloo being only 1 hour 50 mins away approximately as a direct route. With golf at nearby Rushmore, racing at Salisbury and Wincanton and Messums Art Gallery occupying the Tithe Barn within Tisbury itself, the village really does offer something for everyone and brilliant links to other, local activities.

Inside the Home

A charming, end of terrace character property, located in the heart of the village, in a quiet tucked away position, accessible to village amenities and mainline train station.

The accommodation, which has been well cared for and arranged over 3 floors, includes to the ground floor a welcoming entrance hall, kitchen breakfast room, further sitting room with wood burning stove and a downstairs WC. To the first floor there is a double bedroom and a bathroom, with a further loft room on the second floor, currently used as a large double bedroom.

Externally there is a garden, along with a driveway providing off-road parking. The property also benefits from view over the rooftops and countryside beyond.

Outside Space

The property is positioned in a quiet, no through part of Weaveland Road, and benefits from its own private driveway, providing off-road parking.

To the south side of the property is a pretty garden laid to lawn with planted borders, leading around to the rear, where there is a generous patio, providing ample space for the garden furniture.

A rear gate then leads to an outbuilding, currently used for storage, with both electricity and water connected.

Shall We Book You in For a Viewing?

Strictly by appointment only via Boatwrights Estate Agents.

12 High Street, Shaftesbury, Dorset, SP7 8JG | 01747 213106
High Street, Tisbury, Wiltshire, SP3 6LD | 01747 859359
sales@boatwrights.co.uk | www.boatwrights.co.uk

Scan to
read more
on the
property

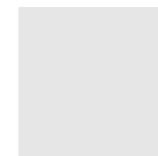

GROUND FLOOR
32.6 sq.m. (351 sq.ft.) approx.

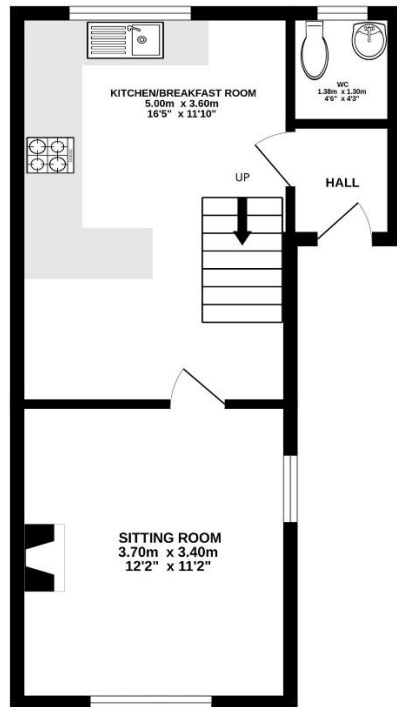

1ST FLOOR
24.7 sq.m. (266 sq.ft.) approx.

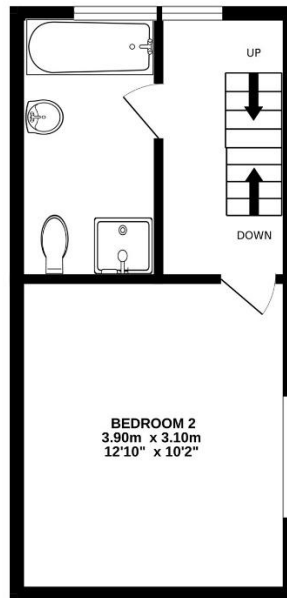

2ND FLOOR
17.0 sq.m. (183 sq.ft.) approx.

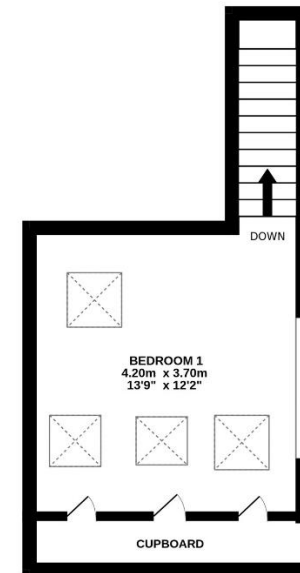

TOTAL FLOOR AREA : 74.3 sq.m. (800 sq.ft.) approx.

Whilst every attempt has been made to ensure the accuracy of the floorplan contained here, measurements of doors, windows, rooms and any other items are approximate and no responsibility is taken for any error, omission or mis-statement. This plan is for illustrative purposes only and should be used as such by any prospective purchaser. The services, systems and appliances shown have not been tested and no guarantee as to their operability or efficiency can be given.
Made with Metropix ©2026



Looking to buy or sell in Tisbury?

At Boatwrights Estate Agents, selling your home starts with trust. As your local, independent experts, we understand the value of your property and your time. Our dedicated team offers tailored marketing, expert guidance, and a personal touch to help you achieve the best possible result.

Scan here to Learn more On Boatwrights?



Important Notice

These particulars do not constitute or form part of an offer or contract, nor may they be regarded as representations. All interested parties must themselves verify their accuracy. All measurements and the proportions of the floor plans provided are approximate.

02 April 2026