



GUY DALY

exp<sup>®</sup> UK

📞 0203 674 1947

📞 07932 603 608

@guy.daly@exp.uk.com

🌐 guydaly.exp.uk.com

# Hampstead Gardens, Temple Fortune, NW11

Guide Price £575,000

🛏 3 🚿 2 🚗 1



This is a three double bedroom maisonette that actually lives like a house.

High ceilings, a beautiful bay window flooding the space with light, and a sizeable separated kitchen, open-plan to the living area.

It's the kind of place where you can cook, entertain, work from home and still have room to breathe.

Three double bedrooms over three floors and two bathrooms.

You're about 10 minutes walk from Golders Green, Northern Line tube station, so getting into town is easy... but honestly, you might not want to leave because just around the corner, you've got Temple Fortune and Golders Green High Street great coffee spots, restaurants, little boutiques and everything you need on your doorstep.

Hampstead Heath and Golders Hill Park are also within walking distance.

So whether you're a first-time buyer stepping onto the ladder, a young couple needing space to grow, or a young family wanting something that feels like home from day one... this one's going to tick a lot of boxes."

Freehold, Guide price £575,000- £600,000

To book your viewing use ref GD4016



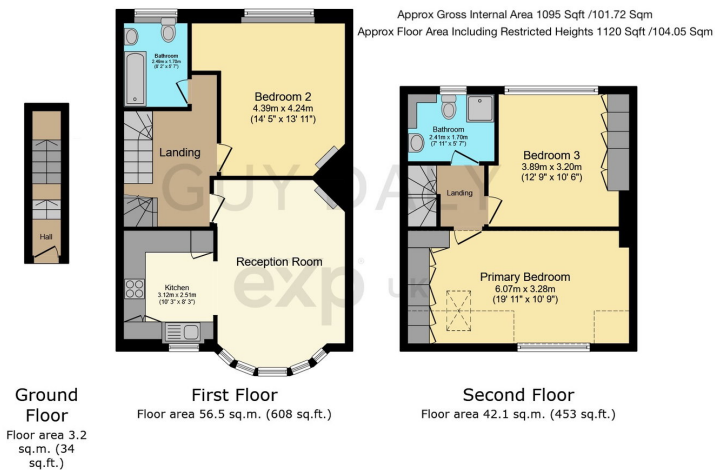

This floor plan is for illustrative purposes only. It is not drawn to scale. Any measurements, floor areas (including any total floor area), openings and orientations are approximate. No details are guaranteed, they cannot be relied upon for any purpose and do not form any part of any agreement. No liability is taken for any error, omission or misstatement. A party must rely upon its own inspection(s). Powered by www.Propertybox.io

- Freehold
- 3 Double Bedrooms
- Large open plan fully fitted contemporary kitchen
- mins walk to Golders Green Tube & Bus Station
- Mins walk to Golders Hill Park & Hampstead Heath
- First and second floor maisonette
- Large Reception with bay window
- Two Bathrooms
- mins walk to Golders Green High Street & Temple Fortune Village
- Guide Price £575,000 - £600,000

