



COUNTRY
HOLMES

Landslow Green Cottage, Mottram

Guide Price £1,000,000

🛏 4 🚿 2 🚗 3



- Magnificent 300-year-old country farmhouse
- Three reception rooms and a farmhouse-style kitchen with utility
- Sympathetically restored to retain original features
- Sun terrace overlooking well-stocked gardens
- Generous driveway
- Beautifully maintained formal gardens/ private woodland area (approx 3 acre plot)
- Featuring exposed beams and fireplaces
- Two stylish bathrooms, luxurious Victorian suite with roll-top bath
- Peaceful semi-rural location
- Close to local amenities & commuter links



Country Holmes proudly presents Landslow Green Cottage, a stunning 300-year-old country farmhouse that beautifully combines historic charm with modern comfort. Set within exquisite formal gardens and a private woodland, this impressive family home offers spacious accommodation including three reception rooms, a farmhouse kitchen with utility, and four characterful bedrooms over two upper floors. Tastefully restored with exposed beams, wood panelling, and feature fireplaces, the property retains its period appeal while providing all the essentials for contemporary living. Located in a peaceful semi-rural setting near Stalybridge, it offers easy access to local amenities and transport links, making it the perfect blend of countryside tranquillity and modern convenience.

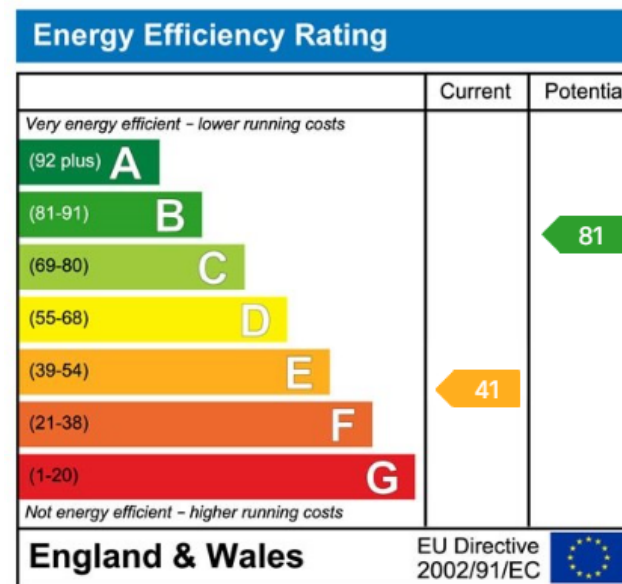
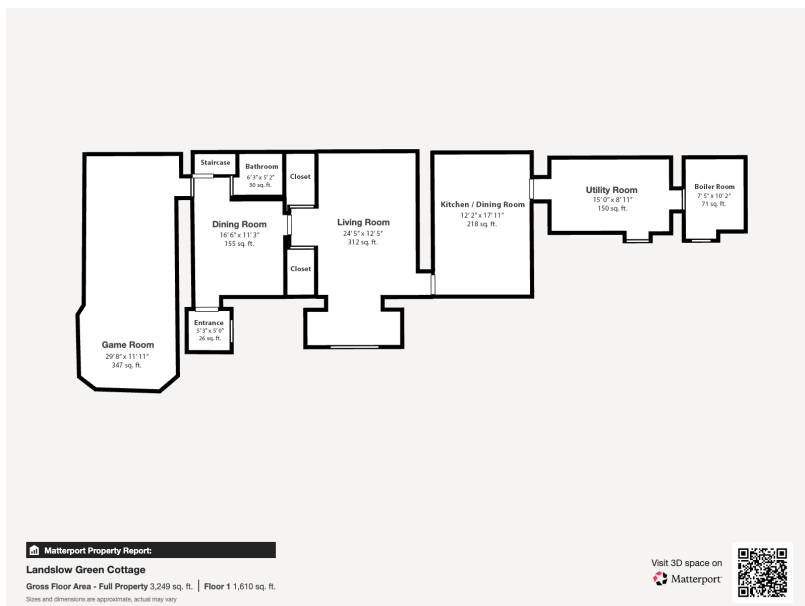

01457 761310 | glossop@countryholmes.co.uk | www.countryholmes.co.uk
 18 High Street West, Glossop, Derbyshire, SK13 8BH