

FLETCHERS

ESTATE AGENTS



Brompton Park Crescent, SW6

£585,000

A modern ground floor flat within the popular Brompton Park Crescent. This is a bright and airy ground floor apartment situated in a well maintained building, on entering the property you benefit from plenty of storage before leading down the hallway into a spacious living room to the right with french doors opening onto the private patio and a separate kitchen. To the left there are two bedrooms with the master boasting built in storage and french doors opening onto the private patio.

This brilliant property is offered to market with a very long lease, allocated parking space and would make for a wonderful home.

The area benefits from excellent transport connections, with West Brompton (District Line) and Earl's Court (District & Piccadilly Lines) stations nearby, as well as numerous bus routes along Lillie Road and Old Brompton Road offering direct links to Central London, Knightsbridge, and the West End.

- Two Double Bedrooms • Ground Floor Flat • Long Lease • Private Patio • Separate Kitchen • Allocated Parking Space •

FLETCHERS

ESTATE AGENTS

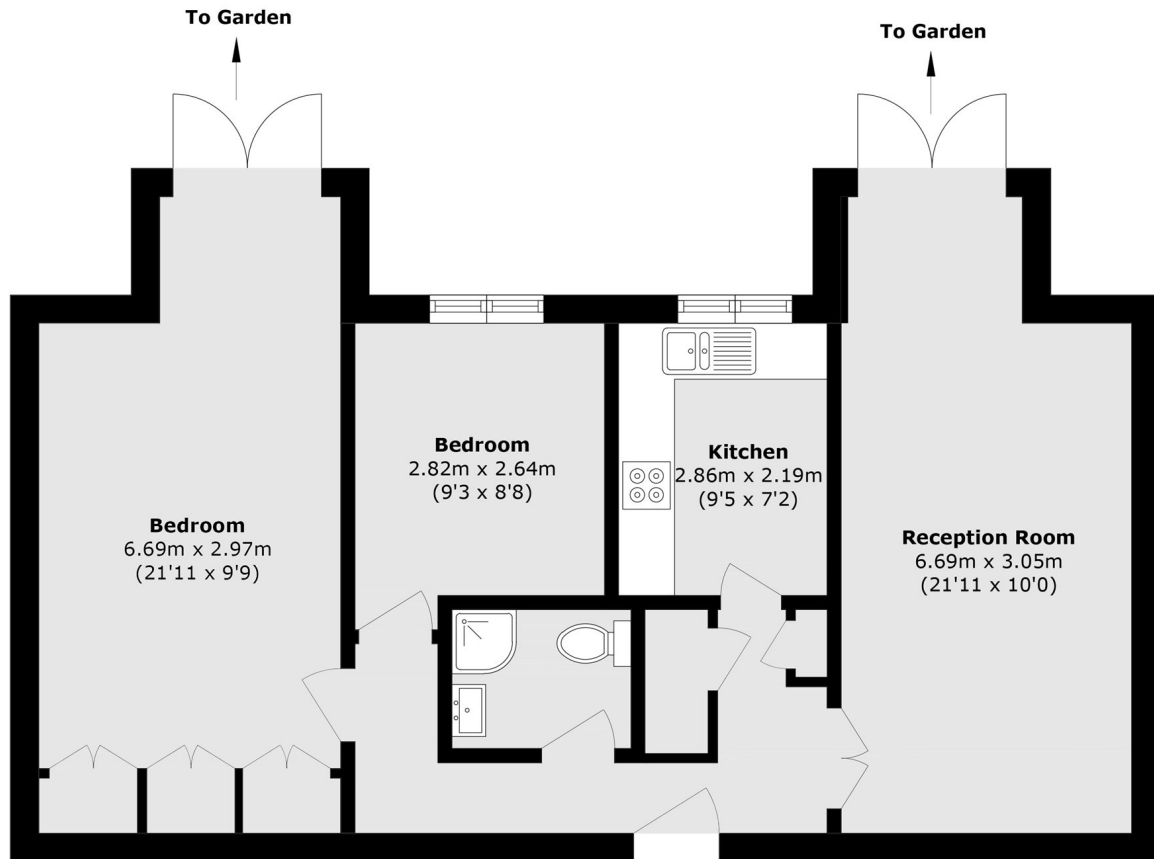

Total area (approx.): 66.5 sq. m (715.8 sq. ft)

Fletchers Brook Green Sales
144 Shepherds Bush Road, Hammersmith, London, W6 7PB
020 7603 1415
brookgreensales@fletcherestates.com

Energy Rating: . We aim to make our particulars both accurate and reliable. However they are not guaranteed; nor do they form part of an offer or contract. If you require clarification on any points then please contact us, especially if you're traveling some distance to view. Please note that appliances and heating systems have not been tested and therefore no warranties can be given as to their good working order.