



Jordan fishwick

57a Broadstone Road, SK5 7AR
Guide Price £895 Per Calendar Month



Broadstone Road Stockport SK5 7AR

£895 Per Calendar Month



The Property

*** AVAILABLE SEPTEMBER *** A beautifully presented one-bedroom furnished apartment located on a highly sought-after road in Stockport. South facing with big windows, make this a bright light. This stylish home offers generous living space and modern finishes throughout, making it ideal for a professional individual or couple. Conveniently positioned within walking distance of a wide range of local amenities, shops, cafés, health clubs, and transport links, the property combines comfort with practicality. Enjoy the 70 acre Highfield Country Park a 10 minute walk away and Reddish train station is a 5 minute walk.

In brief, the accommodation comprises:

- Welcoming entrance hall
- Bright and spacious lounge
- Contemporary separate kitchen with appliances
- Generous double bedroom
- Modern three-piece bathroom suite
- Gas Central heating.
- Kitchen appliances includes washing machine, tumble dryer, fridge freezer, electric oven, gas hob, microwave.
- Gated off-road parking, subject to availability.

Early viewing is highly recommended. To arrange a viewing, please contact our Didsbury office.

EPC Rating - C // Council Tax - A

- Available September
- Separate Lounge and Separate Kitchen
- Furnished
- First Floor Apartment
- Modern Decor Throughout
- Close to all Local Amenities
- Great Location
- Gated Car Parking
- Council Tax Band A
- EPC Rating C



Energy Efficiency Rating		
	Current	Potential
Very energy efficient - lower running costs		
(92 plus) A		
(81-91) B		
(69-80) C	71	77
(55-68) D		
(39-54) E		
(21-38) F		
(1-20) G		
Not energy efficient - higher running costs		
England & Wales	EU Directive 2002/91/EC 	



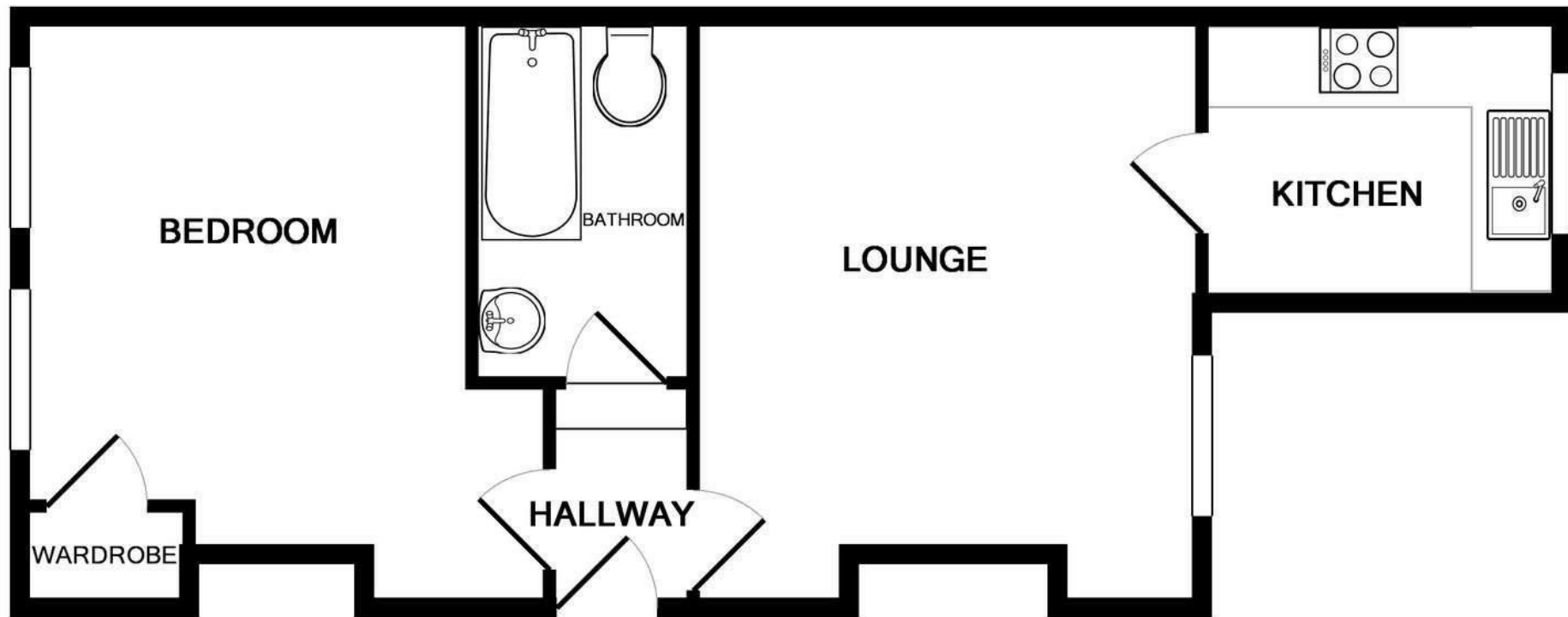

57a Broadstone Road

TOTAL APPROX. FLOOR AREA 470 SQ.FT. (43.7 SQ.M.)

Whilst every attempt has been made to ensure the accuracy of the floor plan contained here, measurements of doors, windows, rooms and any other items are approximate and no responsibility is taken for any error, omission, or mis-statement. This plan is for illustrative purposes only and should be used as such by any prospective purchaser. The services, systems and appliances shown have not been tested and no guarantee as to their operability or efficiency can be given

Made with Metropix ©2016



These particulars are believed to be accurate but they are not guaranteed and do not form a contract. Neither Jordan Fishwick nor the vendor or lessor accept any responsibility in respect of these particulars, which are not intended to be statements or representations of fact and any intending purchaser or lessee must satisfy himself by inspection or otherwise as to the correctness of each of the statements contained in these particulars. Any floorplans on this brochure are for illustrative purposes only and are not necessarily to scale.

Offices at: Chorlton, Didsbury, Disley, Hale, Glossop, Macclesfield, Manchester Deansgate, Manchester Whitworth Street, New Mills, Sale, Wilmslow and Withington